

crane cove park schematic design

DRB + WDAC presentation

July 14, 2014

crane cove park

schematic design

crane cove park schematic design

DRB + WDAC presentation

July 14, 2014

Introduction | D. Beaupre, Port of SF

Schematic Design presentation | P. Fonseca, J. Haig-Streeter, AECOM

Comments | BCDC DRB, WDAC

Public Comments (2 min / person) | Public

Discussion | DRB, WDAC

Next Steps | D. Beaupre, Port of SF

site location

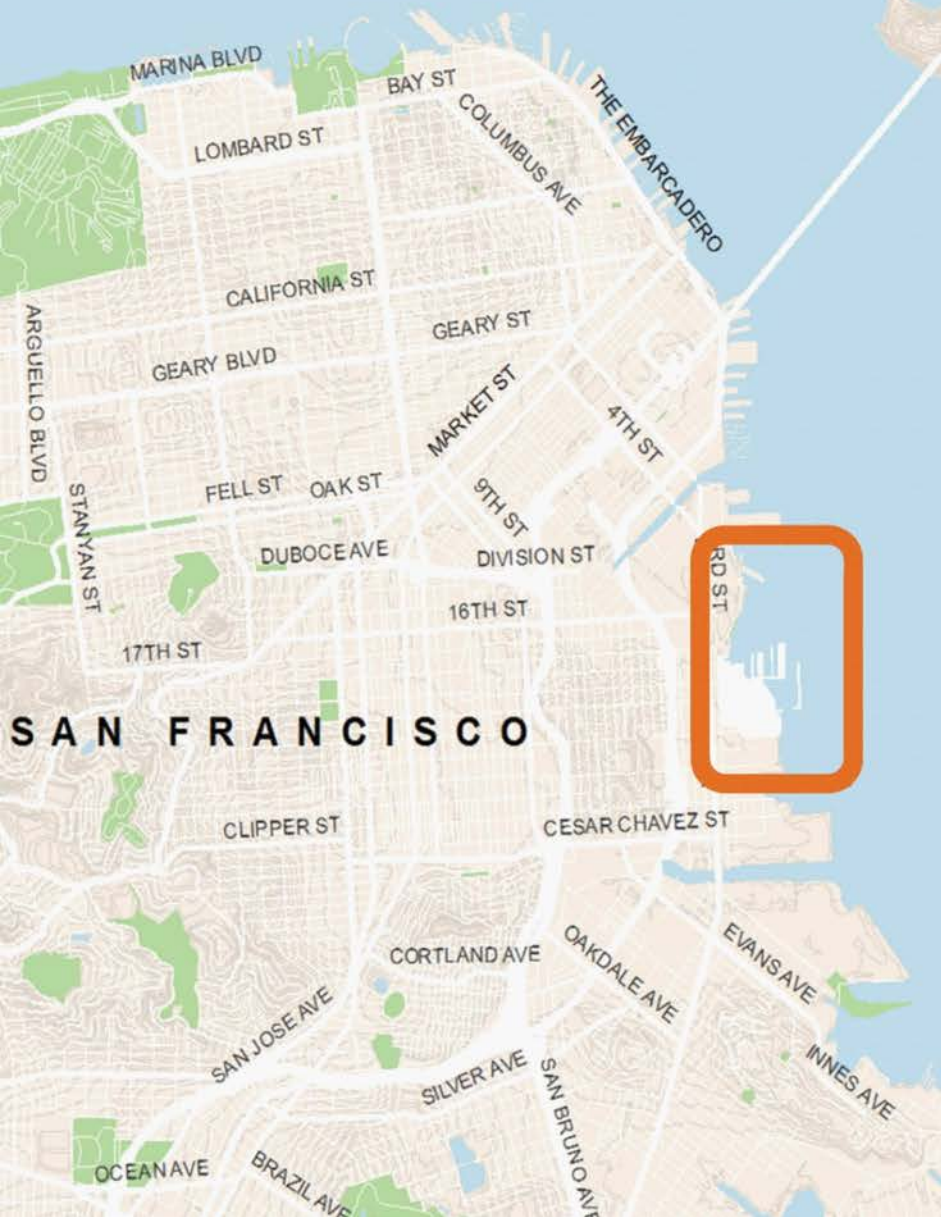

site context (Pier 70 Master Plan)



- crane cove park boundary
- study area boundary
- vehicle access
- pedestrian access
- proposed blue greenway
- proposed bay water trail
- existing blue greenway
- existing light rail
- proposed light rail
- proposed improved bike lane
- shipyard vessel navigation zone
- historic resource
- proposed building removal (pier 70 master plan)
- proposed park/open space
- ship repair zone
- infill development sites (Pier 70 Master Plan)
- safety zone (moves with vessel)
- potential Crane Cove Park gateway /access
- future shipyard truck access
- existing T-line station
- proposed T-line station
- existing bus 22 stop
- proposed ferry terminal (pier 70 master plan)
- potential human powered boat launches (pier 70 master plan)
- ghost piles (former pier 64)



VIEW
mariposa street



the ramp restaurant



VIEW

south of the ramp restaurant





VIEW

from the ramp, towards park



slipway 4

crane 30

crane 14

VIEW
illinois street



kneass building



ILLINOIS ST

VIEW
18th street



VIEW
19th street



schematic design evolution

NOTE:
This site plan reflects
"Crane Plaza" Option 2
presented on May 5th,
2014.

DRB/ WDAC PUBLIC COMMENTS (ON MAY 5TH, 2014 PLAN)

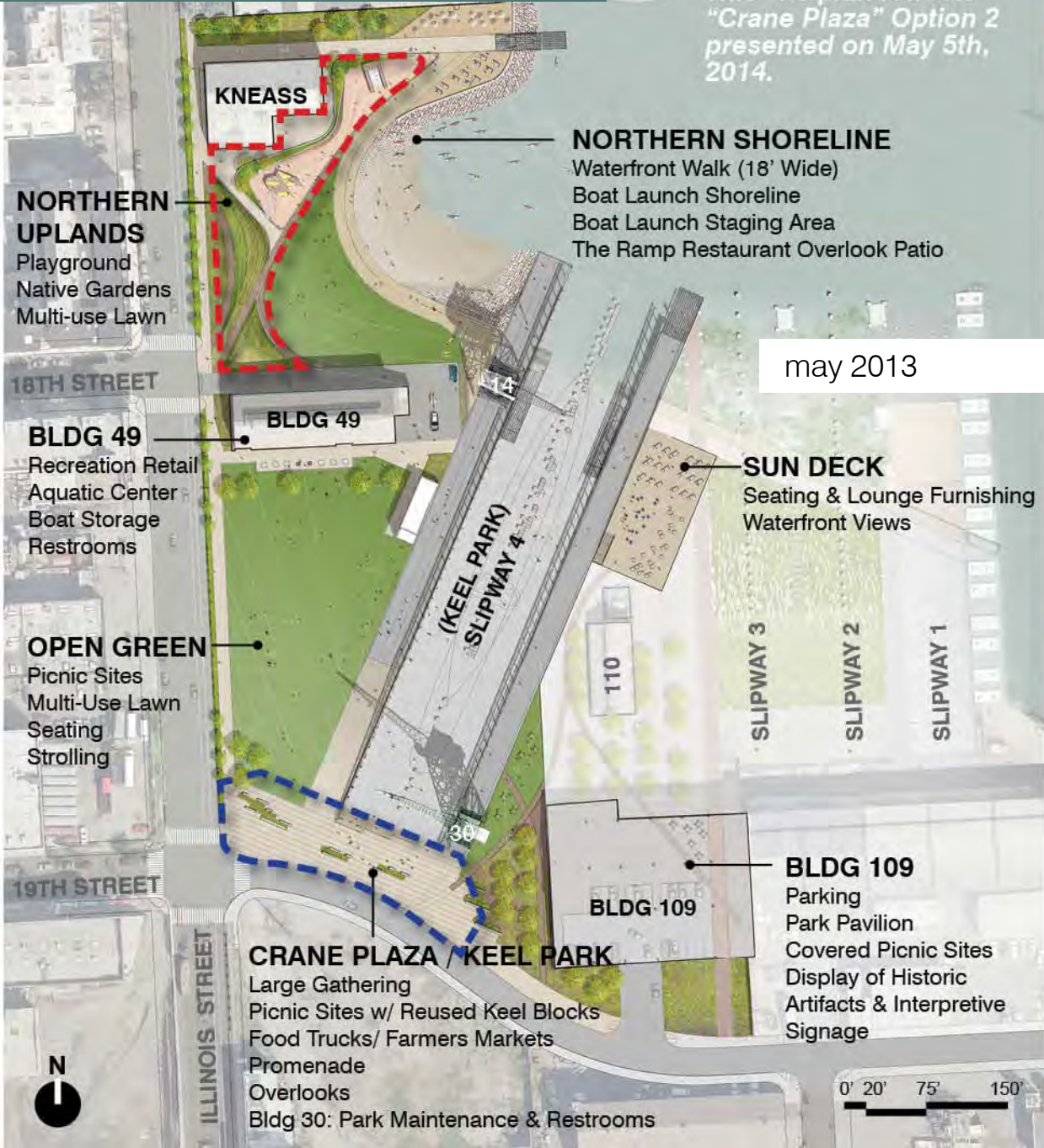

may 2013

■ ■ NORTHERN SHORELINE AREA

1. **Playground** - Expressed concern about how the formal playground could negatively impact the redevelopment of the Kneass Building because of its close proximity and possible view blockage to the launch and Bay. Expressed concern with how the playground may interfere with the promenade circulation, and **requested that other locations and other playground options be explored;**
2. Expressed concern about the **height of the berm** adjacent to Illinois Street blocking views into the site.
3. Expressed concern about the amount of **native garden planting area**

■ ■ SLIPWAY 4 AND 19TH STREET

1. Requested a design be explored that blends the best attributes of both proposals presented: **universal access into the slipway;** and a **plaza space that creates a comfortable pedestrian environment** for appreciating the Slipway and activities within the Slipway, on text of how the existing portion south of 19th street



Crane Plaza Option 1: Formal Steps
May 05, 2014

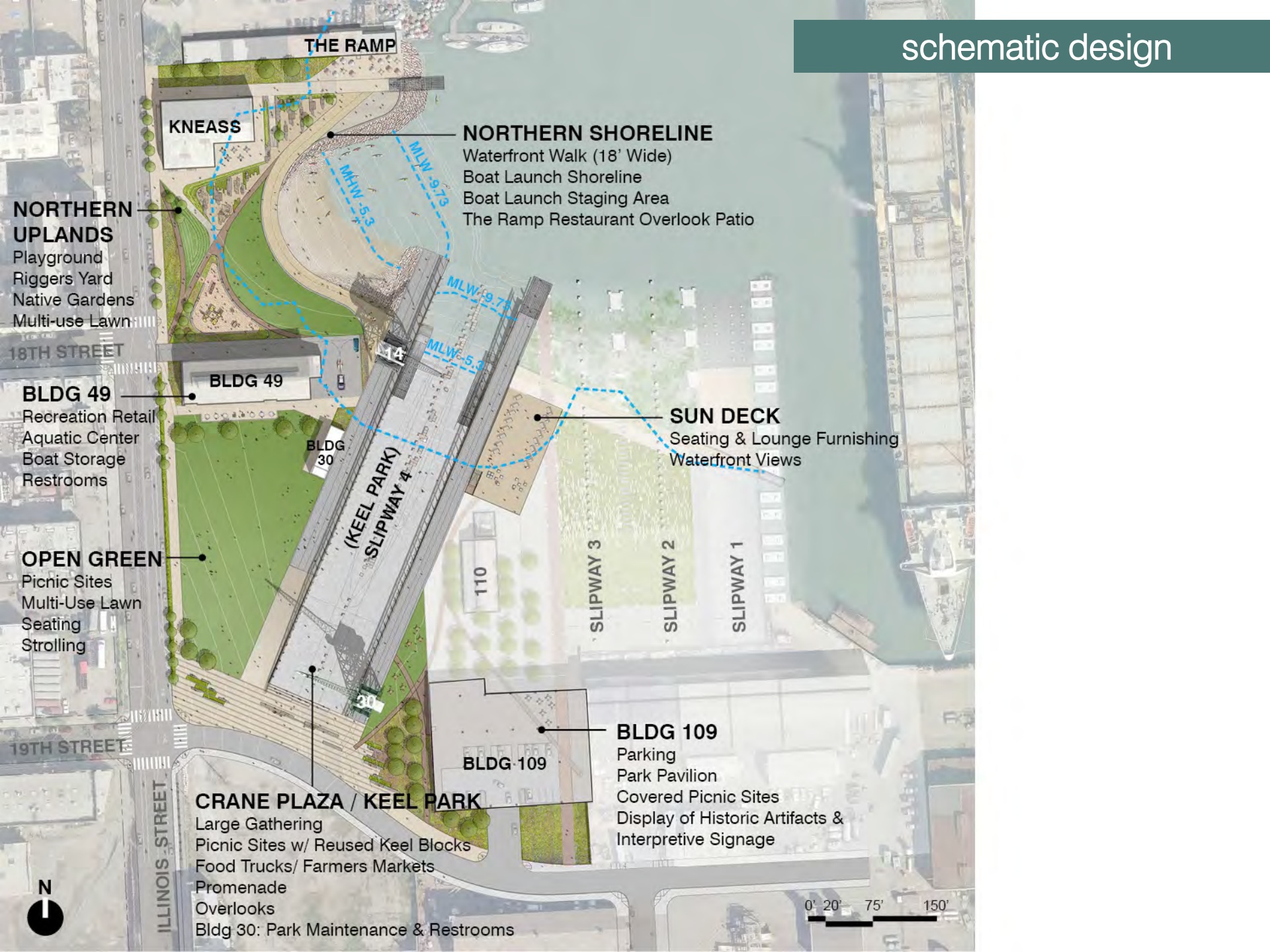

THE RAMP

KNEASS

NORTHERN SHORELINE

- Waterfront Walk (18' Wide)
- Boat Launch Shoreline
- Boat Launch Staging Area
- The Ramp Restaurant Overlook Patio

NORTHERN UPLANDS

- Playground
- Riggers Yard
- Native Gardens
- Multi-use Lawn

18TH STREET

BLDG 49

- Recreation Retail
- Aquatic Center
- Boat Storage
- Restrooms

OPEN GREEN

- Picnic Sites
- Multi-Use Lawn
- Seating
- Strolling

19TH STREET

CRANE PLAZA / KEEL PARK

- Large Gathering
- Picnic Sites w/ Reused Keel Blocks
- Food Trucks/ Farmers Markets
- Promenade
- Overlooks
- Bldg 30: Park Maintenance & Restrooms

14

BLDG 30

30

(KEEL PARK)
SLIPWAY 4

110

SLIPWAY 3

SLIPWAY 2

SLIPWAY 1

BLDG 109

BLDG 109

- Parking
- Park Pavilion
- Covered Picnic Sites
- Display of Historic Artifacts & Interpretive Signage

SUN DECK

- Seating & Lounge Furnishing
- Waterfront Views



0' 20' 75' 150'

schematic design



mission



history



water



program

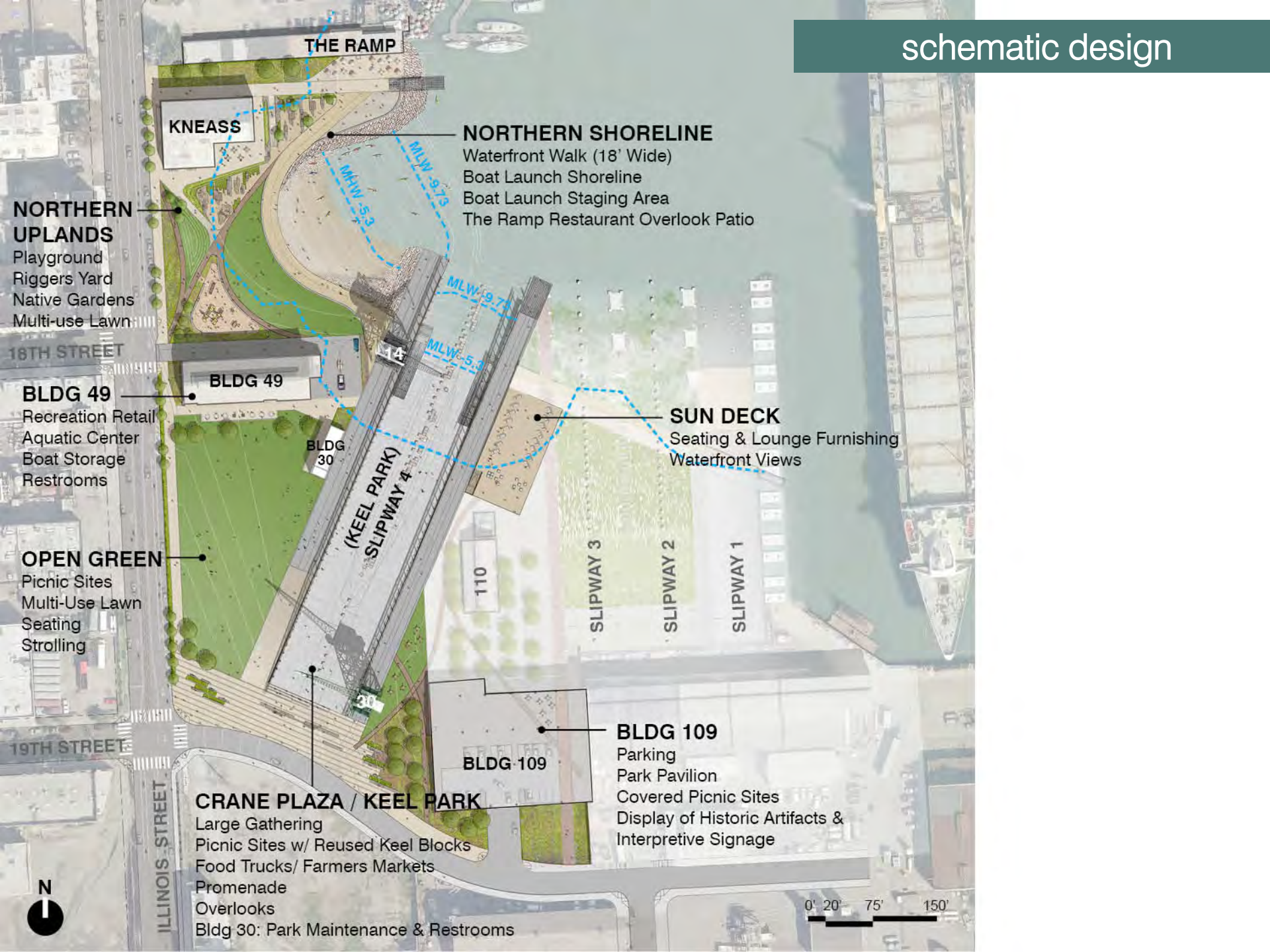

THE RAMP

KNEASS

NORTHERN SHORELINE

- Waterfront Walk (18' Wide)
- Boat Launch Shoreline
- Boat Launch Staging Area
- The Ramp Restaurant Overlook Patio

NORTHERN UPLANDS

- Playground
- Riggers Yard
- Native Gardens
- Multi-use Lawn

18TH STREET

BLDG 49

- Recreation Retail
- Aquatic Center
- Boat Storage
- Restrooms

OPEN GREEN

- Picnic Sites
- Multi-Use Lawn
- Seating
- Strolling

19TH STREET

ILLINOIS STREET



CRANE PLAZA / KEEL PARK

- Large Gathering
- Picnic Sites w/ Reused Keel Blocks
- Food Trucks/ Farmers Markets
- Promenade
- Overlooks
- Bldg 30: Park Maintenance & Restrooms

(KEEL PARK)
SLIPWAY 4

SUN DECK

- Seating & Lounge Furnishing
- Waterfront Views

SLIPWAY 3

SLIPWAY 2

SLIPWAY 1

BLDG 109

BLDG 109

- Parking
- Park Pavilion
- Covered Picnic Sites
- Display of Historic Artifacts & Interpretive Signage

0' 20' 75' 150'

northern shoreline



*Spot elevations (#) reference San Francisco City Datum (0 CCSF = -11.34 NAVD88)

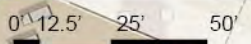

northern shoreline – 3D view



northern shoreline - circulation

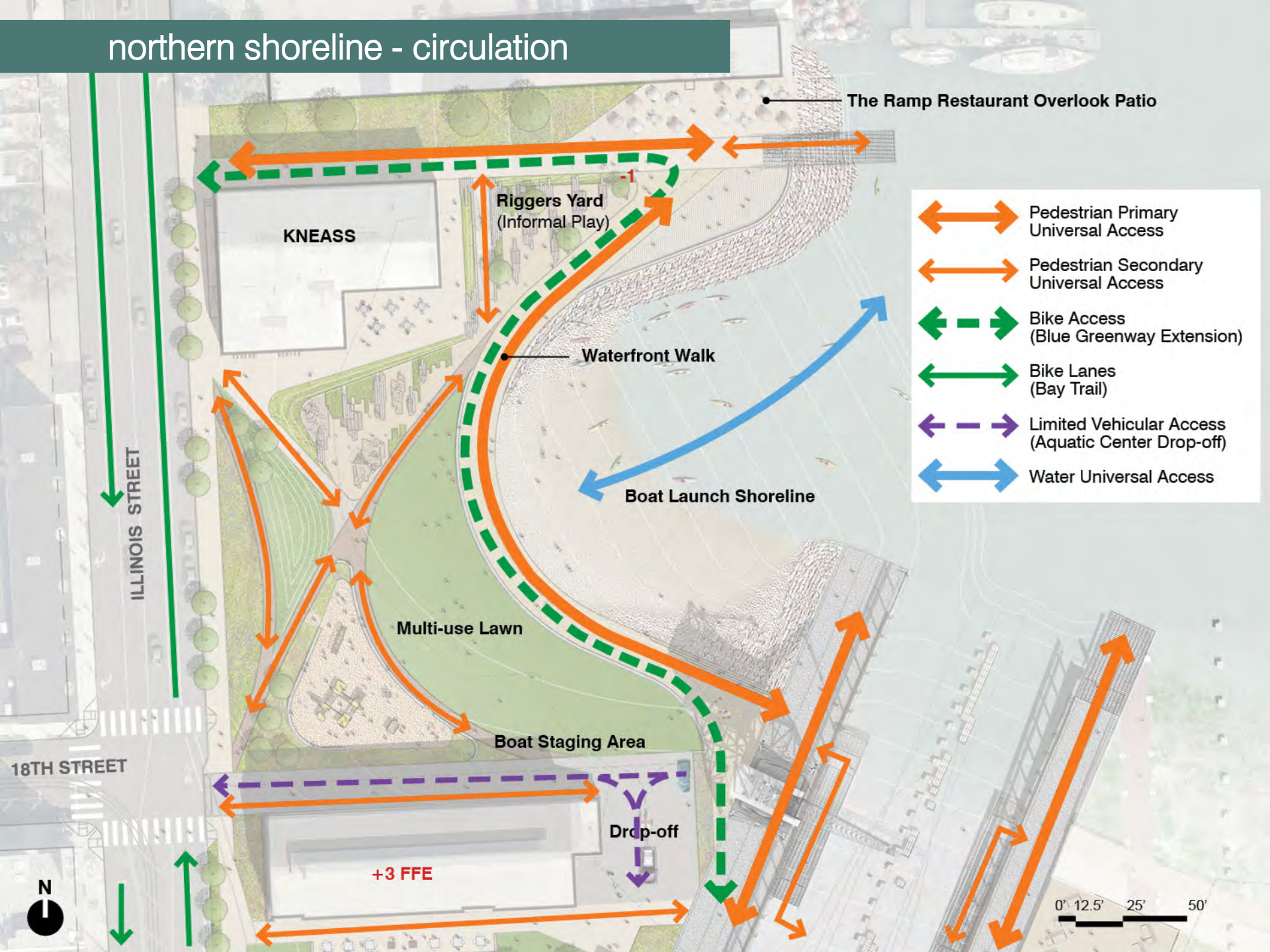

northern shoreline –site section

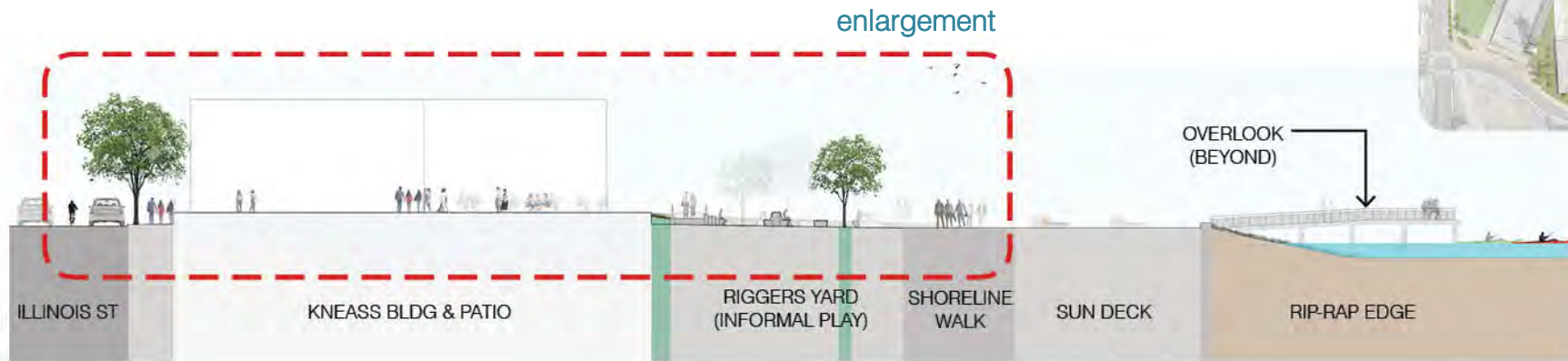

section at Kneass Building & Riggers Yard

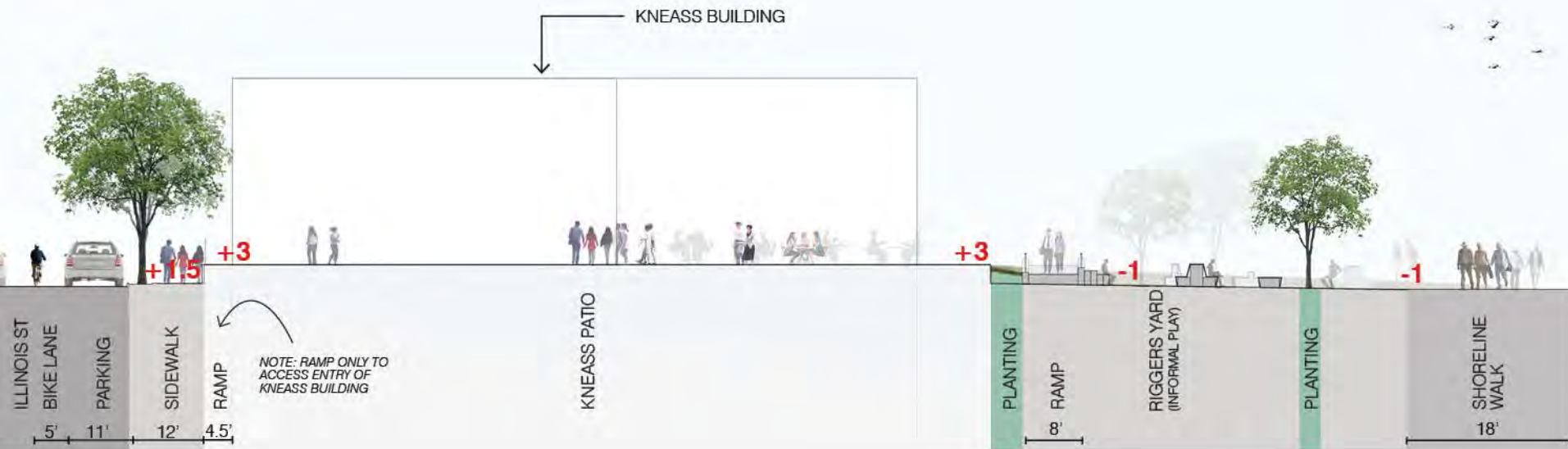

enlargement

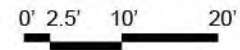

northern shoreline – site section



enlargement

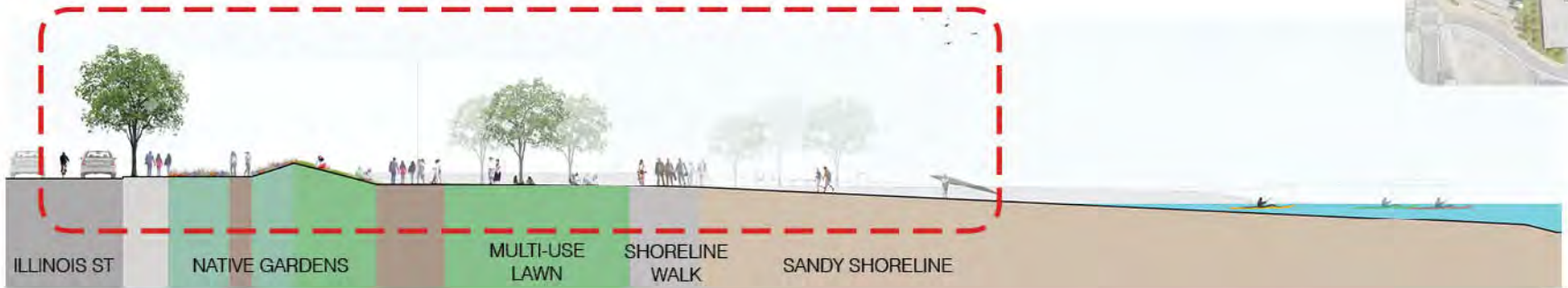

section at multi-use lawn

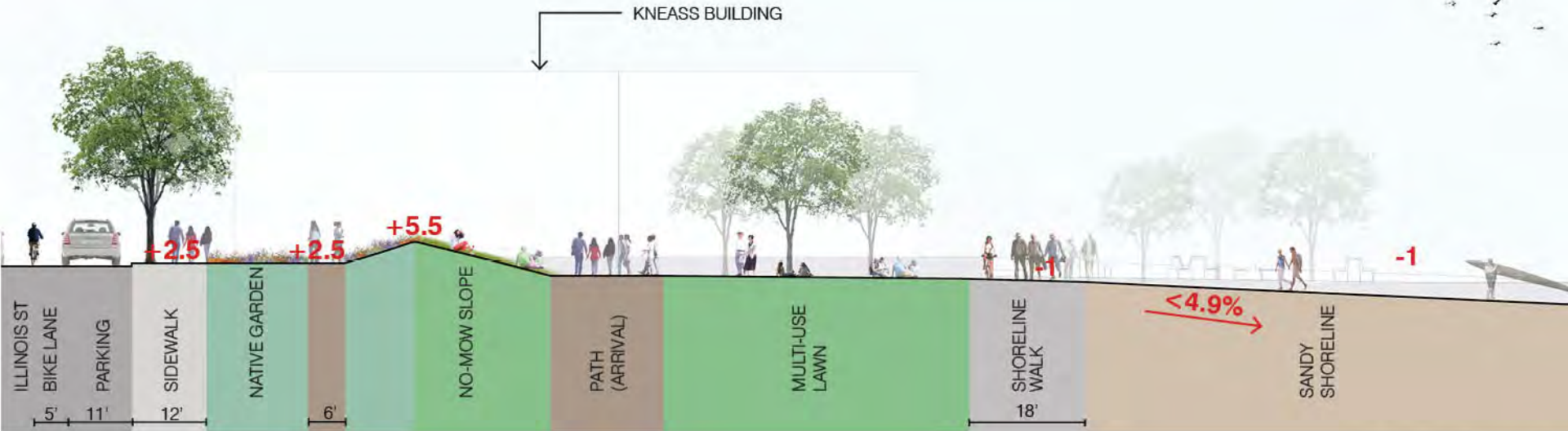

enlargement

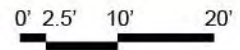

northern shoreline – site section



enlargement

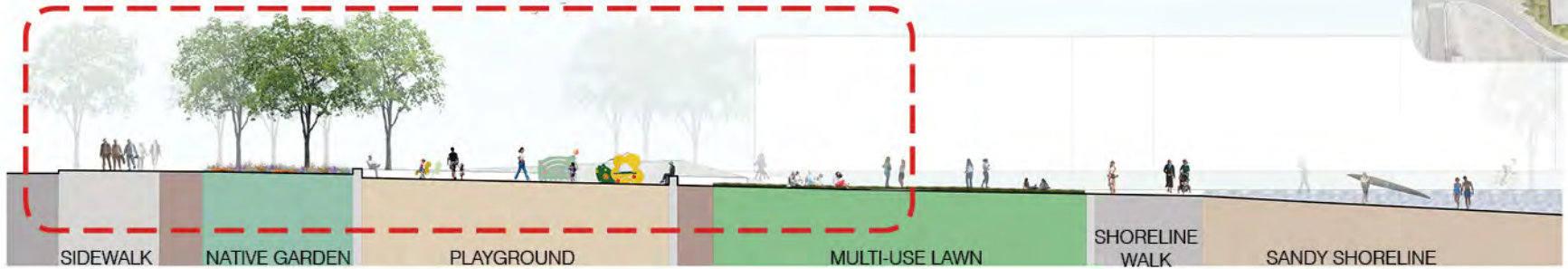

section at playground



enlargement

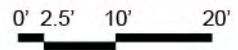



view looking south from The Ramp restaurant patio

northern shoreline



view looking north from The Ramp restaurant patio



view looking east from Illinois sidewalk (south of The Ramp)

northern shoreline



view looking east from Illinois sidewalk (south of The Ramp)



view of un-engineered fill looking south

northern shoreline



view along shoreline walk looking north

northern shoreline

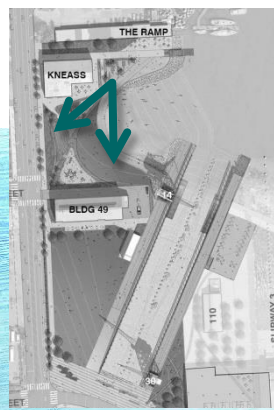

view looking southwest towards multi-use lawn

northern shoreline



cribbing gardens

northern shoreline



Ghost Pier Grove

informal play



TACTILE PATH



POST-INDUSTRIAL

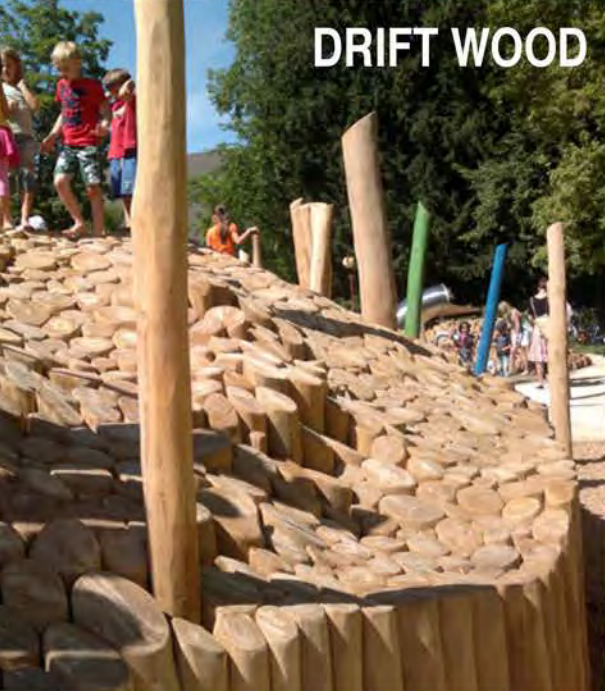

DRIFT WOOD



GHOST PILE



cribbage



northern shoreline – riggers yard

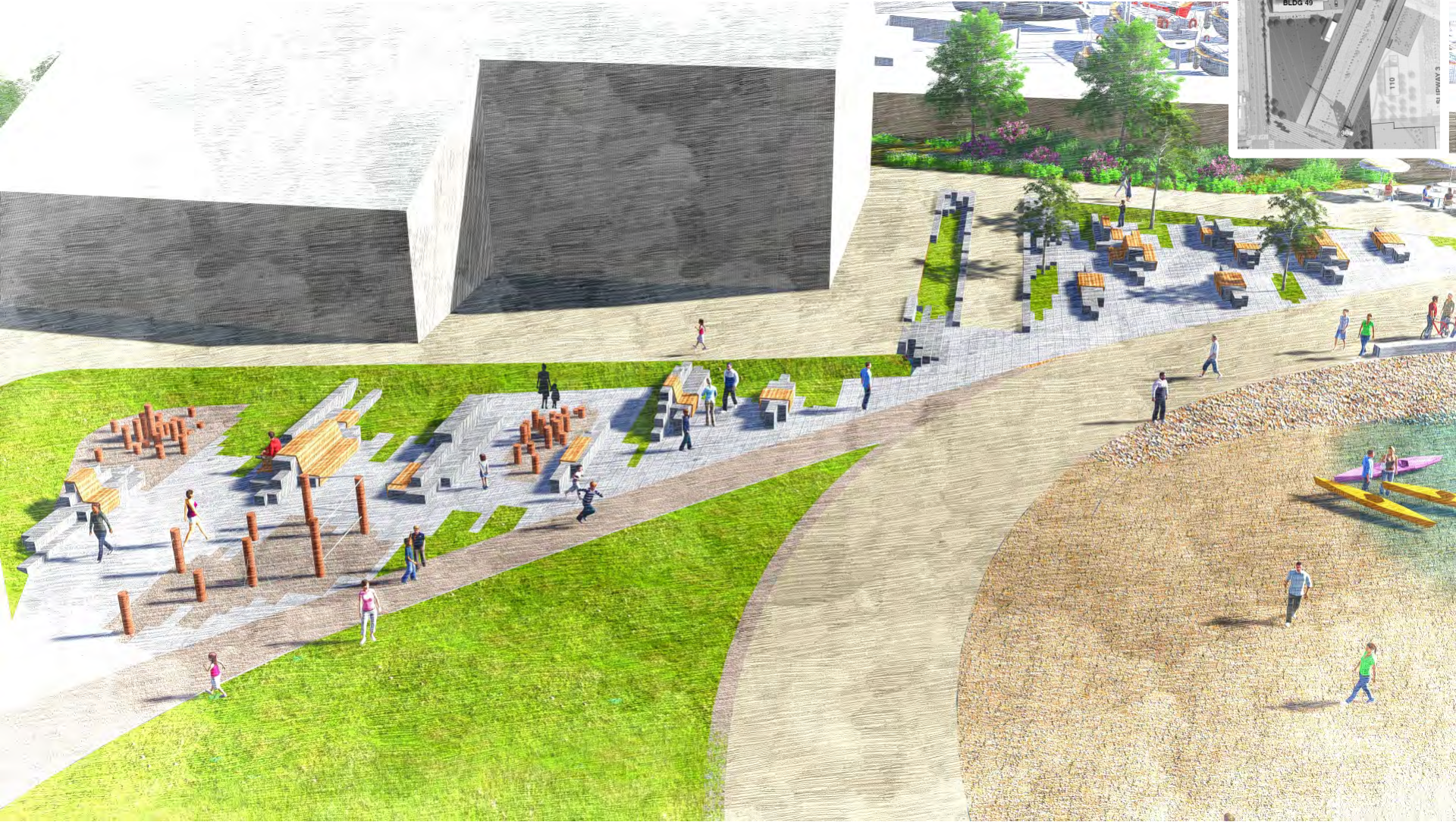

northern shoreline – riggers yard

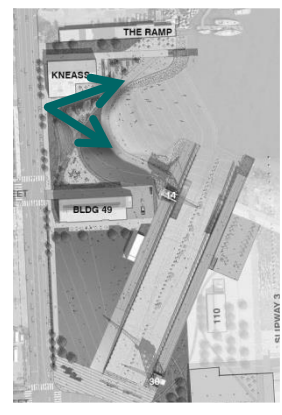

northern shoreline – riggers yard

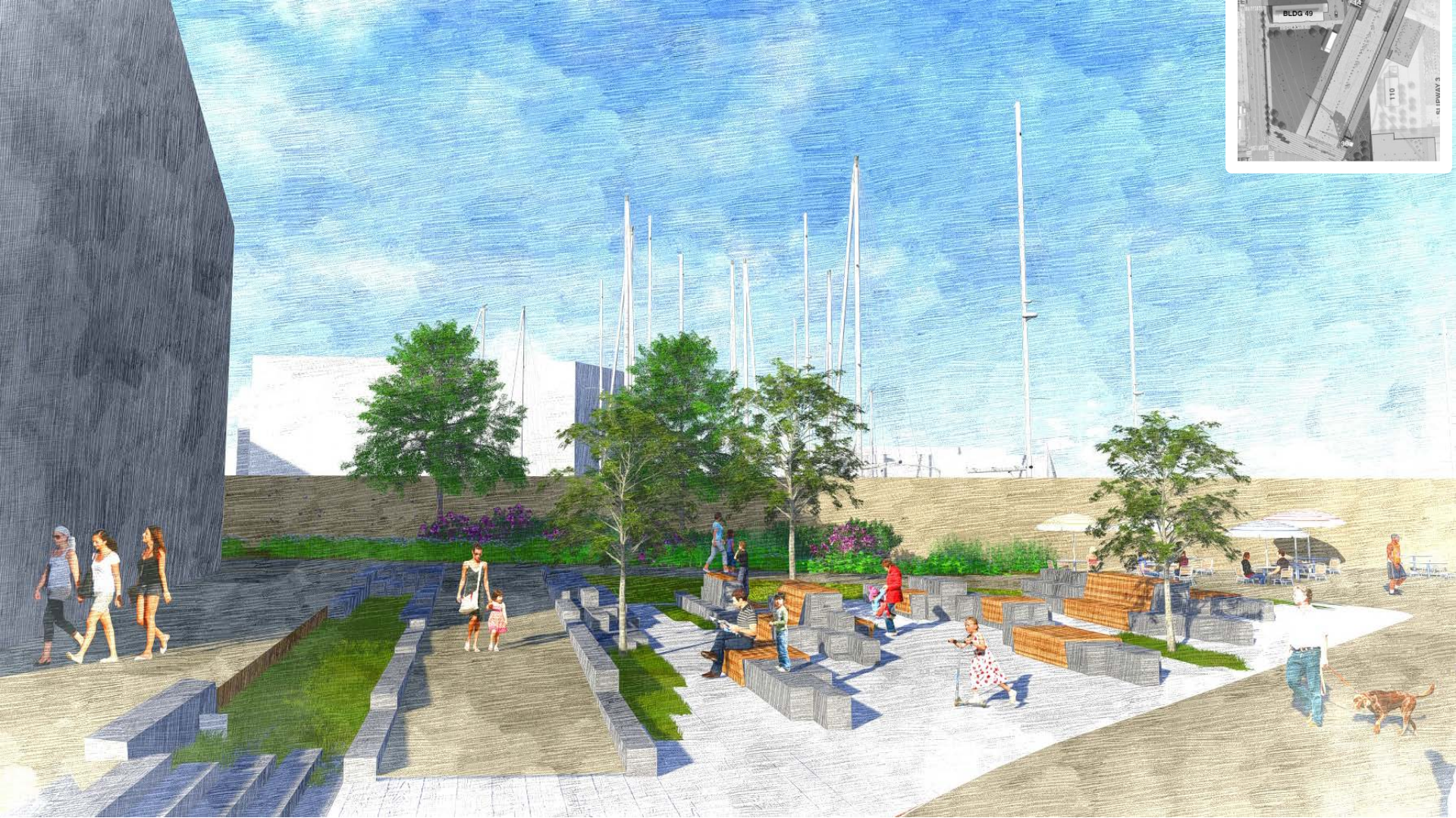

northern shoreline – riggers yard

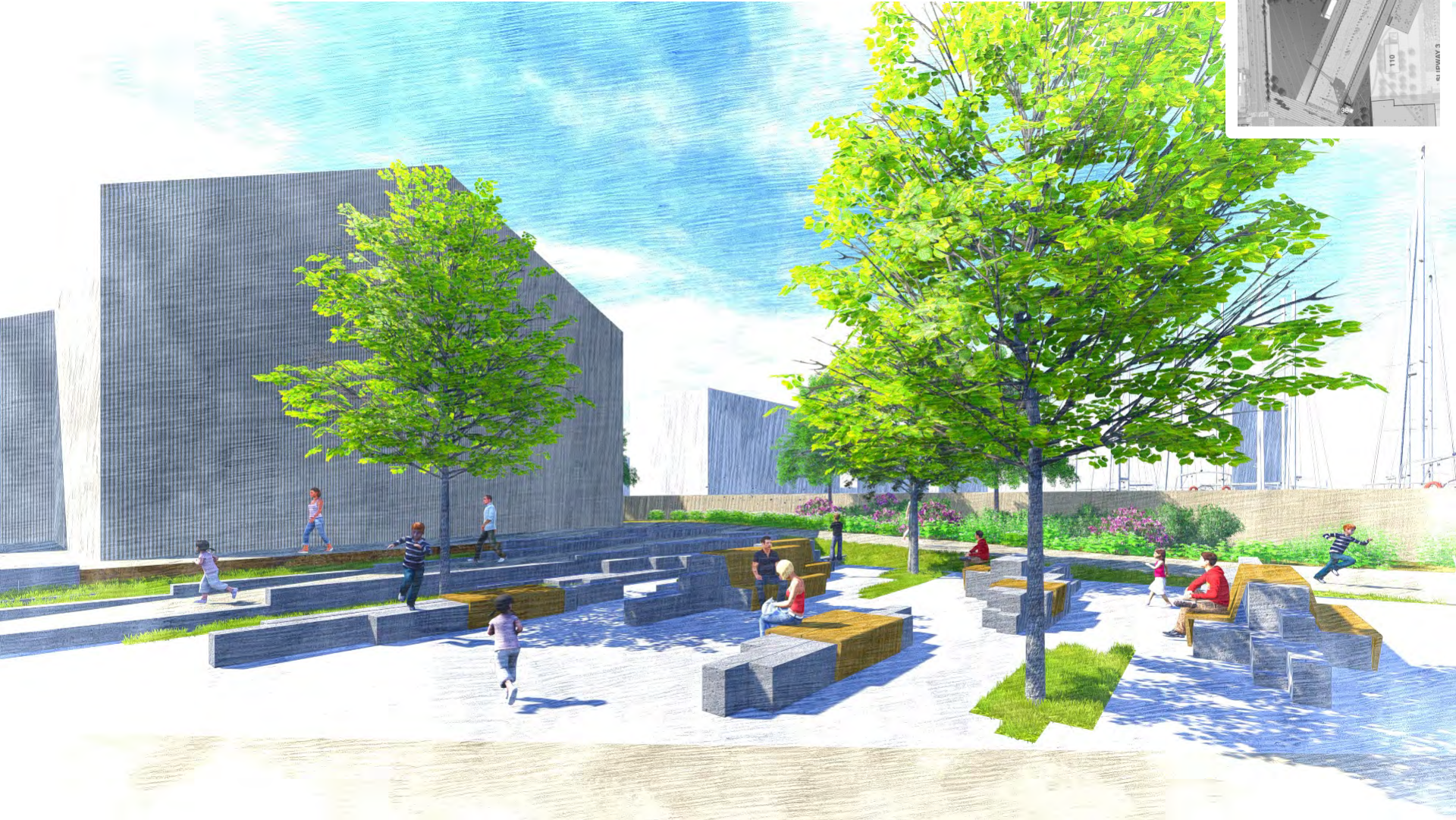

northern shoreline



view looking east at Illinois sidewalk (south of kneass building)

northern shoreline



view looking east at Illinois sidewalk (south of kneass building)

northern shoreline



view looking east from Illinois sidewalk (mid block between mariposa & 18th)

northern shoreline



view looking east at Illinois sidewalk (north of building 49)

northern shoreline

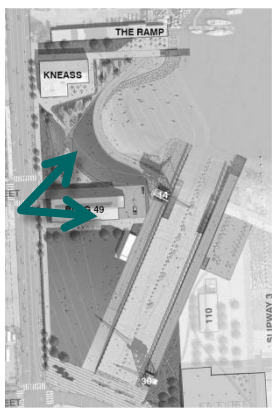

view looking east at Illinois sidewalk (north of building 49)

northern shoreline

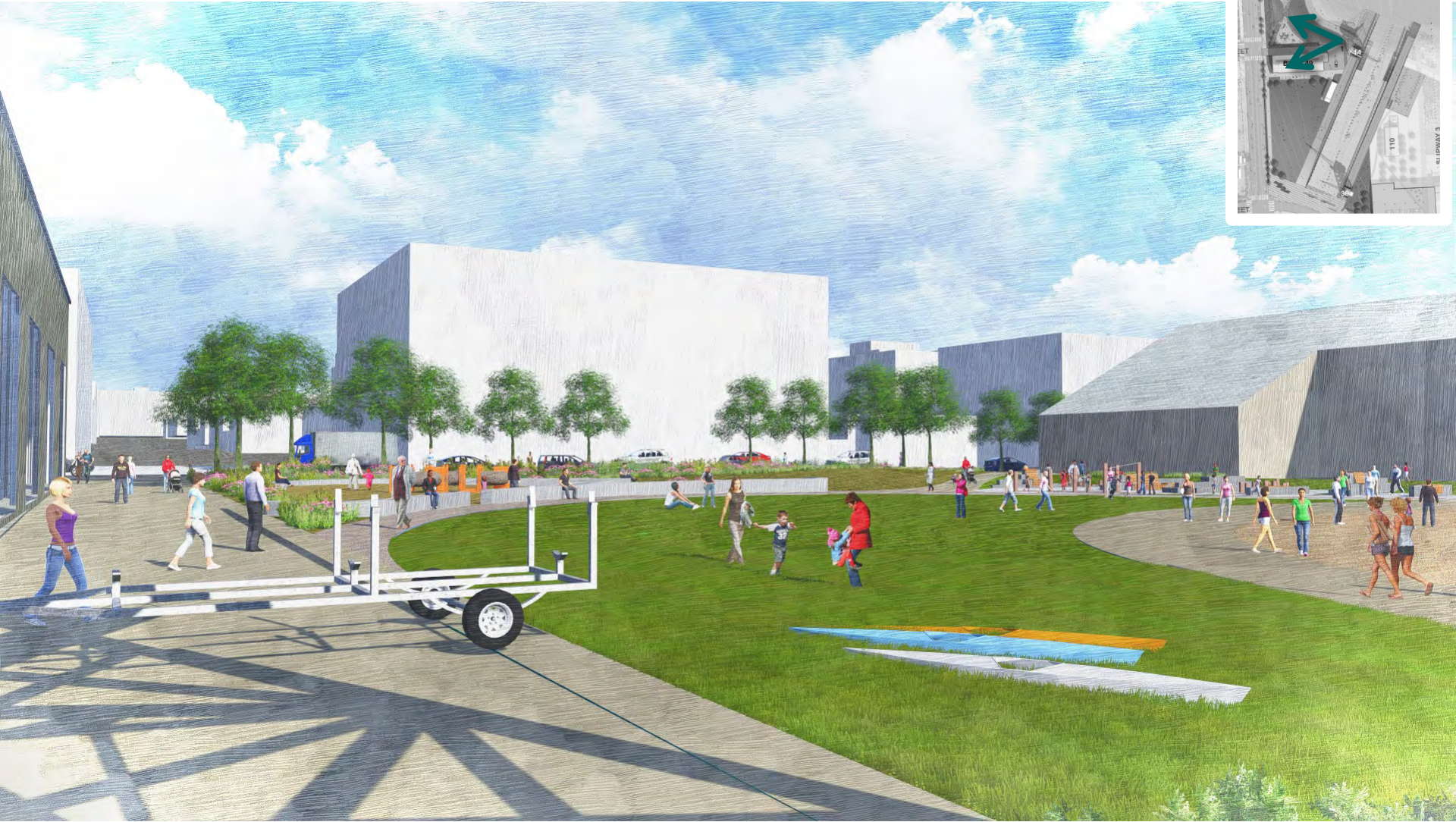
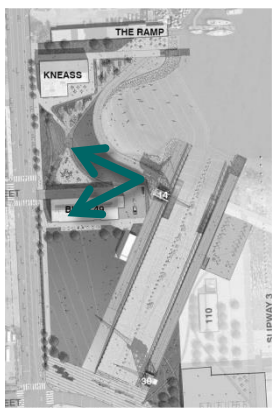

view looking west from drop-off (north of building 49)

northern shoreline

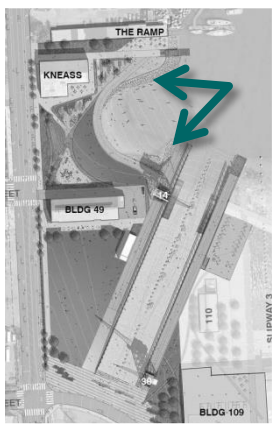

crane plaza options – may 2014

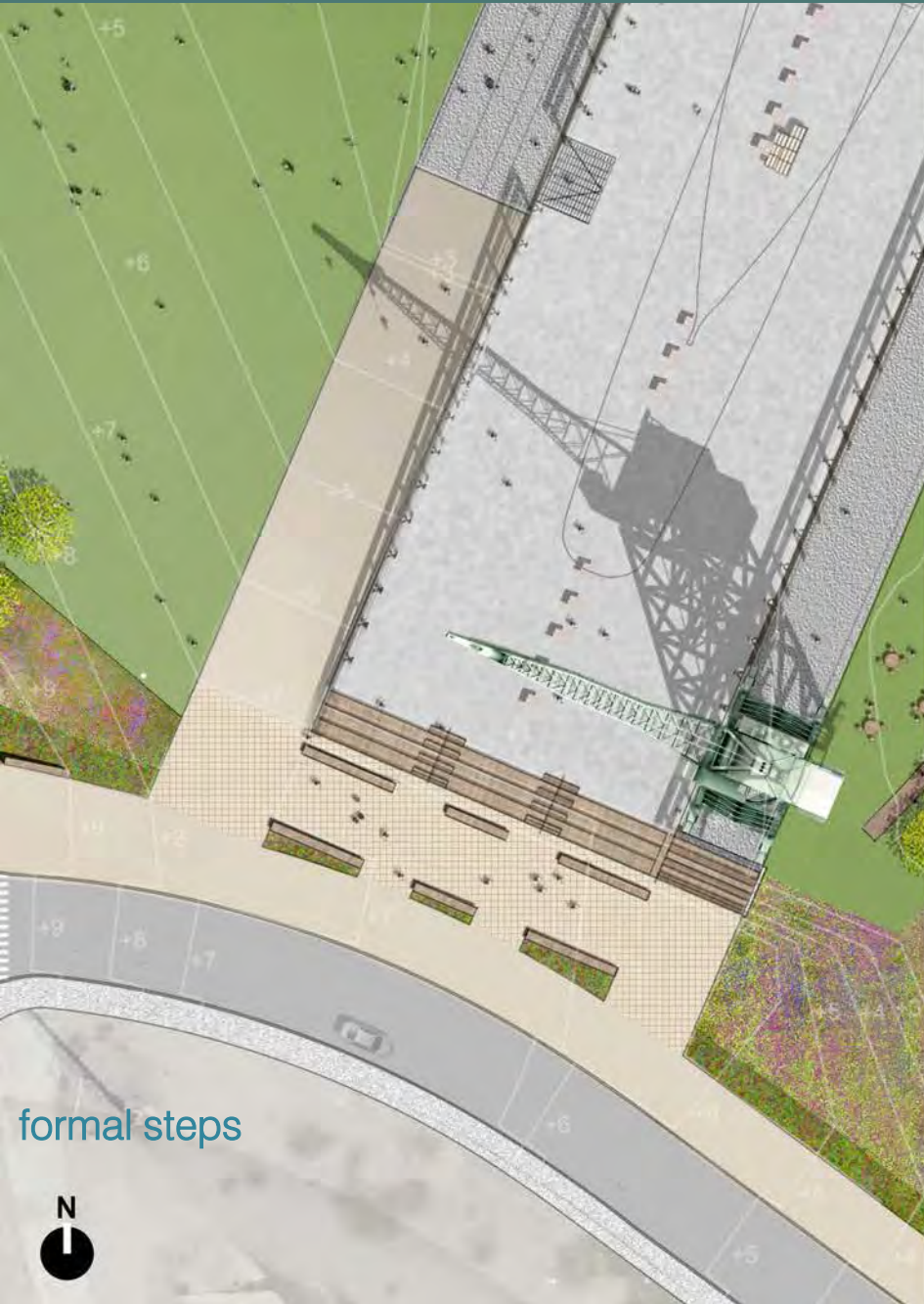

formal steps



slipway steps

crane plaza options – may 2014



sloped entry area under 5% – case studies

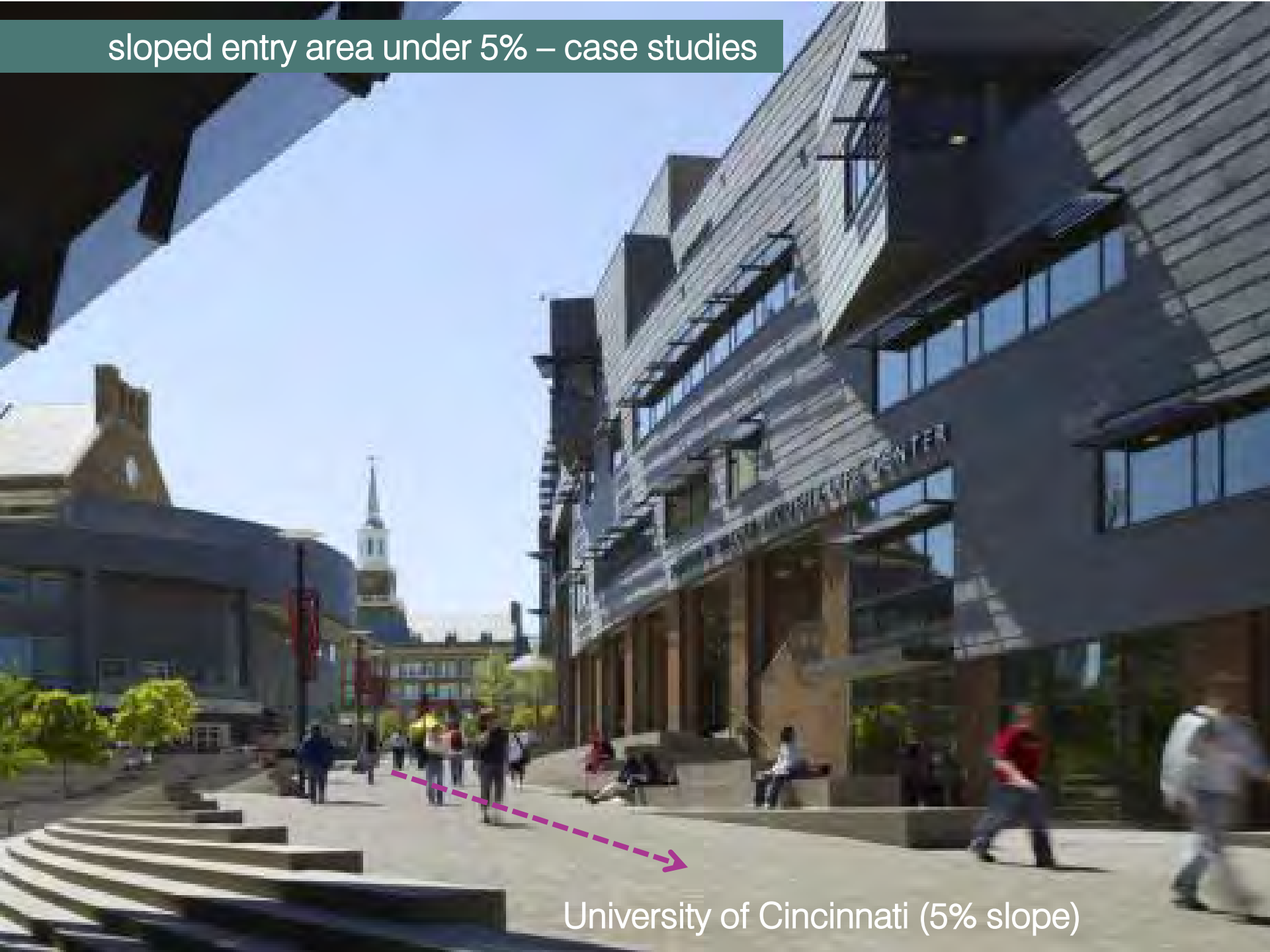

University of Cincinnati (5% slope)

sloped plaza under 5%– case studies



Pier Head, UK (5% slope) - AECOM

crane plaza slipway steps – 3D view

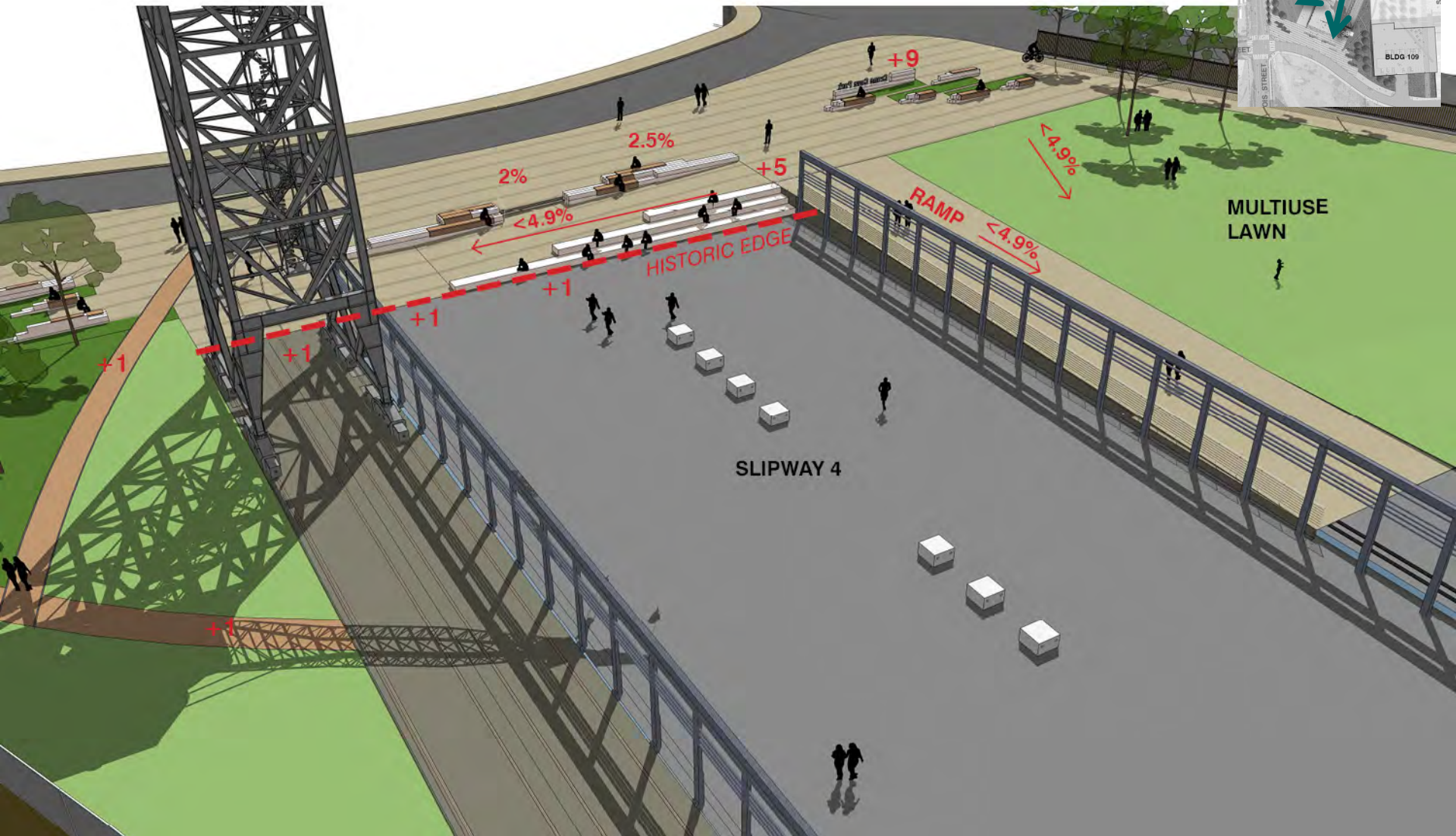
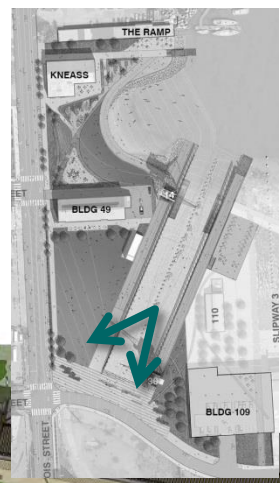

crane plaza slipway steps – 3D view

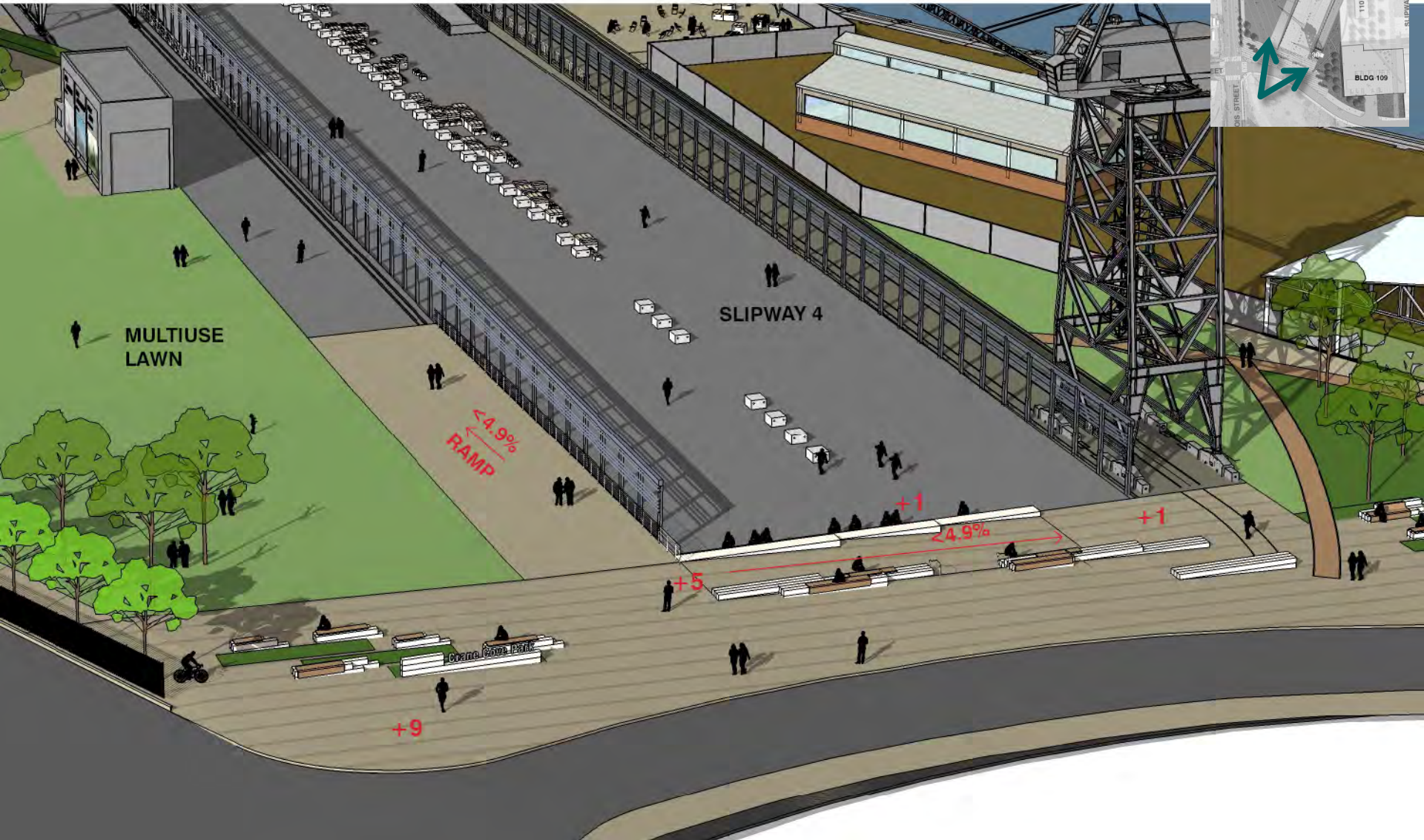

crane plaza slipway steps - circulation

OPEN GREEN

SLIPWAY 4

- Pedestrian Primary Universal Access
- Pedestrian Secondary Universal Access
- Pedestrian Secondary Access
- Bike Access (Blue Greenway Extension)
- Bike Lanes (Bay Trail)
- Limited Vehicular Access (Park related)

19TH STREET

BUILDING 109

ILLINOIS STREET



0' 12.5' 25' 50'

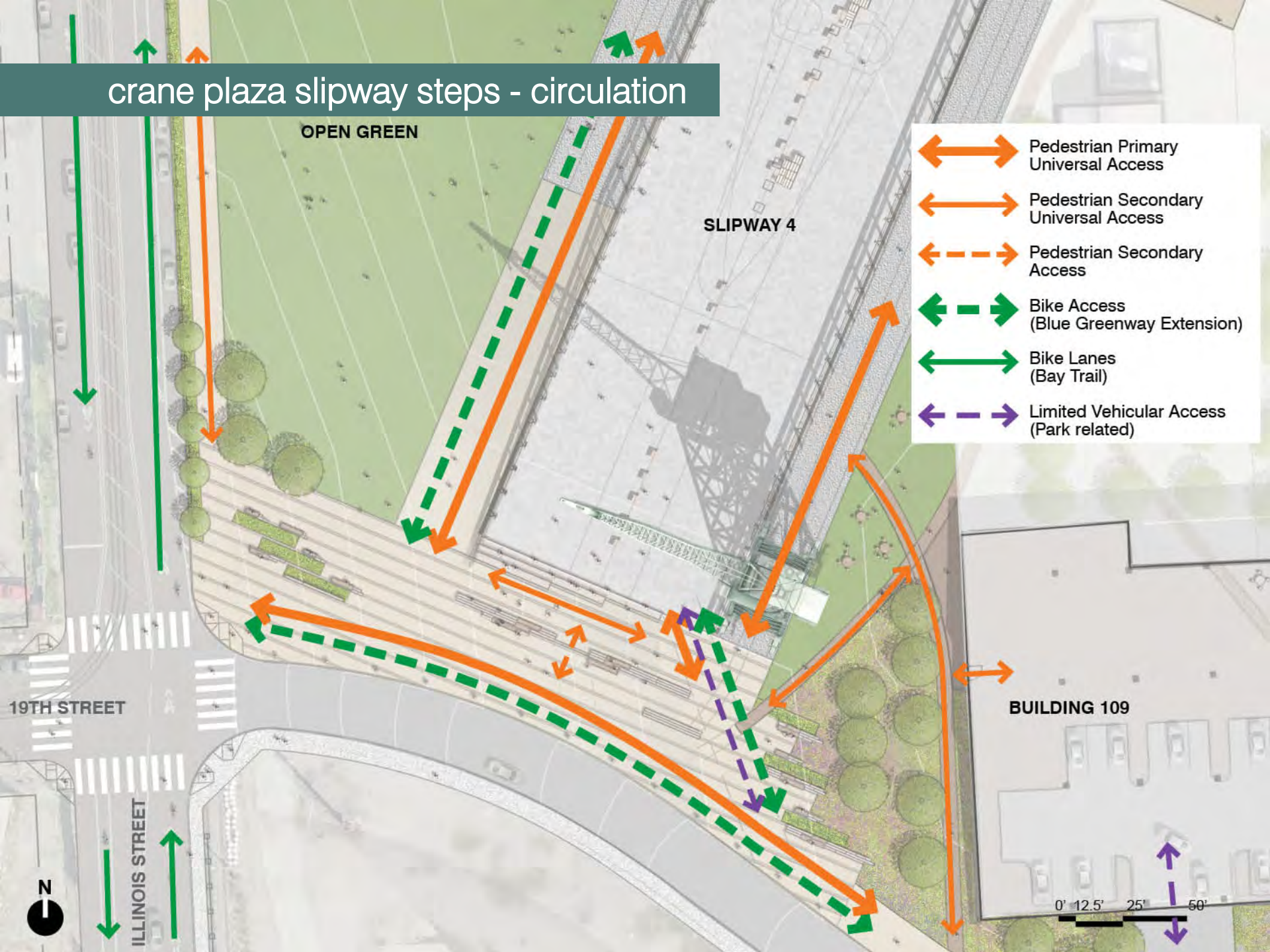

crane plaza slipway steps- section

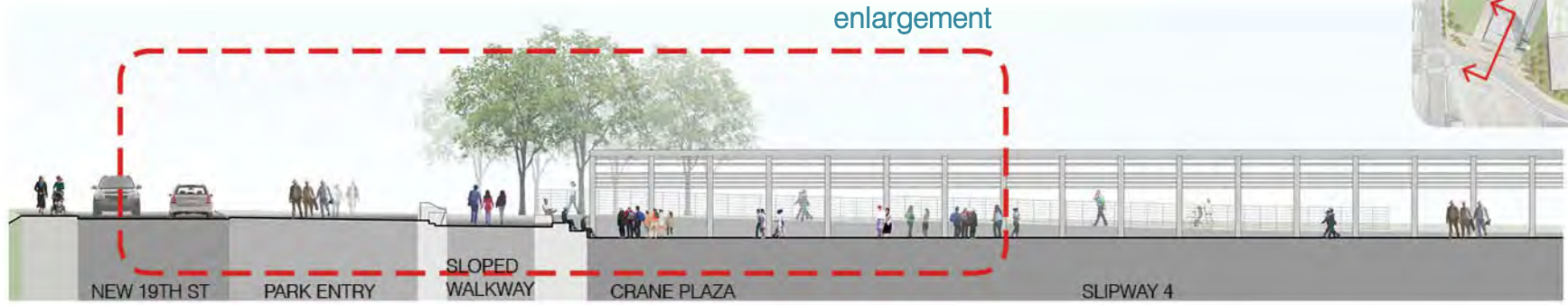

section at center of slipway 4 looking west

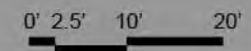
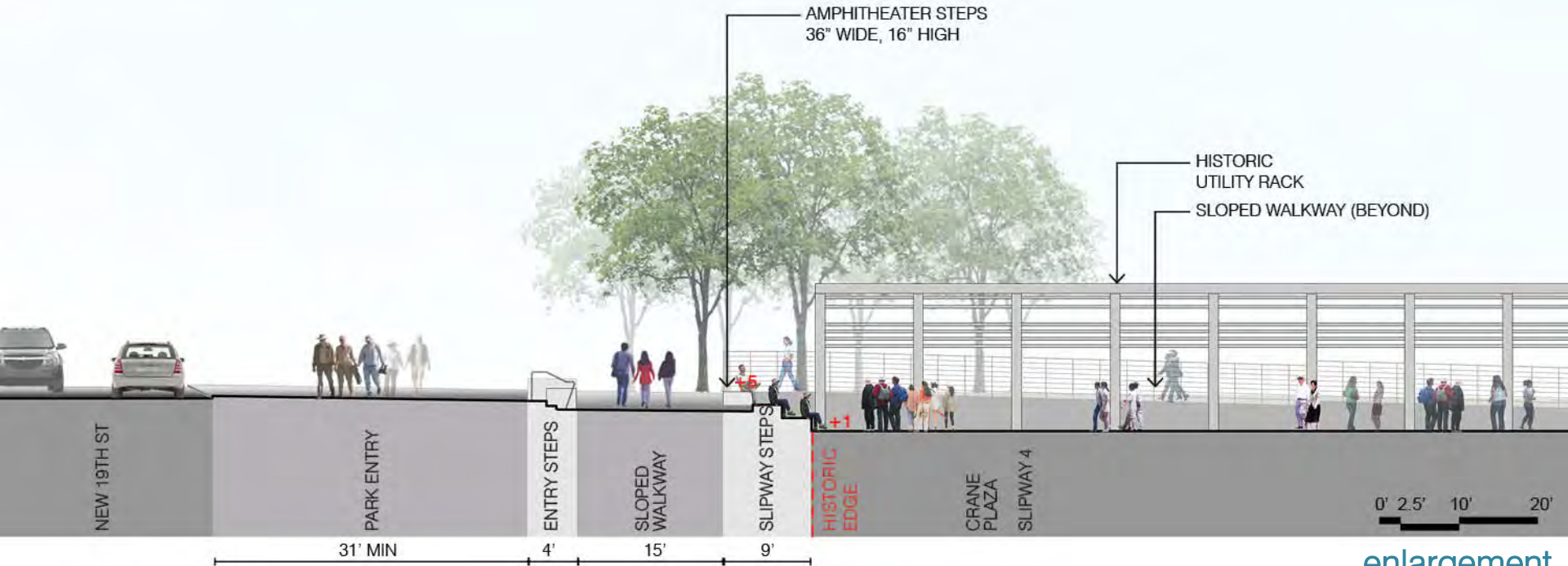

enlargement

crane plaza slipway steps- section

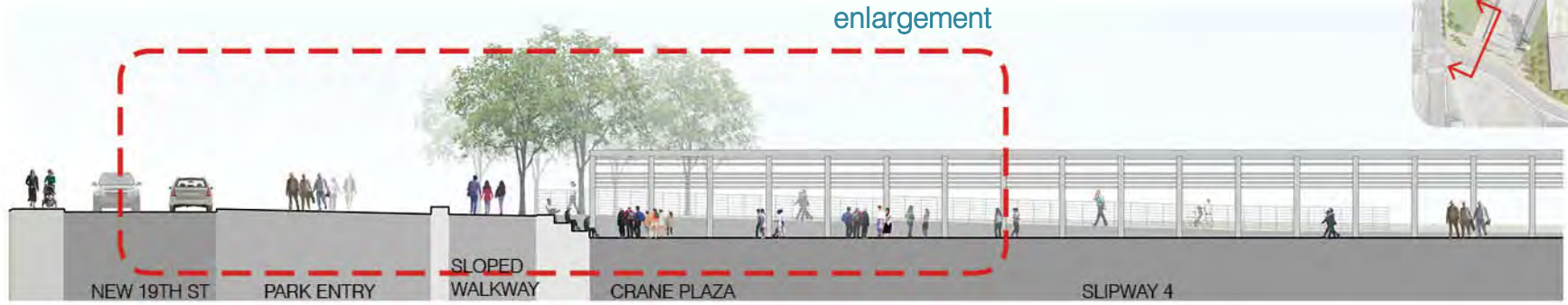

enlargement

section at center of slipway 4 looking west

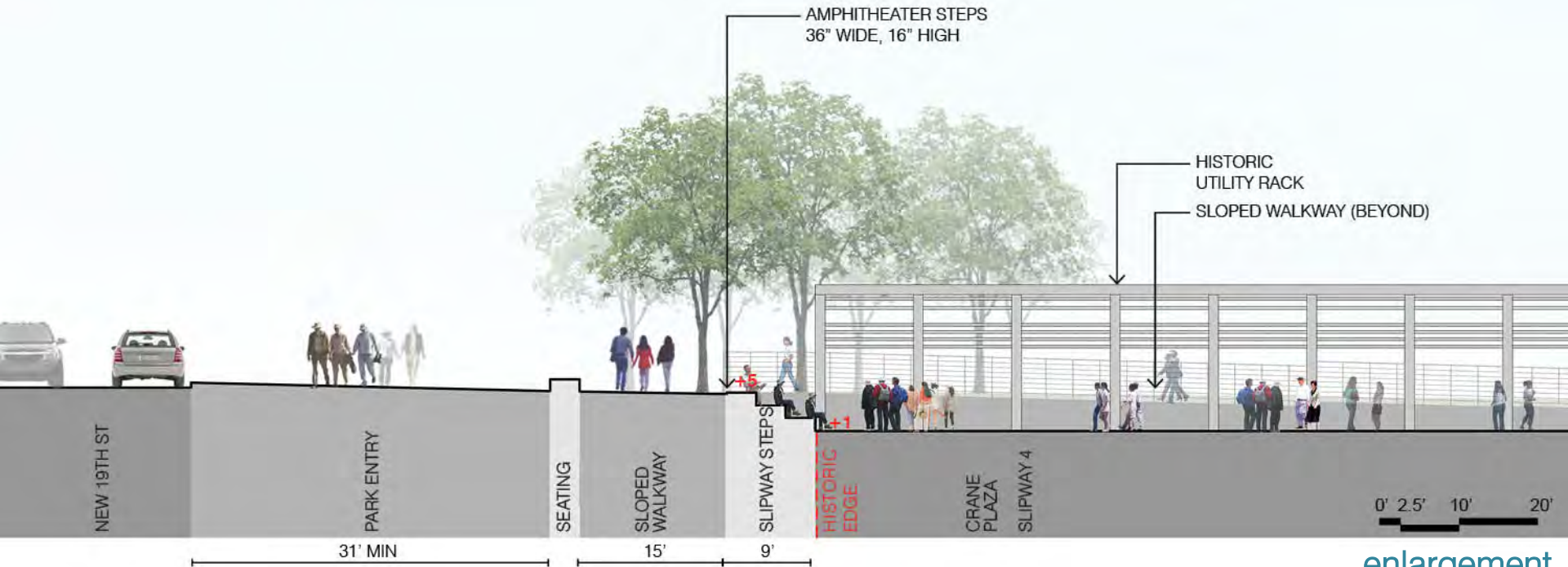

AMPHITHEATER STEPS
36" WIDE, 16" HIGH

HISTORIC
UTILITY RACK
SLOPED WALKWAY (BEYOND)

0' 2.5' 10' 20'

enlargement

crane plaza slipway steps

before



view from corner of 19th & Illinois

crane plaza slipway steps



view from corner of 19th & Illinois

crane plaza slipway steps

before



view at the end of slipway 4

crane plaza slipway steps



view at the end of slipway 4

crane plaza slipway steps



view at eastern runway facing west

crane plaza slipway steps



view at eastern runway facing west

schematic design

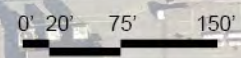

site circulation



- Pedestrian Primary Universal Access
- Pedestrian Secondary Universal Access
- Pedestrian Secondary Access
- Bike Access (Blue Greenway Extension)
- Bike Lanes (Bay Trail)
- Limited Vehicular Access (Park related)



0' 20' 75' 150'

sea level rise

- MHHW (-4.52 FT)
- Base Flood (0.99 FT)
- 2065 MHHW (-2.61 FT)
- 2065 Base Flood (+2.90 FT)
- 2100 MHHW (-0.34 FT)
- 2100 Base Flood (+5.17 FT)

Elevations shown based on San Francisco City Datum.
Based on See Level Rise projections of 16" at 2050 and 55" at 2100 (from 2000 level). Elevations today are 2015.

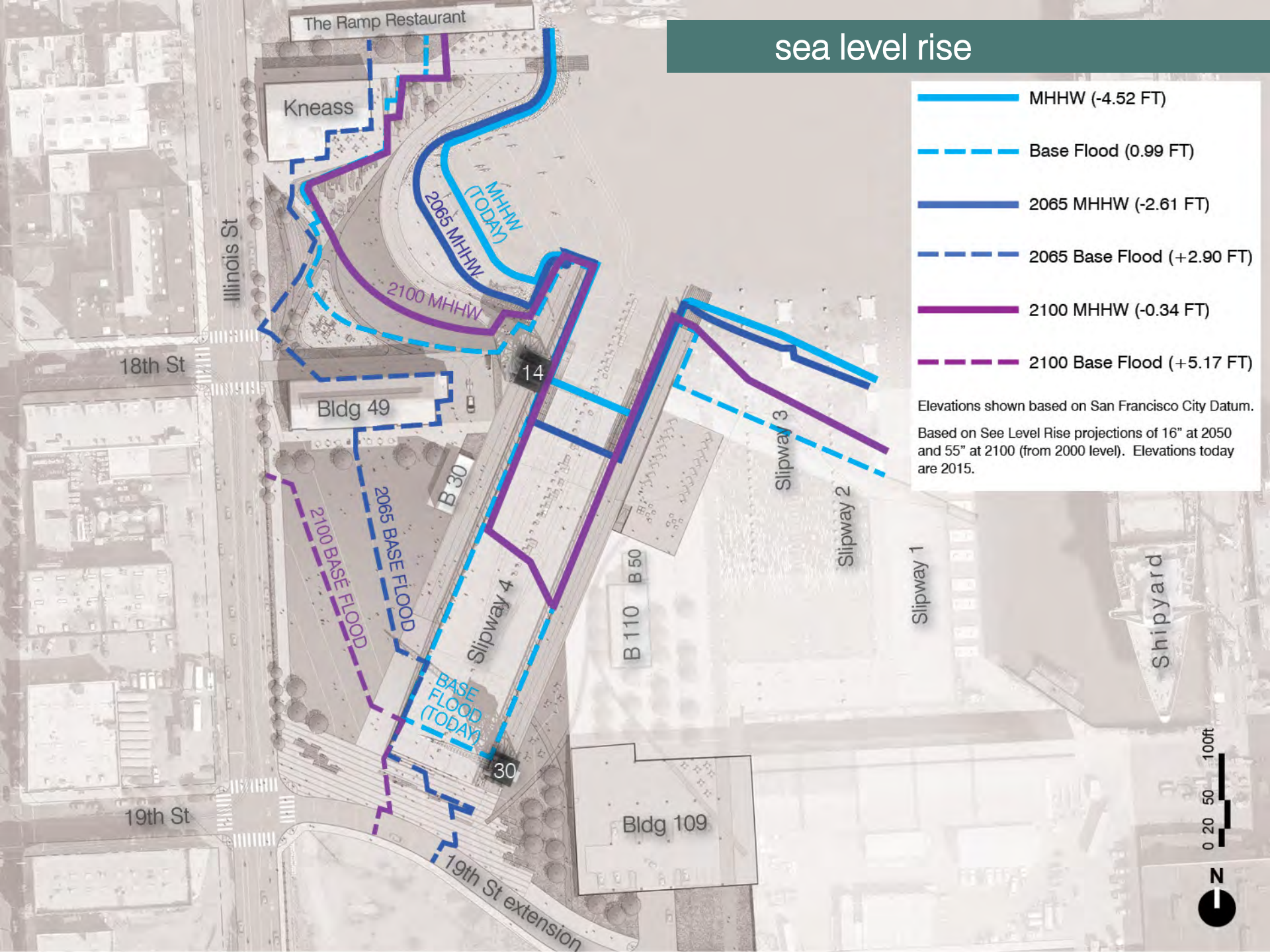

schematic design



THANK YOU