

# crane cove park master plan

WDAC + CWAG presentation

december 09, 2013

crane cove park

master plan

# crane cove park master plan

WDAC + CWAG presentation

december 09, 2013

Introduction | B. Rhett, D. Beaupre, Port of SF

Master Plan presentation | P. Fonseca, AECOM

Preliminary Comments | CWAG, WDAC

Public Comments (2 min / person) | Public

Discussion | CWAG, WDAC

Next Steps | D. Beaupre, Port of SF



# public + stakeholder input



**March 2012**

Existing Conditions, Opportunities & Constraints, Project Aspirations  
– CWAG, Port Commission, Potrero Boosters

**May , 2012 - *Alternative Concept Plans***

(2 community workshops 100 + participants)

Port Commission

Central Waterfront Advisory Group (CWAG)

SF Architectural Heritage

Potrero Boosters

On Line Comment Survey

**December , 2012 - Draft Park Plan, Cost Estimate and Phasing**

Community Workshop 70+ participants

Port Commission, WDAC, BCDC Design Review Board

CWAG, Potrero Boosters, SF Architectural Heritage

On Line Survey Comment

**May – July 2013 Park Master Plan, Cost & Phasing**

Community Workshop 50+ participants

Port Commission, WDAC, BCDC Design Review Board

CWAG, Potrero Boosters, SF Architectural Heritage

On Line Survey Comment

**August , 2013**

SF Historic Preservation Commission, Key Stakeholders,  
Adjacent Tenants

**September , 2013 Park Master Plan, Cost & Phasing**

WDAC, BCDC Design Review Board

**September – December 2013 Key Stakeholder Outreach**

WDAC, Community Members, Bay Access, Bay Area Water Trail

Accessibility Sub – Committee, SF Mayors Disability Council –

Physical Access Committee

# project location

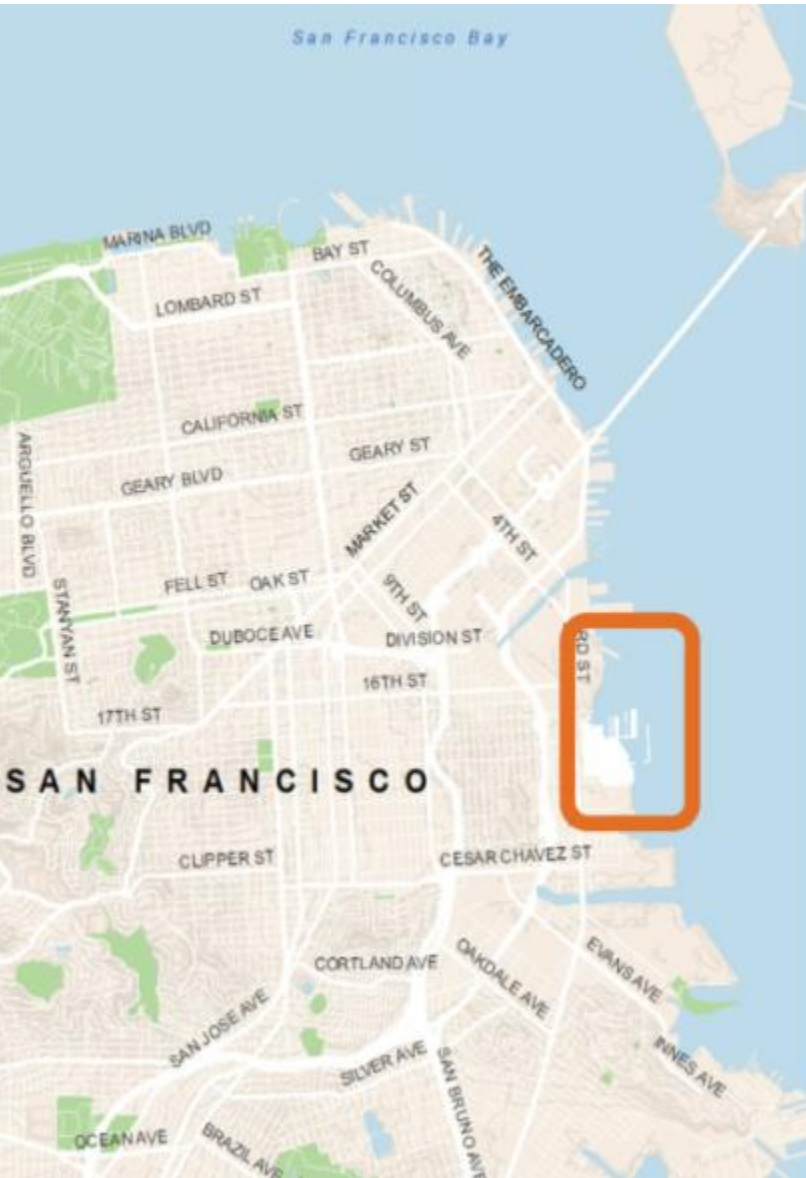



# waterfront open spaces : scale + program



## Park Acreage

*Current / Planned*

### MISSION CREEK NORTH + SOUTH:

Dog park, relaxing, picnics, sports play, water access, events, nature preserve, kayaks, walking, community center, sports, amphitheater, community garden

### MISSION ROCK:

Views, dogs, relaxing, picnics, water access, large multi-purpose lawn areas, play, events, sports

### BAYFRONT / PIER 52:

Views, large multi-purpose lawn area, water access, relaxing, picnics, history, walking, fishing, cycling

### CRANE COVE PARK:

Views, lawn, water access, relaxing, picnics, history, play, events, kayaks, cycling

### PIER 70 WATERFRONT:

Views, dogs, relaxing, picnics, history, play, events, cycling, dining, art, culture, retail

### WARM WATER COVE:

Views, dogs, relaxing, picnics, history, kayaks, cycling, native gardens

pier 70 master plan : sub-areas



### LAND USES + RESOURCES

- Very Significant Historic Resources
- Significant Historic Resources
- Context Historic Resources
- Open Space
- Infill Development Sites
- Ship Repair (Historic Use)
- Former Pier, Wharf or Slipway
- Proposed Building Removal
- Pier 70 Area Boundary
- # Infill Zone

### PIER 70 SUB-AREAS

- COVE AREA (Port of SF)
- HISTORIC CORE (Orton)
- SHIP REPAIR (BAE Systems)
- WATERFRONT SITE (Forest City)
- HILL (Port of SF)





SEPTEMBER crane plaza  
09/2013

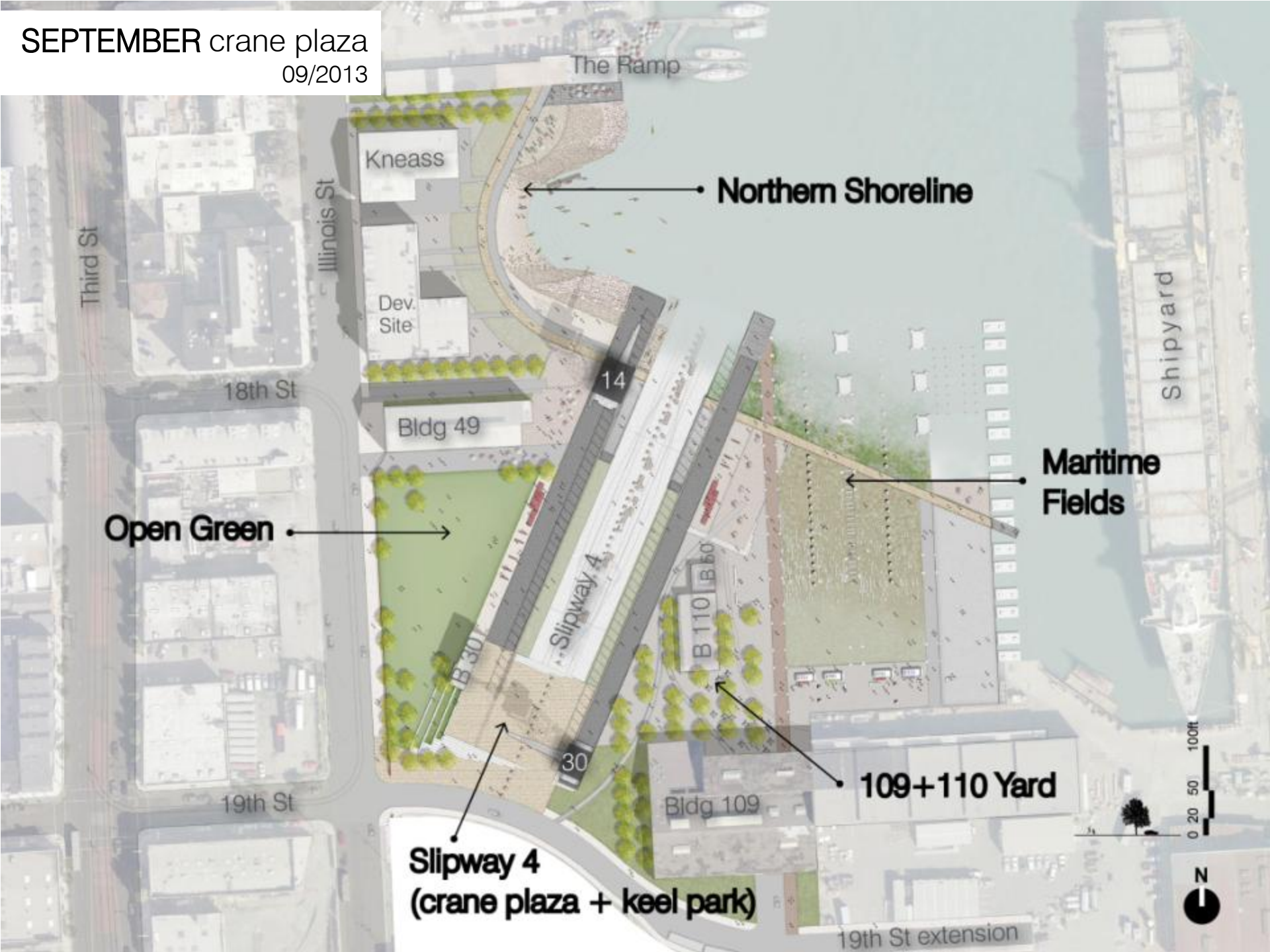

The Ramp

Kneass

Dev. Site

Bldg 49

14

Slipway 4

30

B 110 B 50

Bldg 109

109+110 Yard

Slipway 4  
(crane plaza + keel park)

Northern Shoreline

Maritime Fields

Shipyard

Open Green

Third St

Illinois St

18th St

19th St

19th St extension

0 20 50 100ft



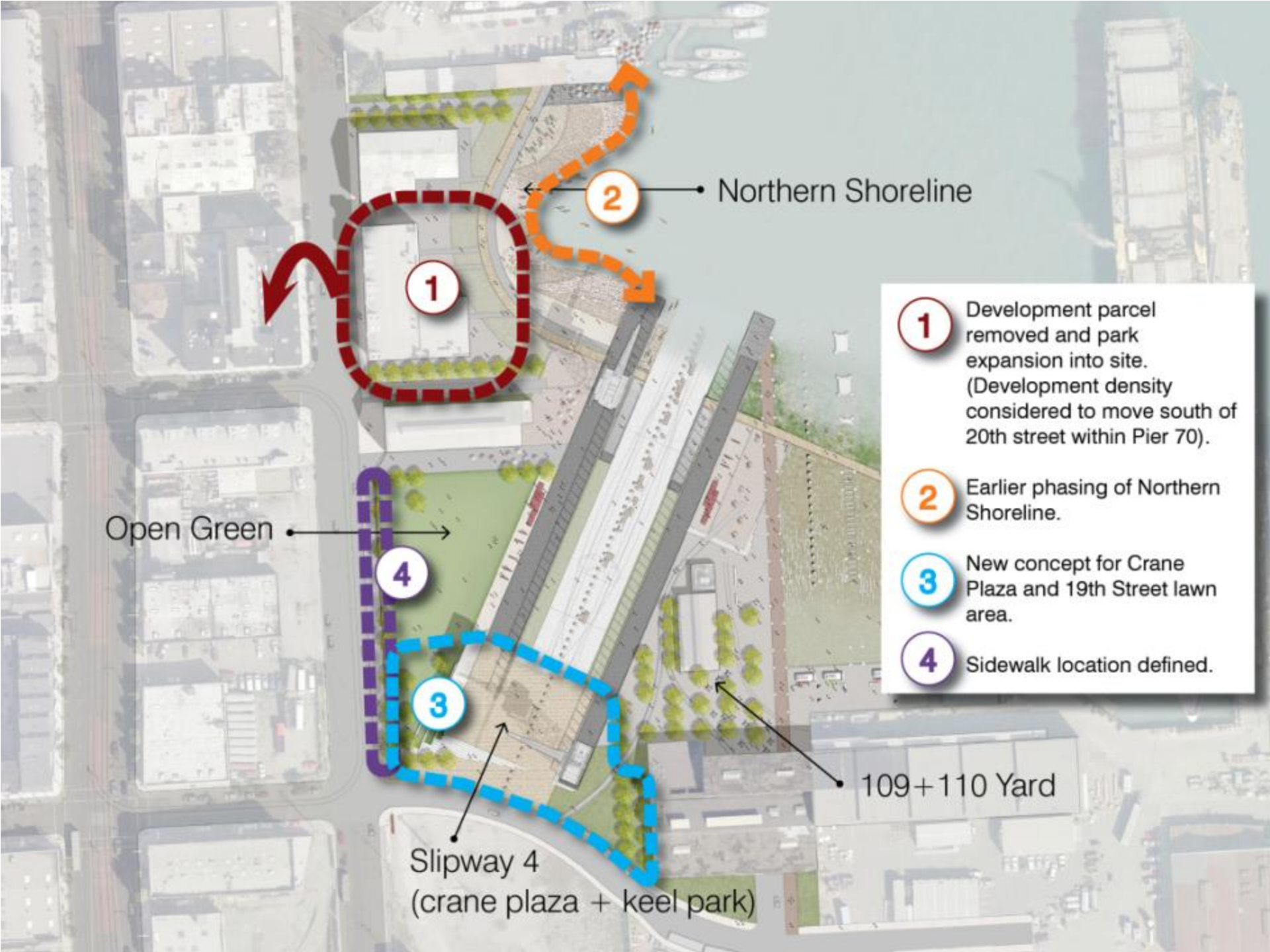

2

Northern Shoreline

1

1

Development parcel removed and park expansion into site. (Development density considered to move south of 20th street within Pier 70).

2

Earlier phasing of Northern Shoreline.

3

New concept for Crane Plaza and 19th Street lawn area.

4

Sidewalk location defined.

Open Green

4

3

Slipway 4  
(crane plaza + keel park)

109+110 Yard



# crane cove park

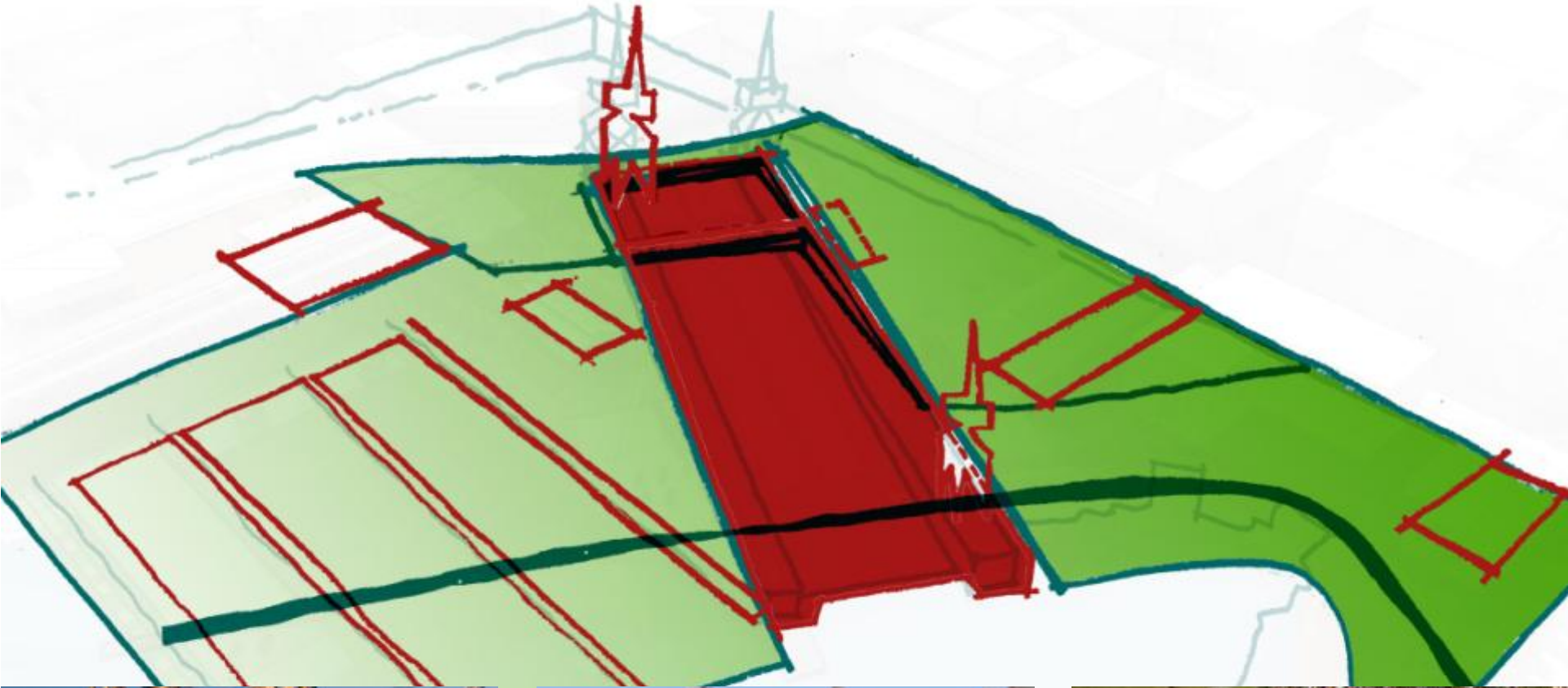

history



water



program

SEPTEMBER master plan  
09/2013



The Ramp

Kneass

Dev. Site

Northern Shoreline

Third St

Illinois St

18th St

Bldg 49

14

Slipway 4

Open Green

Maritime Fields

Shipyard

19th St

B 307

30

B 110 B 50

Bldg 109

109+110 Yard

Slipway 4  
(crane plaza + keel park)

19th St extension

0 20 50 100ft





SEPTEMBER master plan  
09/2013



The Ramp

Kneass

Dev. Site

Northern Shoreline

Third St

Illinois St

18th St

Bldg 49

14

Open Green

Maritime Fields

Shipyard

19th St

B 30

30

Slipway 4

B 110 B 50

Bldg 109

109+110 Yard

Slipway 4  
(crane plaza + keel park)

19th St extension

0 20 50 100ft



**DECEMBER** master plan  
12/2013



Third St

Illinois St

18th St

19th St

19th St extension

The Ramp

Kneass

Bldg 49

B 30

14

Slipway 4

B 110

B 50

Bldg 109

109+110 Yard

Northern Shoreline

Open Green

Maritime Fields

Shipyard

Slipway 4  
(crane plaza + keel park)

0 20 50 100ft







**SEPTEMBER** master plan  
09/2013

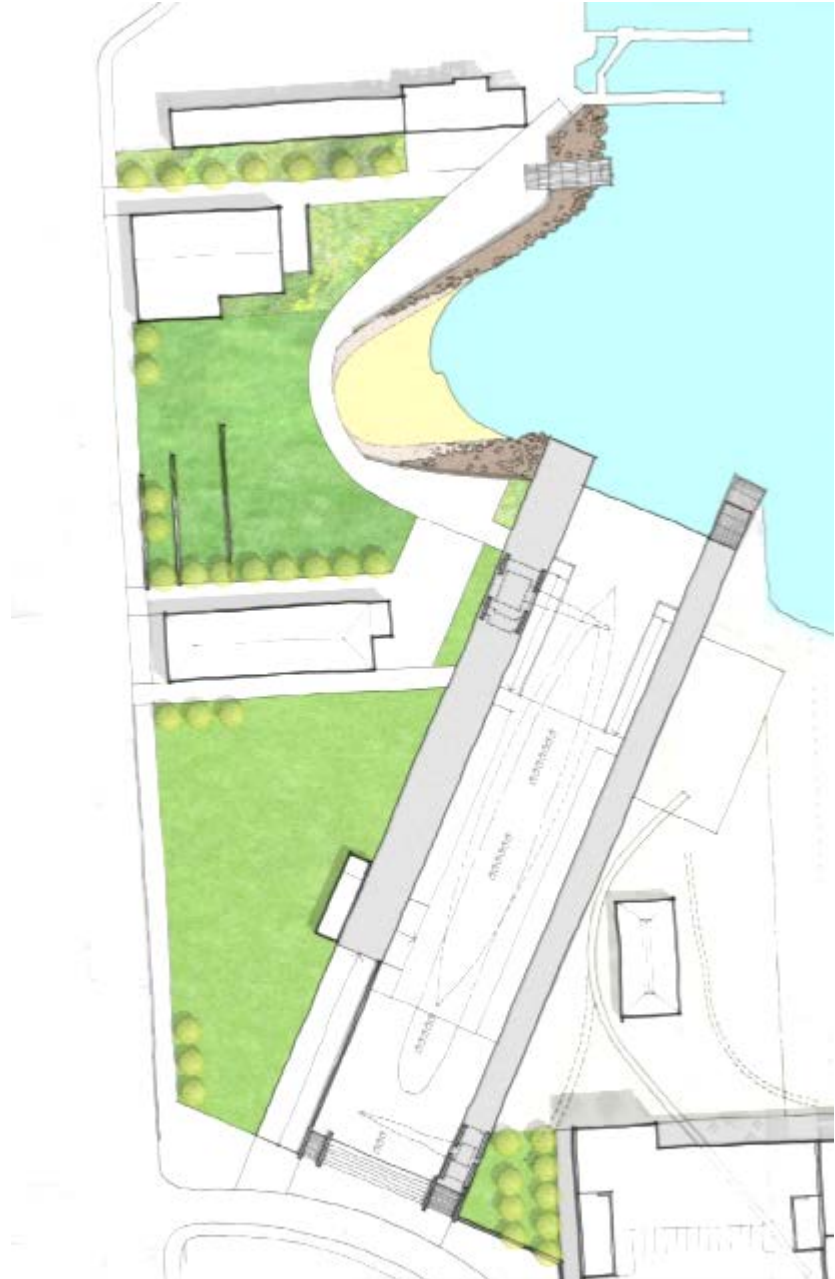

**DECEMBER** master plan  
12/2013

SEPTEMBER crane plaza  
09/2013

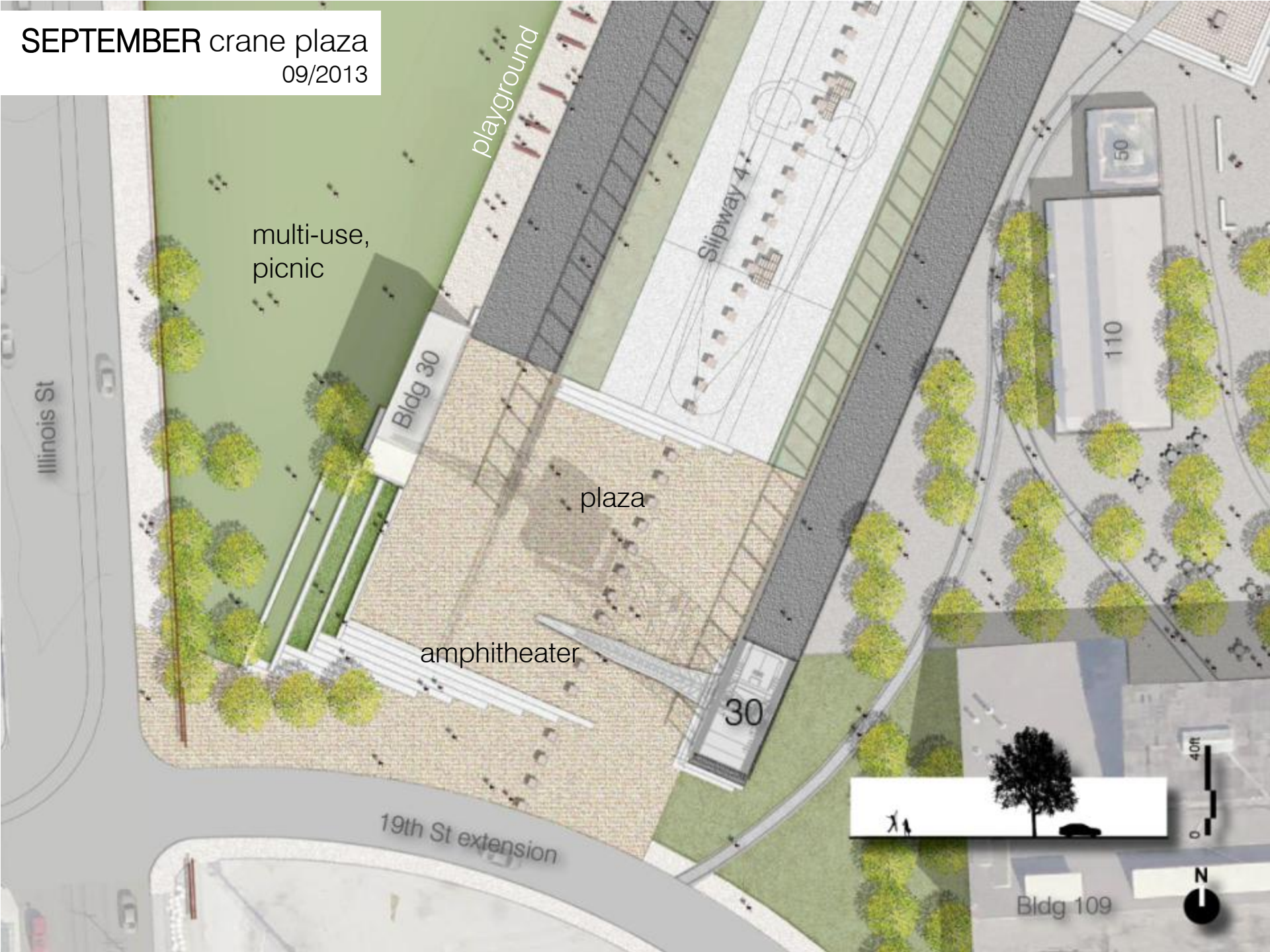

Illinois St

multi-use,  
picnic

playground

Bldg 30

plaza

amphitheater

Slipway 4

30

110

50

19th St extension

Bldg 109

40ft  
0

N



# SEPTEMBER crane plaza

09/2013

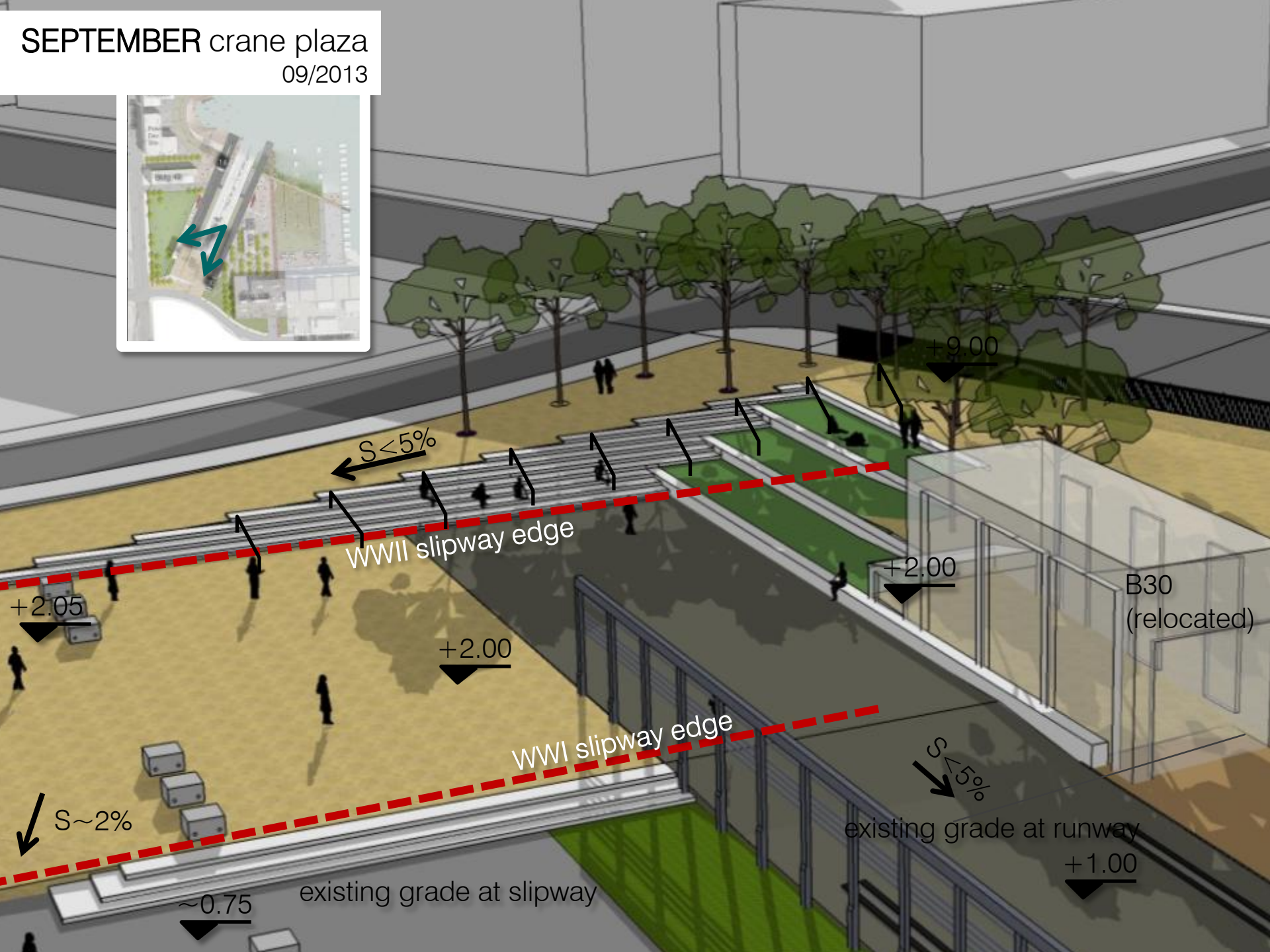

SEPTEMBER crane plaza  
09/2013







SEPTEMBER crane plaza  
09/2013

DECEMBER crane plaza  
12/2013





DECEMBER crane plaza  
12/2013



Illinois St

multi-use,  
picnic

Bldg 30

ramp

Slipway 4

50

110

preserved slipway

30

grand stair + amphitheater

19th St extension

Bldg 109

40ft  
0

N

# DECEMBER crane plaza

12/2013

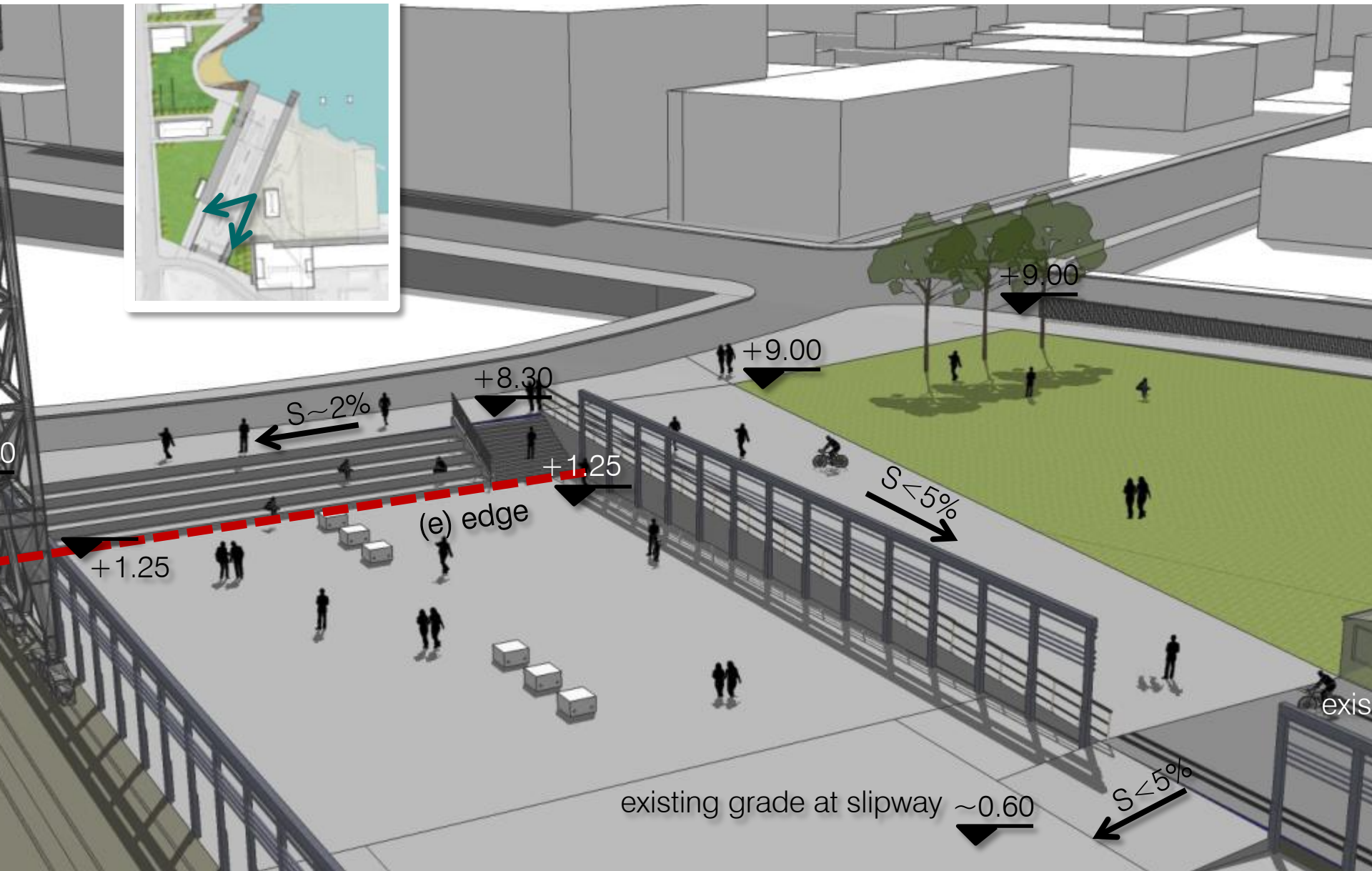



DECEMBER crane plaza  
12/2013

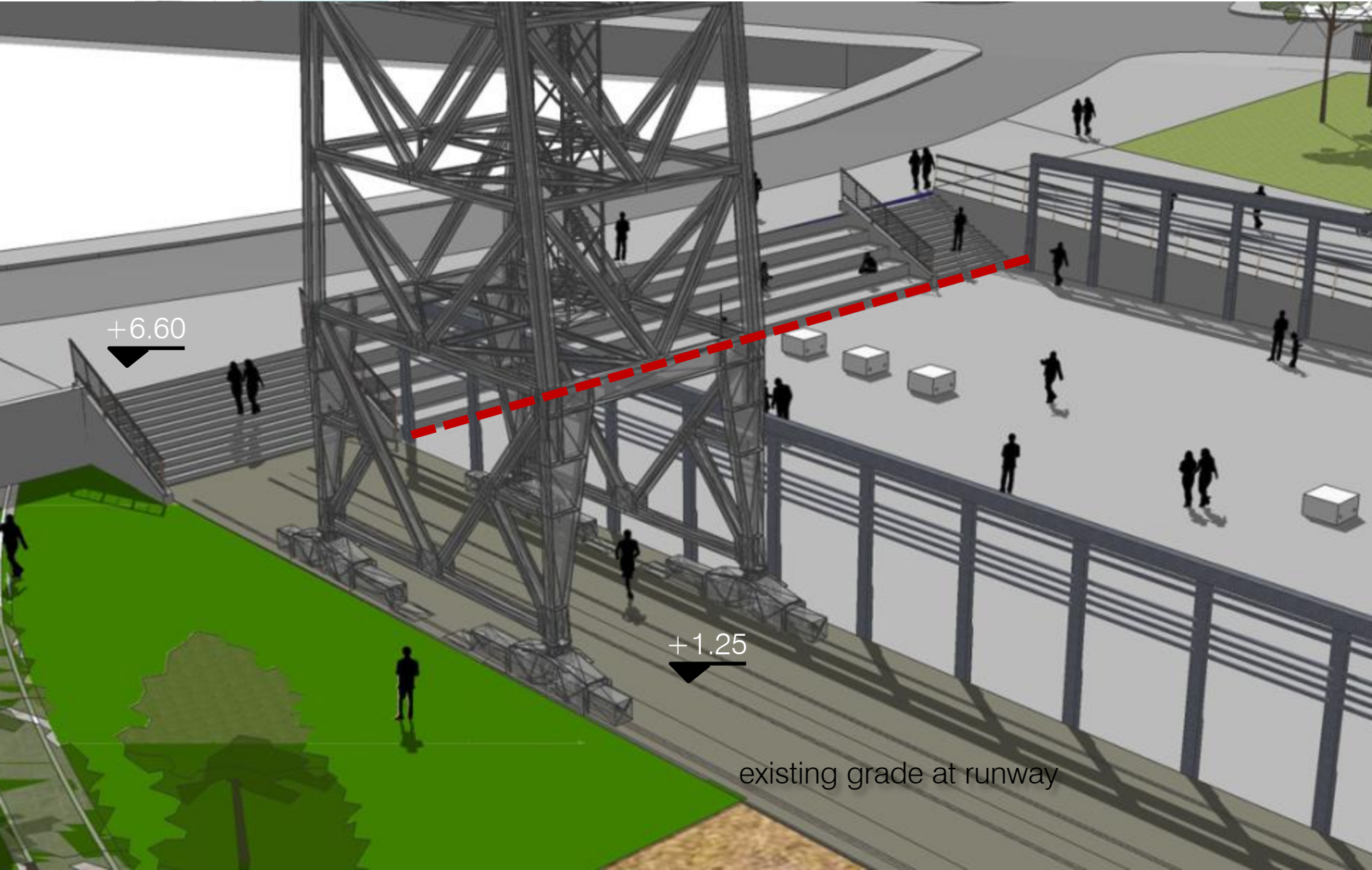

+6.60

+1.25

existing grade at runway

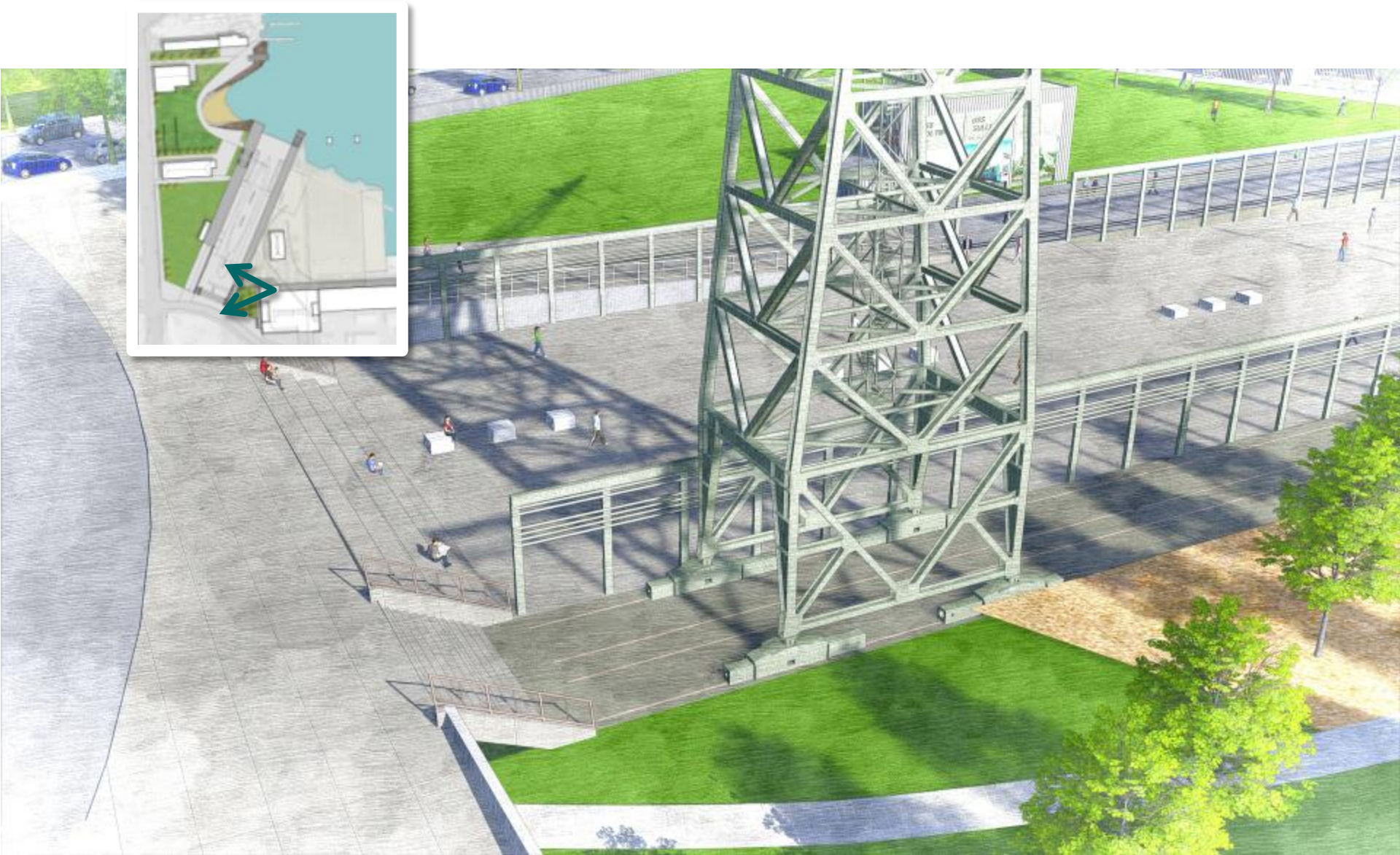

DECEMBER preserved slipway  
12/2013



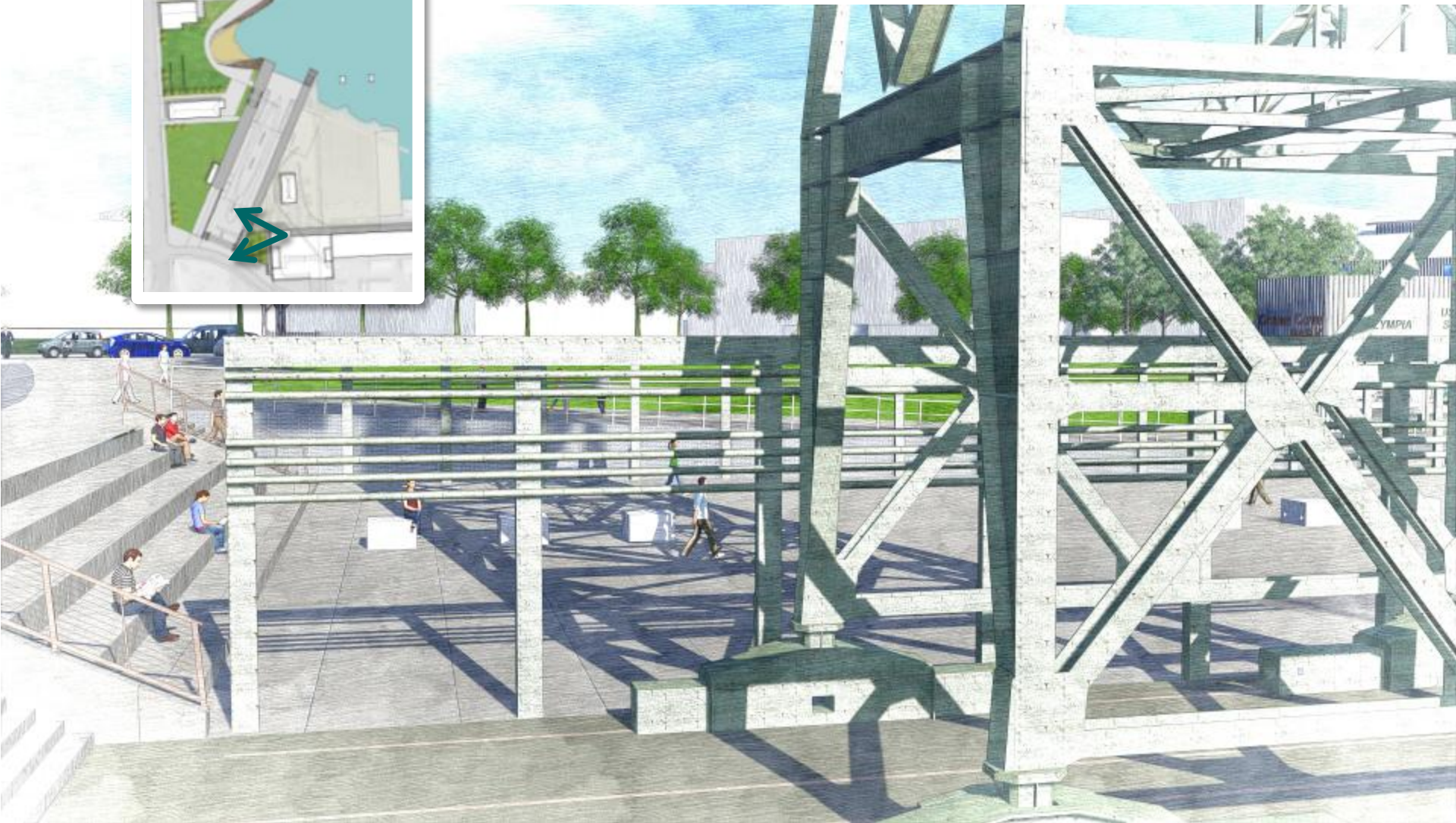

DECEMBER preserved slipway  
12/2013



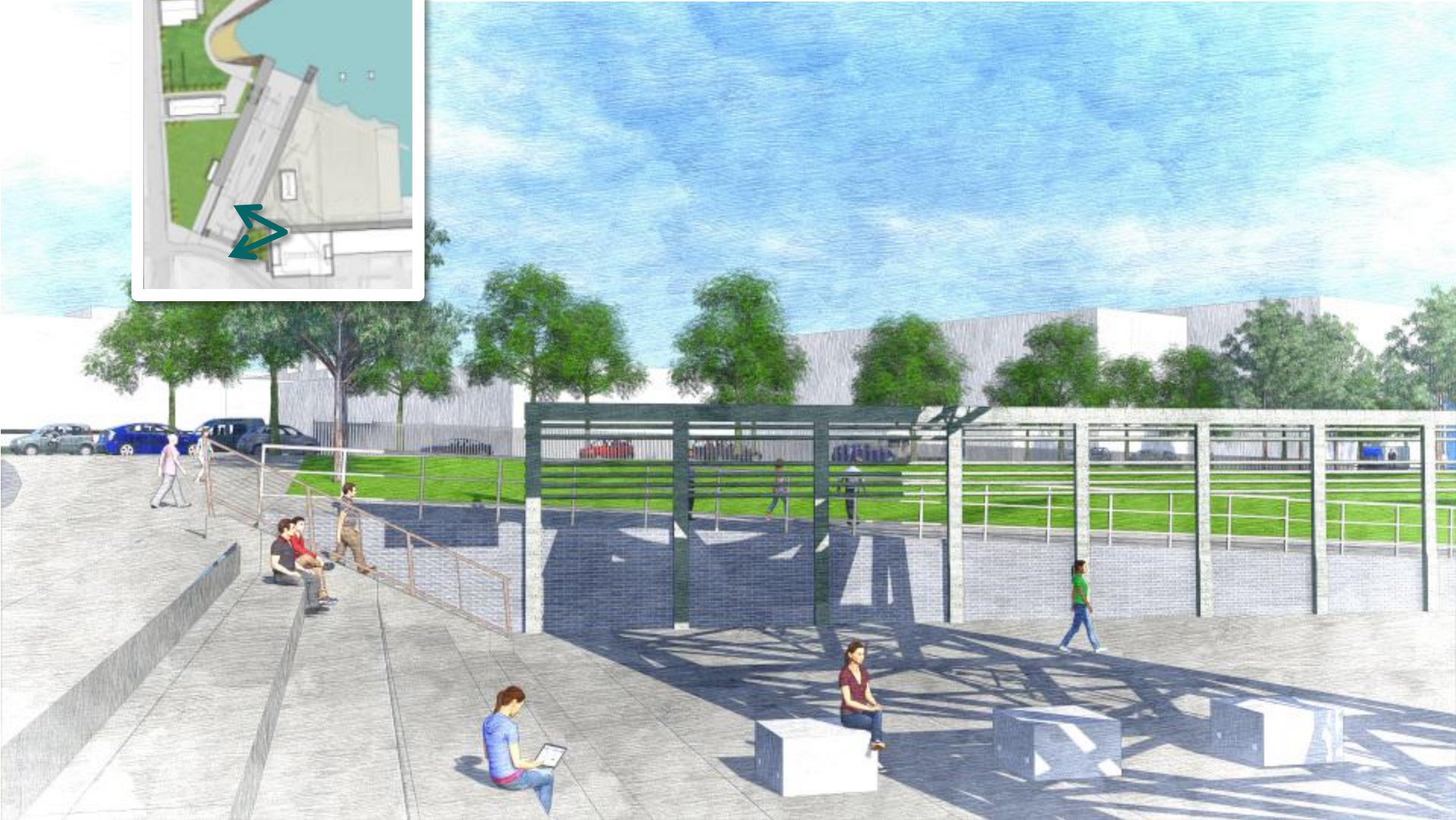

DECEMBER preserved slipway  
12/2013



# circulation

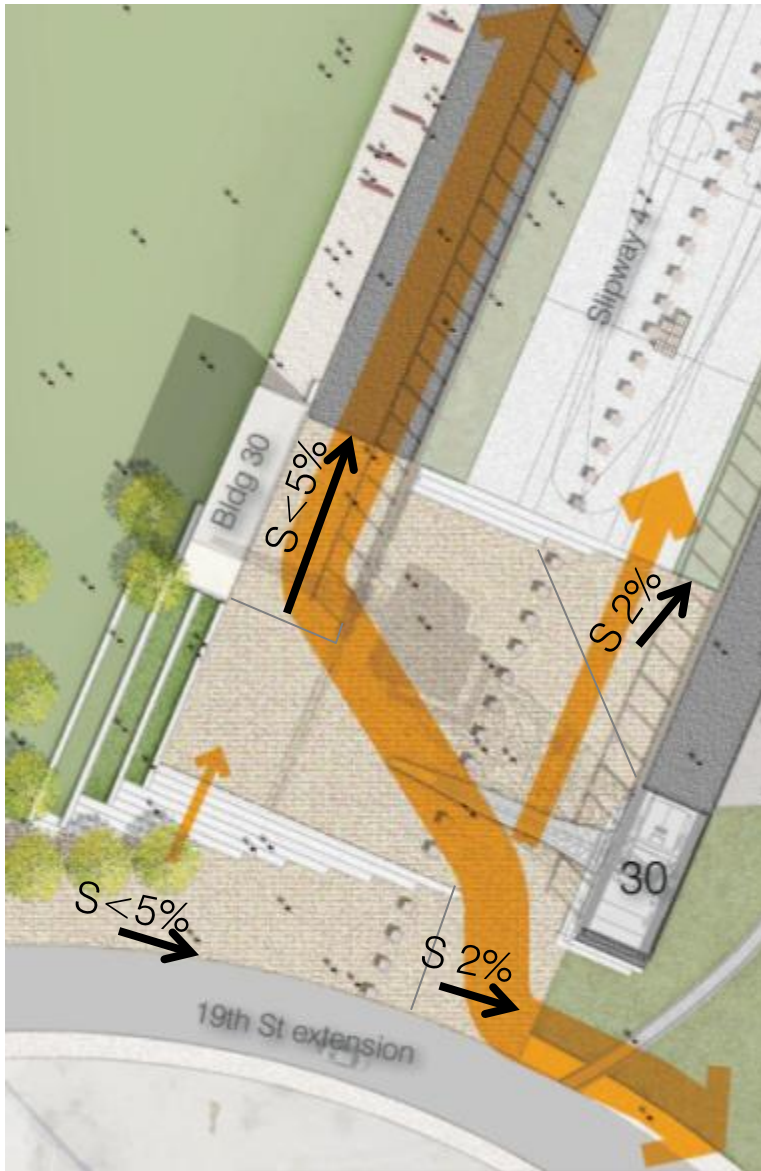

SEPTEMBER master plan  
09/2013

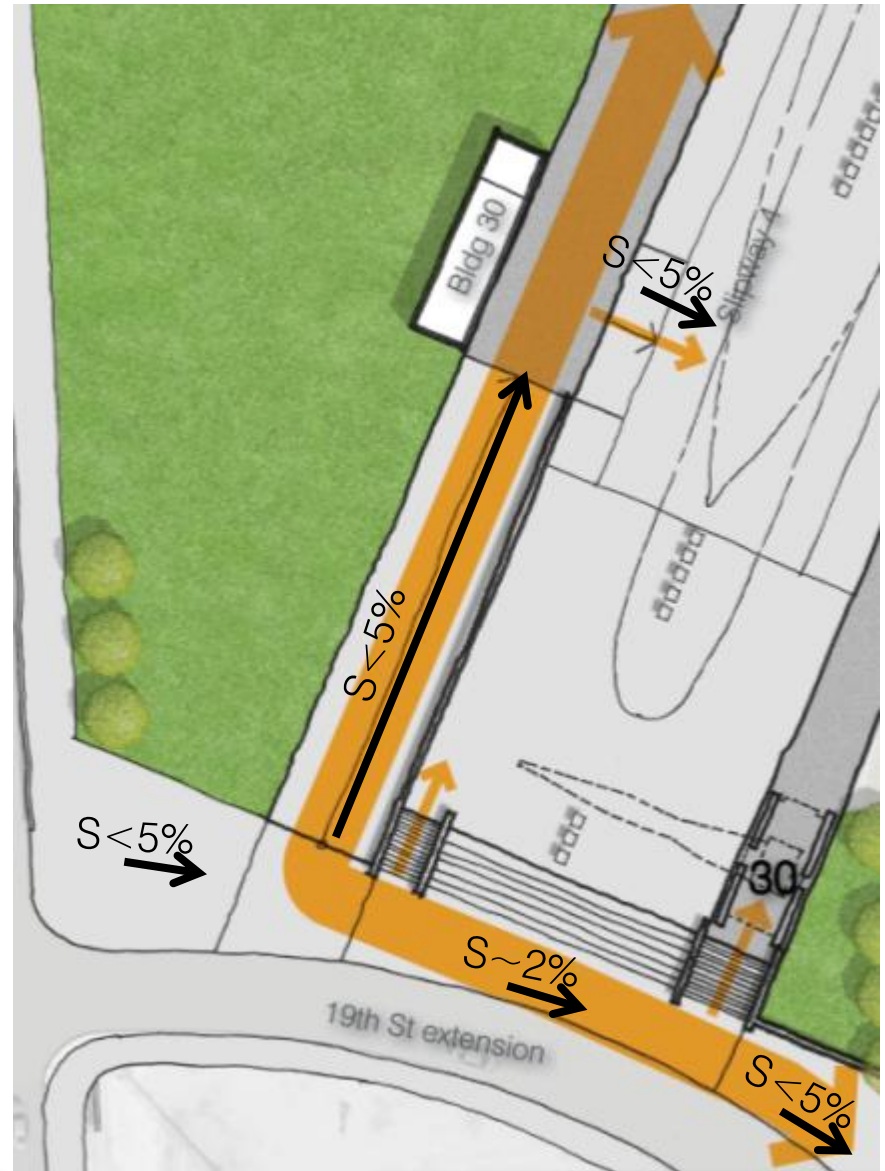

DECEMBER master plan  
12/2013

# programming : small event

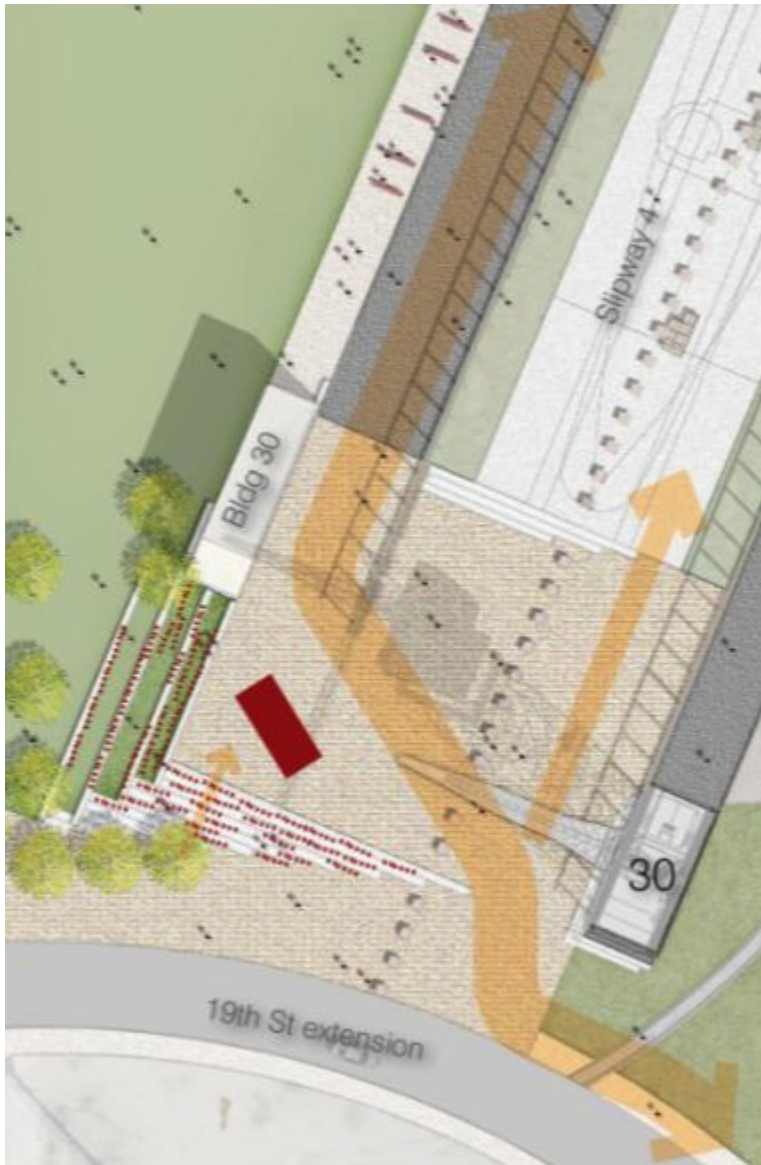

SEPTEMBER master plan  
09/2013



DECEMBER master plan  
12/2013



# programming : medium event

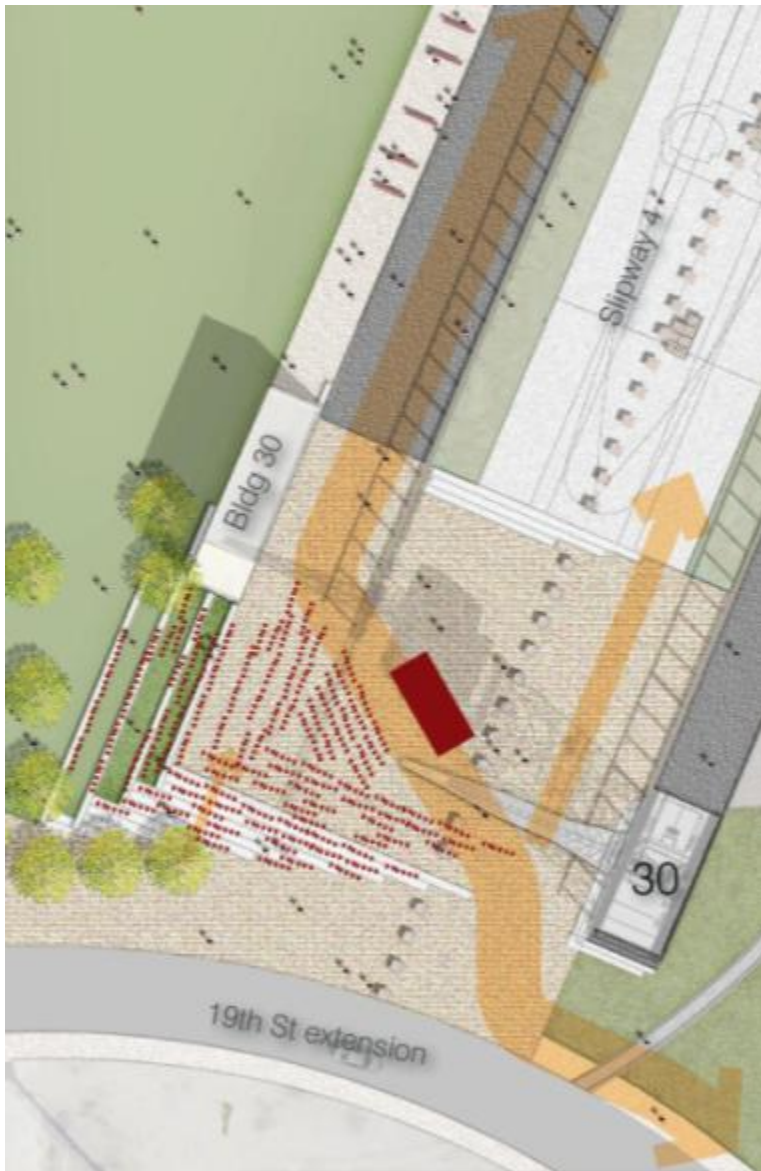

SEPTEMBER master plan  
09/2013



DECEMBER master plan  
12/2013

# programming : large event

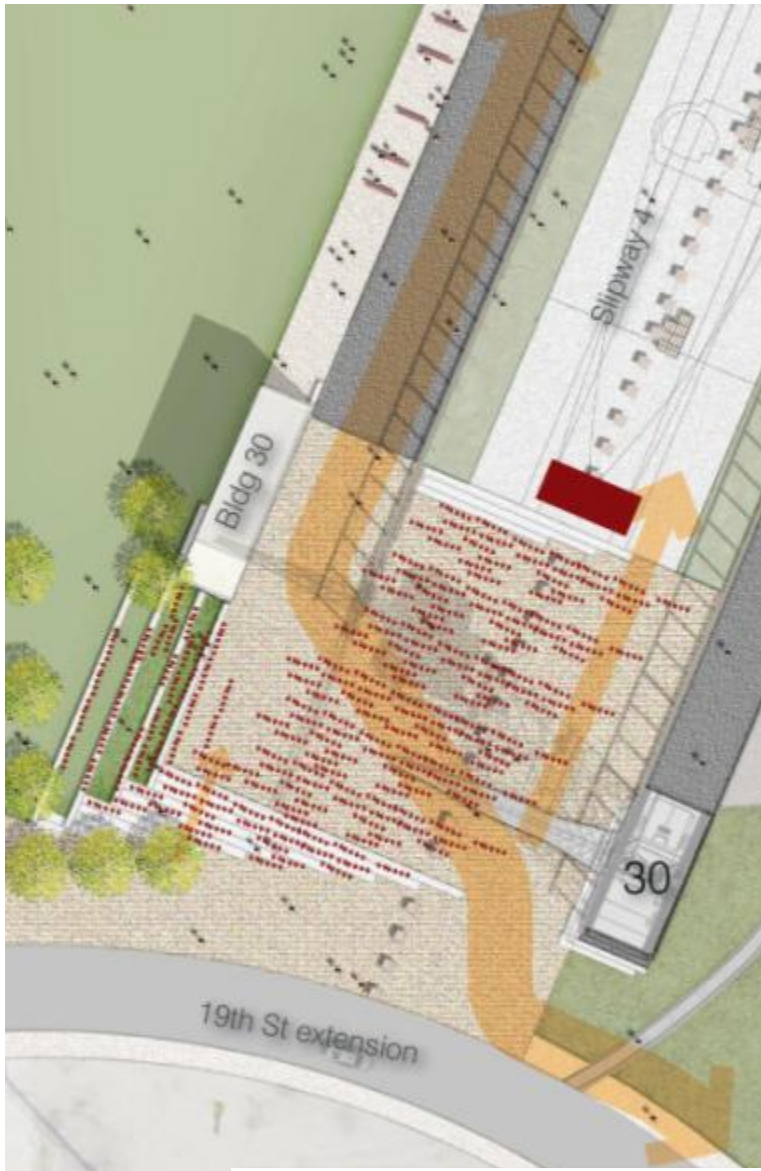

SEPTEMBER master plan  
09/2013



DECEMBER master plan  
12/2013



# programming : food trucks / farmer's market

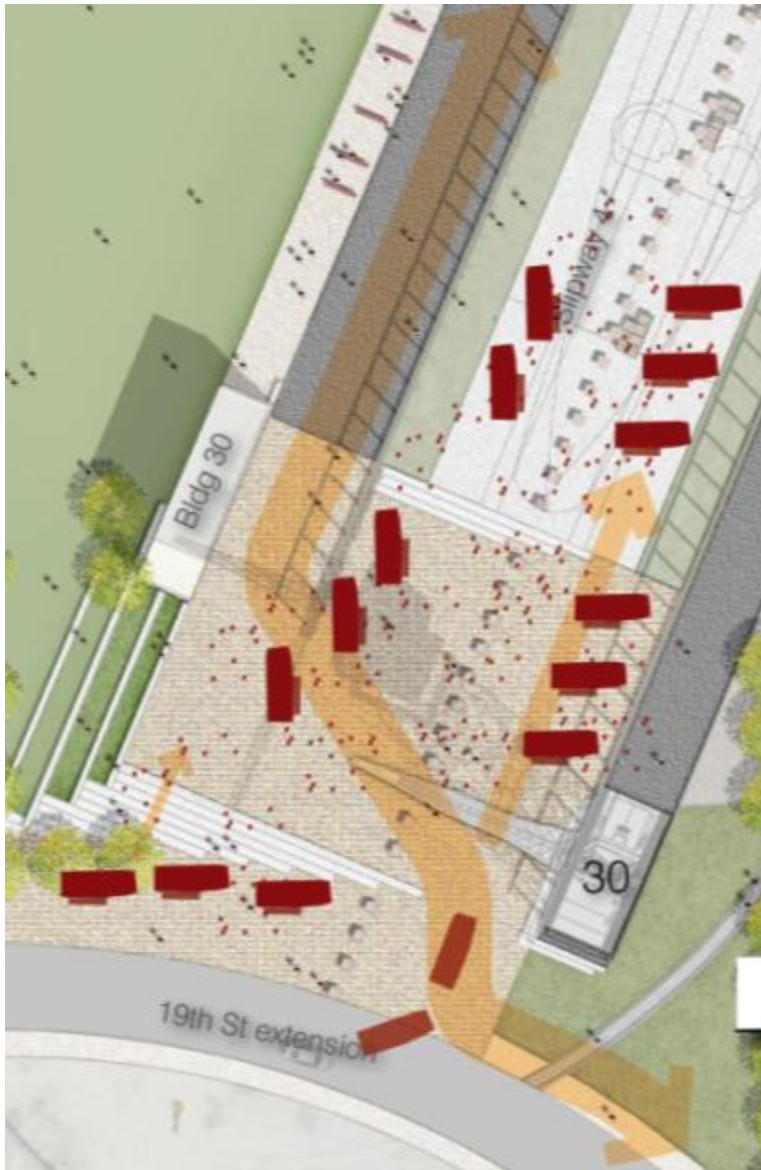

SEPTEMBER master plan  
09/2013



DECEMBER master plan  
12/2013

SEPTEMBER crane plaza  
09/2013



DECEMBER crane plaza  
12/2013





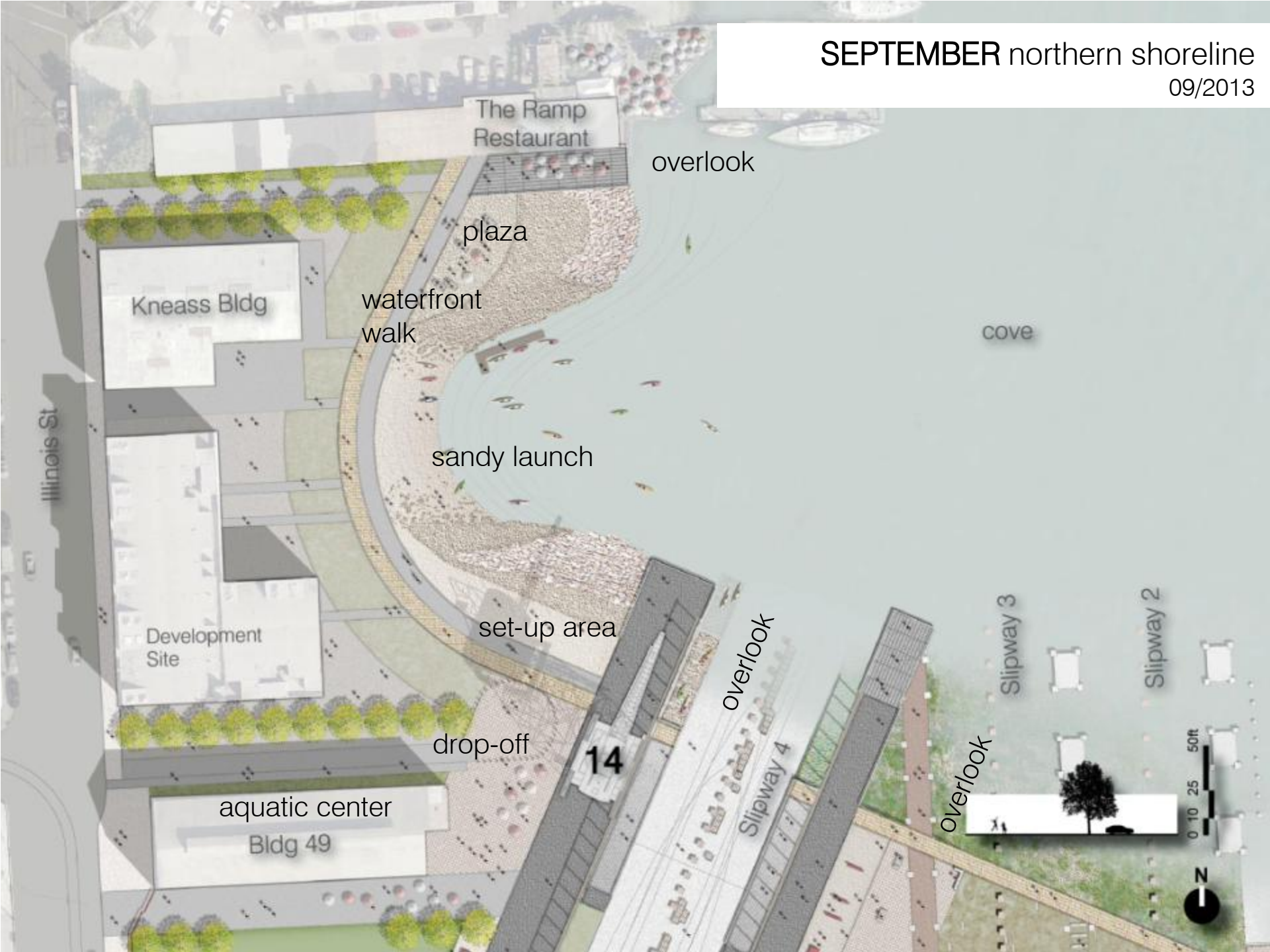

The Ramp Restaurant

overlook

plaza

Kneass Bldg

waterfront walk

cove

sandy launch

Illinois St

Development Site

set-up area

overlook

Slipway 3

Slipway 2

drop-off

14

Slipway 4

overlook

aquatic center

Bldg 49

0 10 25 50R



Illinois St

The Ramp  
Restaurant

The Ramp  
"patio"

overlook

plaza

cove

waterfront  
walk

110'

sandy launch

95'

set-up  
area

overlook

Slipway 3

Slipway 2

drop-off

14

Slipway 4

aquatic  
center

Bldg 49

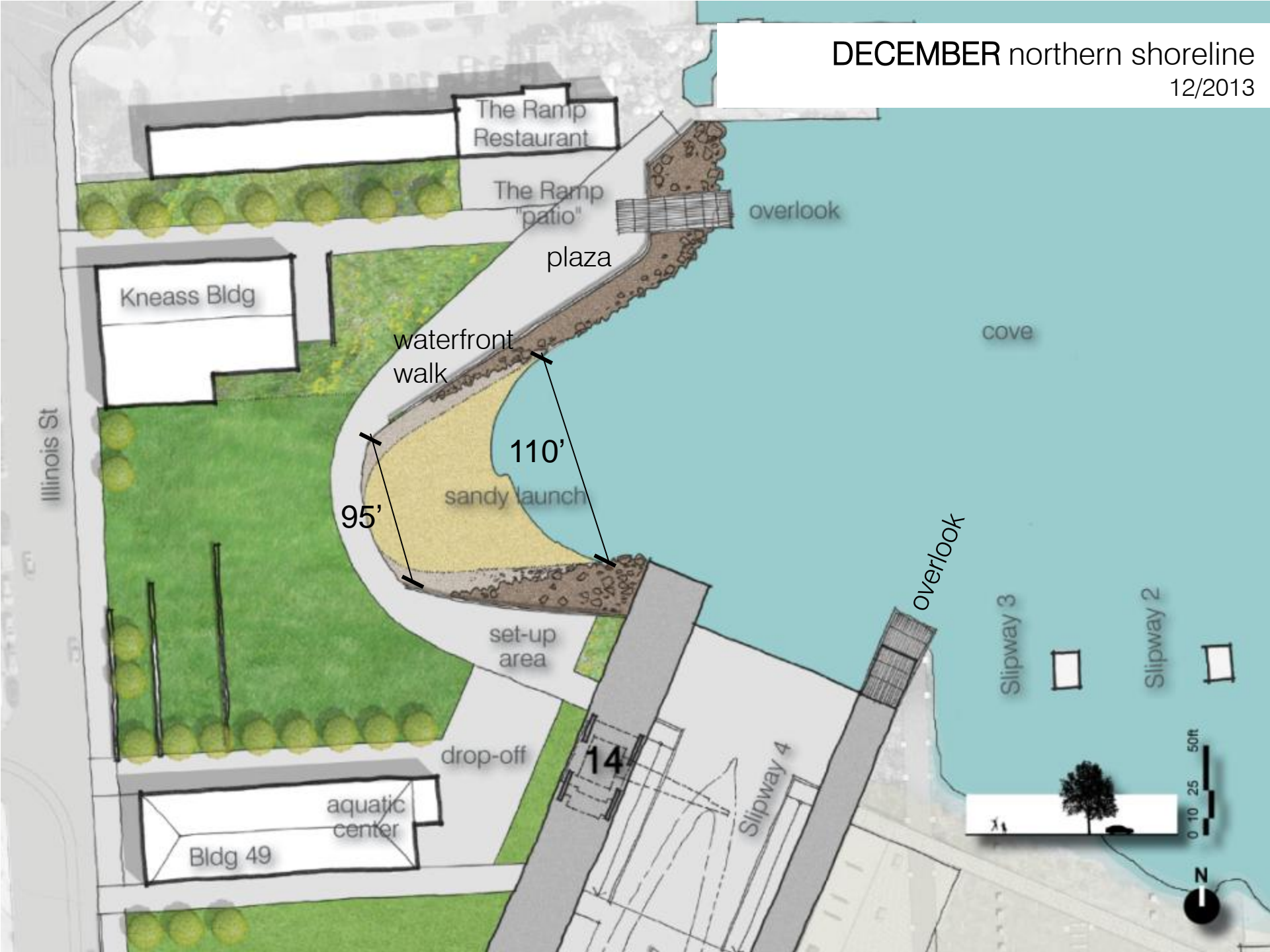
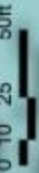



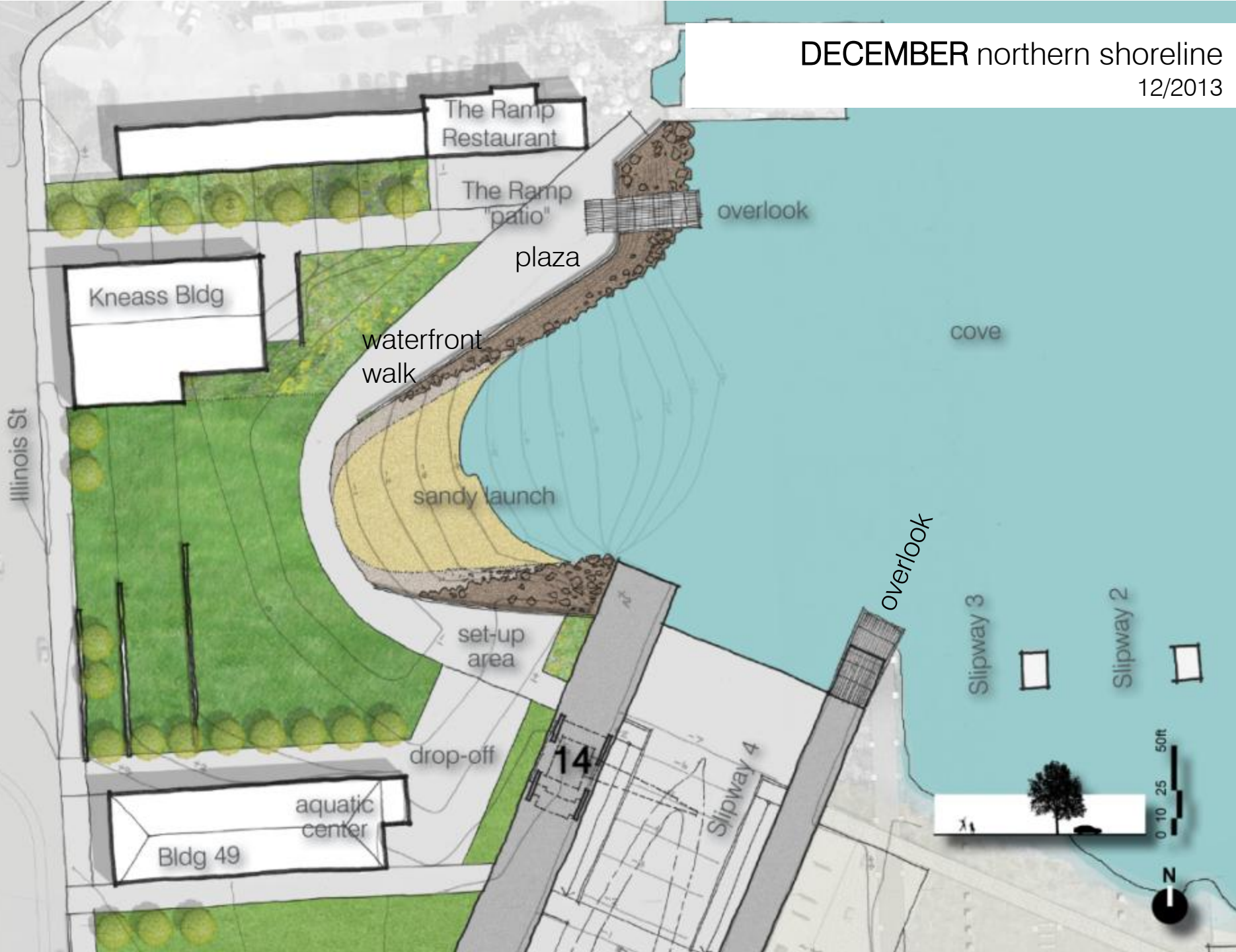

The Ramp  
Restaurant

The Ramp  
"patio"

overlook

plaza

waterfront  
walk

cove

sandy launch

overlook

set-up  
area

Slipway 3

Slipway 2

drop-off

14

Slipway 4

aquatic  
center

Bldg 49

0 10 25 50R

N

Illinois St

Kneass Bldg

DECEMBER northern shoreline  
12/2013





DECEMBER northern shoreline  
12/2013





# circulation

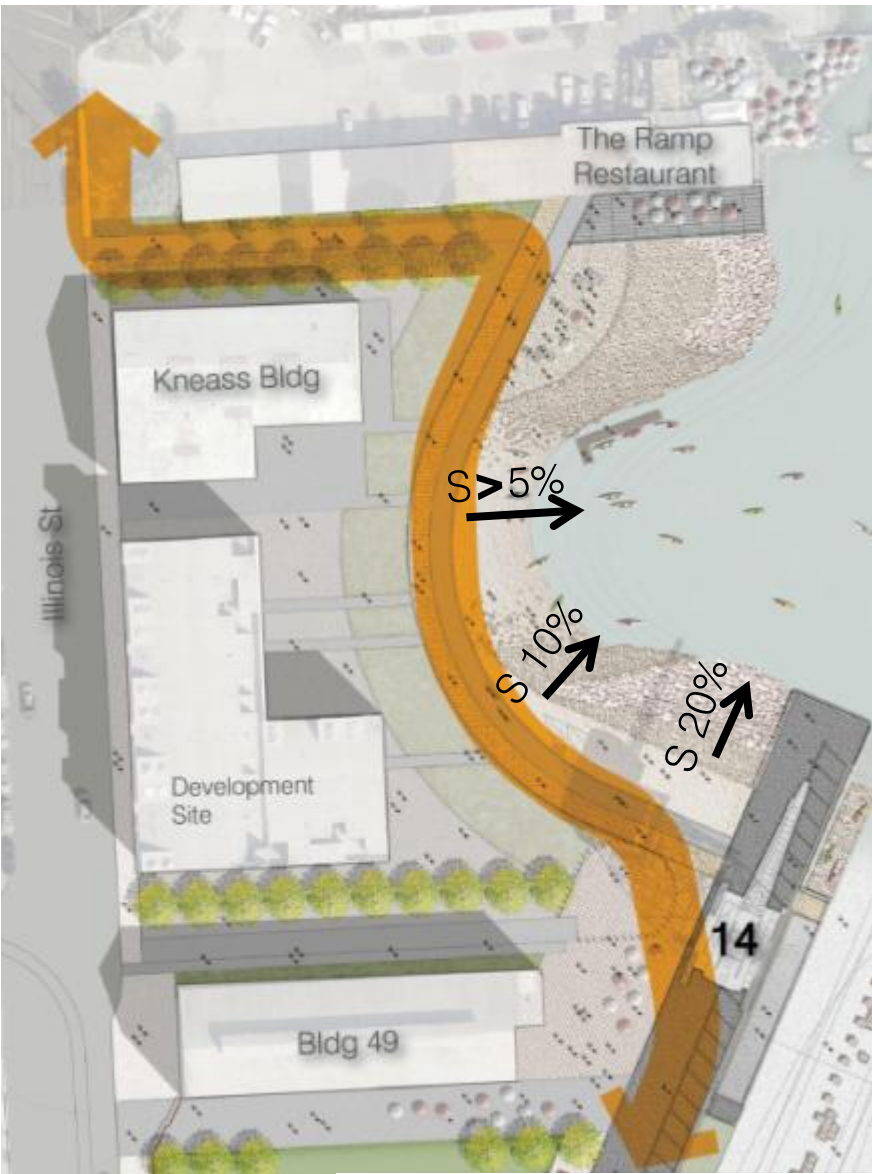

SEPTEMBER master plan  
09/2013

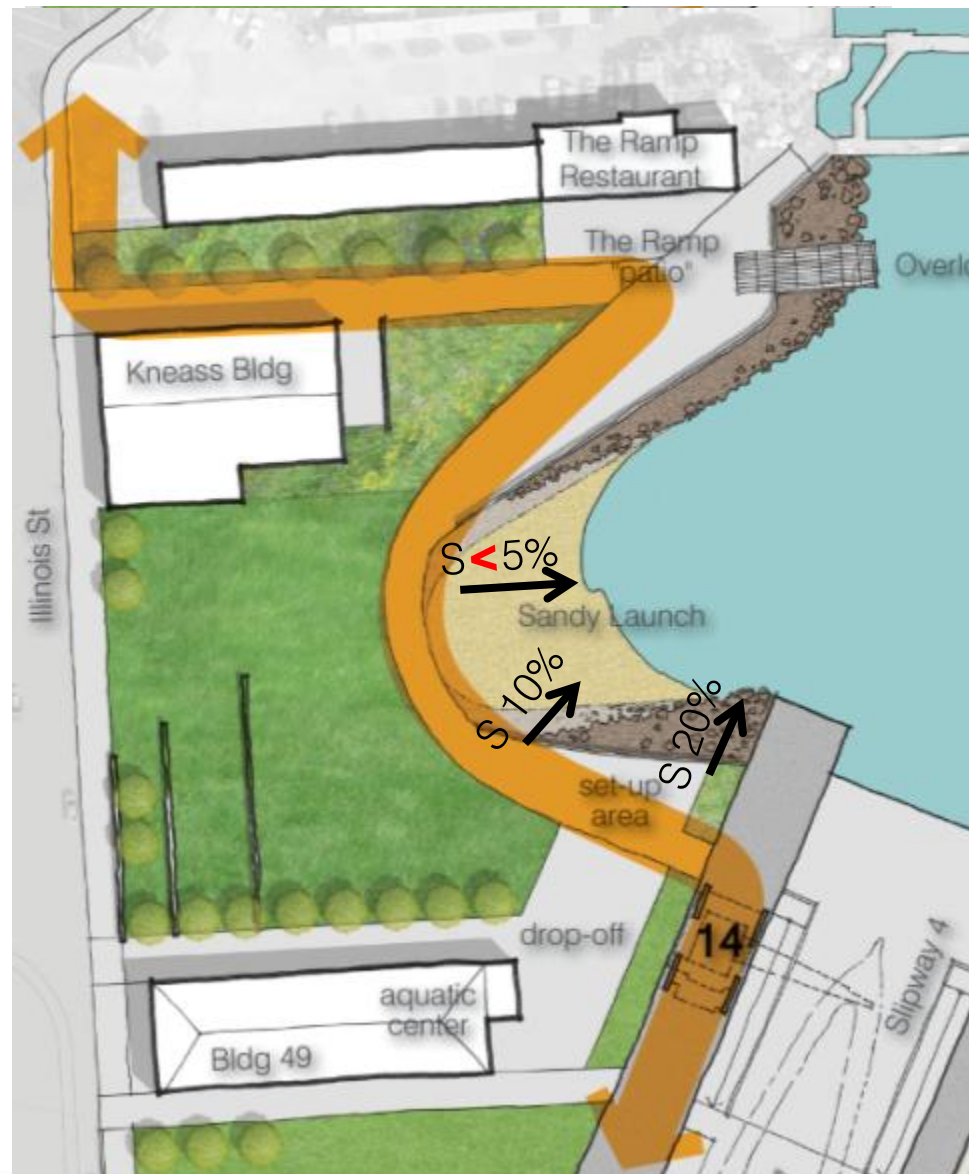

DECEMBER master plan  
12/2013



ADDITIONAL STUDY  
northern shoreline  
12/2013

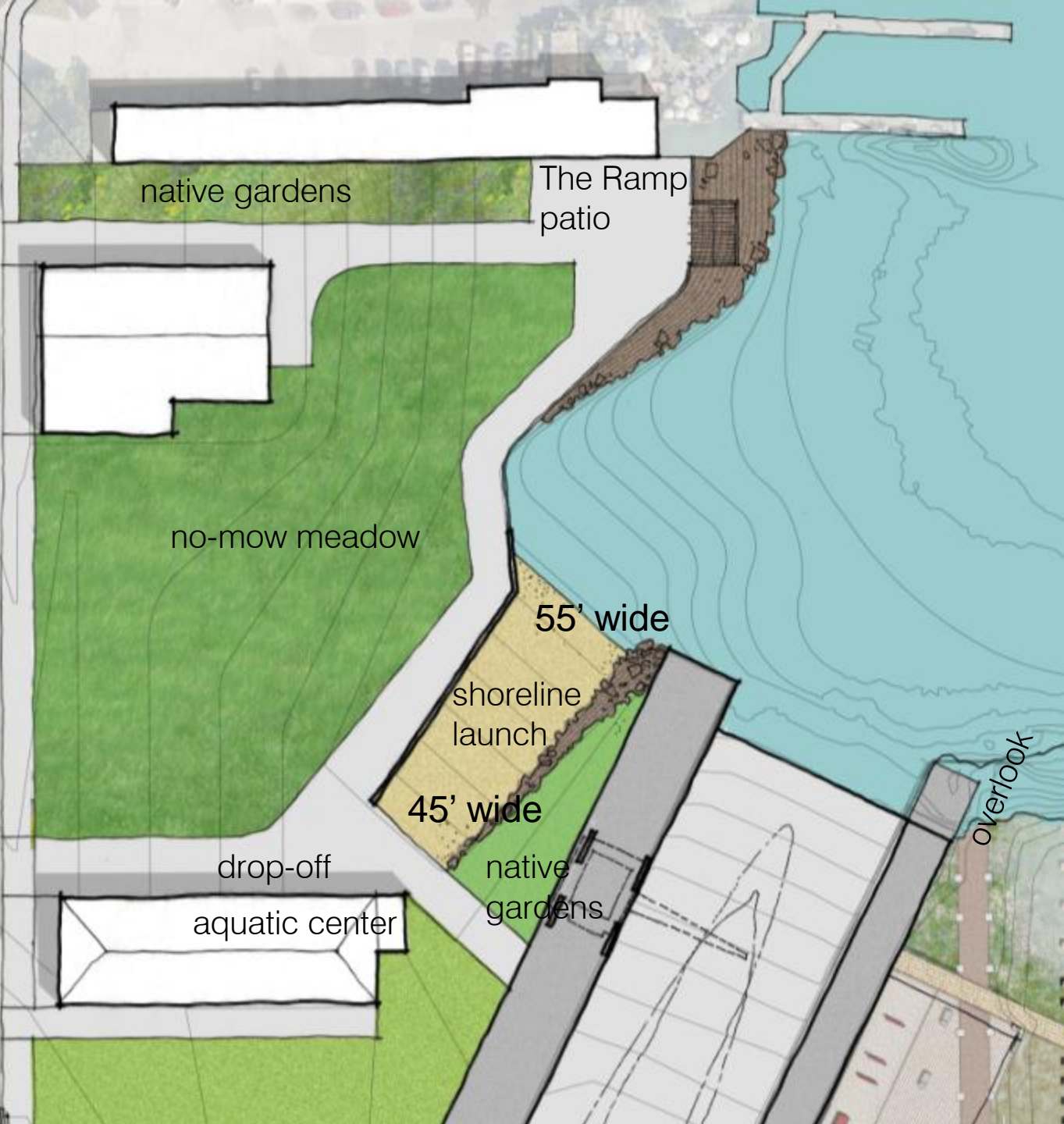





**DECEMBER** master plan  
12/2013



The Ramp

Kneass

Northern Shoreline

Third St

Illinois St

18th St

Bldg 49

14

Open Green

Maritime Fields

Shipyard

19th St

B 310

Slipway A

B 110 B 50

30

Bldg 109

Slipway 4  
(crane plaza + keel park)

109+110 Yard

19th St extension



# phasing



SEPTEMBER master plan  
09/2013



DECEMBER master plan  
12/2013



- 
- ✓ finalize master plan, cost estimate & phasing  
(Jan 14)
  - ✓ begin schematic design (SD), SD review, revise cost estimates  
( Feb 14- May14)
  - ✓ begin detail design (DD), DD review, revise cost estimates  
(Jun 14 – Dec 14)
  - ✓ bid & award construction- begin construction  
(Jan 15-Jun15)

next steps