

BASIS OF SURVEY: PROJECT DATUMS, REFERENCE SYSTEMS & PROJECTION
 Datum: North American Datum of 1983: NAD83 (2011) 2010.00 Epoch
 Reference Network: "CCSF-2013 HPN" (High Precision Network per Record of Survey #8080)

Projection: Plane coordinates are based on a local grid coordinate system known as the City & County of San Francisco 2013 Coordinate System (CCSF-CS13). CCSF-CS13 is a low distortion Transverse Mercator Projection. Within the City, the combined grid factor is generally less than 1/100,000. The origin of coordinates and central meridian are located near the center of the City. See Record of Survey #8080 recorded in Book EE of Survey Maps, Page 147-157, S.F.C.R. and the CCSF PW Web Site (<http://sfpublicworks.org/ccsf-geodetic-network>) for projection parameters.

Horizontal Control: The horizontal datum was recovered based on a GPS calibration to HPN or HPND points 331 and 338.

Vertical Datum: "CCSF 2013 NAVD88 Vertical Datum" (CCSF-VD13).

Reference Network: CCSF 2013 High Precision Leveling Network.

Vertical Control: The vertical datum was recovered based on benchmarks 11036 and 10253.

SURVEYOR'S STATEMENT

THE TOPOGRAPHIC SURVEY AS SHOWN HEREON WAS PREPARED UNDER MY DIRECT SUPERVISION, DURING THE MONTH OF JULY 2023, AND REPRESENTS THE SITE CONDITIONS AND ELEVATIONS AS FOUND ON THE DATE OF SURVEY.

 MENNOR CHAN, L.S. 8406

 DATE

PROPOSED POTHOLE LOCATIONS				
PT	NORTHING	EASTING	ELEV	DESCRIPTION
PH 1	77307.07	177599.17	9.65	AC @ PROPOSED LOCATION
PH 2	77217.45	176452.45	11.08	AC @ PROPOSED LOCATION
PH 3	77205.86	176280.42	10.67	AC @ PROPOSED LOCATION
PH 4	77225.33	176163.43	10.96	AC @ PROPOSED LOCATION
PH 5	77189.41	176091.37	10.69	AC @ PROPOSED LOCATION

LEGEND

- AREA SPOT ELEVATION x 32.15
- DRAIN/CATCH BASIN
- BUILDING
- TREE
- IRRIGATION CONTROL BOX
- IRRIGATION CONTROL VALVE
- BACK FLOW PREVENTER
- TRAFFIC CONTROL BOX
- COMMUNICATION BOX
- ELECTRIC METER BOX
- ELECTRICAL PULL BOX
- STREET LIGHT PULL BOX
- TRASH RECEPTACLE
- BOLLARD
- MAN HOLE COVER
- LIGHT POLE
- CHAIN LINK FENCE LINE
- GRADE BREAK LINE
- WATER LINE
- ELECTRICAL LINE
- STANITARY SEWER LINE
- STORM DRAIN LINE
- ASPHALT EDGE LINE
- CONCRETE EDGE LINE

ABBREVIATIONS

- AC = ASPHALT PAVEMENT
- AD = AREA DRAIN
- BOL = BOLLARD
- BLDG = BUILDING
- BW = BOTTOM OF WALL
- CB = CATCH BASIN
- CLF = CHAIN LINK FENCE
- CO = CLEAN OUT
- CONC = CONCRETE
- COM = COMMUNICATION
- DI = DRAINLET
- EL = ELEVATION
- EP = EDGE OF PAVEMENT
- FF = FINISHED FLOOR
- FH = FIRE HYDRANT
- GB = GRADE BREAK
- GM = GAS METER
- GV = GAS VALVE
- GVL = GAS VALVE
- GW = GUY WIRE
- ICB = IRRIGATION CONTROL BOX
- ICV = IRRIGATION CONTROL VALVE
- JP = JOINT POLE
- LP = LIGHT POLE
- MH = MANHOLE
- OG = ORIGINAL GROUND
- PB = PULL BOX
- PVC = POLYVINYL CHLORIDE PIPE
- PGE = PACIFIC GAS AND ELECTRIC
- SD = STORM DRAIN
- SDCO = STORM DRAIN CLEAN
- SDMH = STORM DRAIN MANHOLE
- SLB = STREET LIGHT PULL BOX
- SIGN = STOP SIGN / STREET SIGN
- SS = SANITARY SEWER
- SSC = SANITARY SEWER CLEAN
- SSMH = SANITARY SEWER MANHOLE
- TOC = TOP OF CURB
- TOE = TOE OF SLOPE
- TOP = TOP OF SLOPE
- TR = TRASH RECEPTACLE
- TW/TOW = TOP OF WALL
- WM = WATER METER
- WV = WATER VALVE

NO.	DATE	DESCRIPTION	BY	APP.
TABLE OF REVISIONS				
CHECK WITH TRACING TO SEE IF YOU HAVE LATEST REVISION				

CONSULTANT

TELAMON ENGINEERING CONSULTANTS INC.
 855 FOLSOM STREET, SUITE 142
 SAN FRANCISCO, CA 94107
 TEL: 415-837-1338 FAX: 415-837-1354

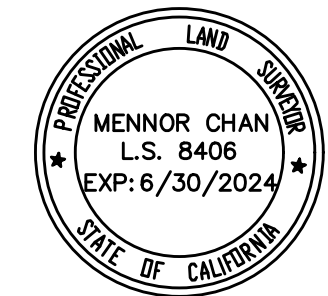

SAN FRANCISCO PORT COMMISSION

PORT OF SAN FRANCISCO

DEPARTMENT OF ENGINEERING



DESIGNED: DATE:	APPROVED BY:
DRAWN: DATE:	SAN FRANCISCO PORT COMMISSION
A. MINSK 10/17/23	DATE: _____
CHECKED: DATE:	CHIEF HARBOR ENGINEER
P. DE COSTA 10/17/23	

AMADOR STREET POTHOLES

COVER PAGE

CONTRACT NO.
DRAWING NO.
V101
SHEET NO.
1 OF 2



NO.	DATE	DESCRIPTION	BY	APP.
TABLE OF REVISIONS				
CHECK WITH TRACING TO SEE IF YOU HAVE LATEST REVISION				

CONSULTANT
TELAMON ENGINEERING CONSULTANTS INC.
 855 FOLSOM STREET, SUITE 142
 SAN FRANCISCO, CA 94107
 TEL: 415-837-1338 FAX: 415-837-1354

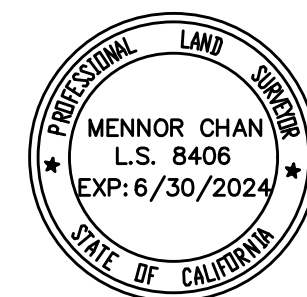

SAN FRANCISCO PORT COMMISSION
PORT OF SAN FRANCISCO
 DEPARTMENT OF ENGINEERING

DESIGNED: DATE:
 DRAWN: DATE:
 A. MINSK 10/17/23
 CHECKED: DATE:
 P. DECOSTA 10/17/23

APPROVED BY
 SAN FRANCISCO PORT COMMISSION
 DATE: _____

 CHIEF HARBOR ENGINEER

AMADOR STREET POTHOLING
TOPOGRAPHIC SURVEY

CONTRACT NO.
 DRAWING NO.
 V102
 SHEET NO.
 2 OF 2



Telamon Engineering Potholing Report

8/21/2023

8/22/2023

EXARO Technologies Corporation

1831 Bayshore Highway

Burlingame, California

Mario Lopez

Office (650)777-4324

Cell: (408)221-5090

mle@exarotec.com

Date:	8/22/2023
Prepared For:	Telamon Engineering
Project #:	21-1097
Location:	San Francisco



PH #	Street	Cut Size	Asph	Conc.	Soil	Utility	Utility Size	Material	Depth	Location Reference / Notes
2	600 Amador St	1' x 1'	3"		Dirt, Rocks	Telephone	4"	PVC	27"	72" S from edge of gutter. 212" W from telephone pole.
1	429 Amador St	1' x 1'	5"		Dirt, Rocks	Gas	4"	Steel	39"	123" E from water valve., 126" S from sanitary sewer manhole.
										Paved 5 - 12" T-Cut locations.
Foreman	Chris Dancel			Add'l Crew/Flagger		Luis M		Standby Rep		
Technician	Candido G			Add'l Crew/Flagger		Gil Z		Client Rep		
Timesheet	Date	Start/End	Hours	OT	Night Stay	Check	Check	Additional Equipment/Material used:		
Monday		/				Arrow Board <input type="checkbox"/>	Electronic Detector <input type="checkbox"/>			
Tuesday	8/22/2023	6/2				Cold patch <input type="checkbox"/>	GPR <input type="checkbox"/>			
Wednesday		/				Class II <input type="checkbox"/>	Pk nails & shiners <input checked="" type="checkbox"/>			
Thursday		/				Hotmix Aspht <input checked="" type="checkbox"/>	Vibra-plate <input checked="" type="checkbox"/>	Field Changes or Special Requests from Client Representative:		
Friday		/				CDF/slurry <input type="checkbox"/>	Flat bed# 29 <input checked="" type="checkbox"/>			
Saturday		/				Ready-mix conc <input type="checkbox"/>	Pick-up truck # <input type="checkbox"/>			
Sunday		/				Cutback <input type="checkbox"/>	Vac rig # 9 <input checked="" type="checkbox"/>	Client Representative Signature:		

Subsurface Utility Report	
Client	Telamon Engineering
Project #	21-1097
City	San Francisco
Date	8/22/2023



Pothole # 1

Street: 429 Amador St

<p>Cut Size: 1' x 1'</p> <p>Asphalt: 5"</p> <p>Concrete:</p> <p>Depth: 39"</p> <p>Utility: Gas</p> <p>Size: 4"</p> <p>Material: Steel</p> <p>Soil: Dirt, Rocks</p>		<p>Location: 123" E from water valve, 126" S from sanitary sewer manhole.</p> <p>Notes:</p>
--	--	---



~ Delivering Excellence with a Sense of Urgency ~™

Subsurface Utility Report	
Client	Telamon Engineering
Project #	21-1097
City	San Francisco
Date	8/22/2023



Pothole # 2

Street: 600 Amador St

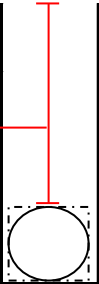
<p>Cut Size: 1' x 1'</p> <p>Asphalt: 3"</p> <p>Concrete:</p> <p>Depth: 27"</p> <p>Utility: Telephone</p> <p>Size: 4"</p> <p>Material: PVC</p> <p>Soil: Dirt, Rocks</p> 		<p>Location: 72" S from edge of gutter. 212" W from telephone pole.</p> <p>Notes:</p>
---	--	---



Date:	8/21/2023
Prepared For:	Telamon Engineering
Project #:	21-1097
Location:	San Francisco



PH #	Street	Cut Size	Asph	Conc.	Soil	Utility	Utility Size	Material	Depth	Location Reference / Notes
5	701 Amador St	1' x 1'	2"		Clay, Rock	AT&T	Duct	Concrete	32"	70" S from edge of gutter. 32" E from sewer manhole.
5 (2nd)	701 Amador St	1' x 1'	2"		Clay, Rock	Electric	6"	PVC	39"	70" S from edge of gutter. 32" E from sewer manhole.
4	701 Amador St	1' X 1'	6"		Clay, Rock	Electric			Dry Hole	Cleared 5'. 145" S from edge of gutter. 145" E for storm drain grate.
3	701 Amador St	1' x 1'	6"		Clay, Rock	Fiber Optic	2"	PVC	21"	55" S from edge of gutter. 60" W from storm drain grate.
3 (2nd)	701 Amador St	1' x 1'	6"		Clay, Rock	Electric	4"	PVC	35"	55" S from edge of gutter. 60" W from storm drain grate.
Foreman	Chris Dancel			Add'l Crew/Flagger					Standby Rep	
Technician	Gilberto Z			Add'l Crew/Flagger					Client Rep	
Timesheet	Date	Start/End	Hours	OT	Night Stay	Check	Check	Additional Equipment/Material used:		
Monday	8/21/2023	6/2	8			Arrow Board <input type="checkbox"/>	Electronic Detector <input type="checkbox"/>			
Tuesday		/				Cold patch <input type="checkbox"/>	GPR <input type="checkbox"/>			
Wednesday		/				Class II <input checked="" type="checkbox"/>	Pk nails & shiners <input checked="" type="checkbox"/>			
Thursday		/				Hotmix Aspht <input type="checkbox"/>	Vibra-plate <input type="checkbox"/>	Field Changes or Special Requests from Client Representative:		
Friday		/				CDF/slurry <input type="checkbox"/>	Flat bed <input type="checkbox"/>			
Saturday		/				Ready-mix conc <input type="checkbox"/>	Pick-up truck # <input type="checkbox"/>			
Sunday		/				Cutback <input checked="" type="checkbox"/>	Vac rig # 9 <input checked="" type="checkbox"/>	Client Representative Signature:		

Subsurface Utility Report	
Client	Telamon Engineering
Project #	21-1097
City	San Francisco
Date	8/21/2023



Pothole # 3

Street: 701 Amador St

<p>Cut Size: 1' x 1'</p> <p>Asphalt: 6"</p> <p>Concrete:</p> <p>Depth: 21"</p> <p>Utility: Fiber Optic</p> <p>Size: 2"</p> <p>Material: PVC</p> <p>Soil: Clay, Rock</p>		<p>Location: 55" S from edge of gutter. 60" W from storm drain grate.</p> <p>Notes:</p>
---	--	---



~ Delivering Excellence with a Sense of Urgency ~™

Subsurface Utility Report	
Client	Telamon Engineering
Project #	21-1097
City	San Francisco
Date	8/21/2023



Pothole # 3 (2nd)

Street: 701 Amador St

<p>Cut Size: 1' x 1'</p>			<p>Location: 55" S from edge of gutter. 60" W from storm drain grate.</p>
<p>Asphalt: 6"</p> <p>Concrete:</p> <p>Depth: 35"</p> <p>Utility: Electric</p> <p>Size: 4"</p> <p>Material: PVC</p> <p>Soil: Clay, Rock</p>	<p>Notes:</p>		



~ Delivering Excellence with a Sense of Urgency ~™

Subsurface Utility Report	
Client	Telamon Engineering
Project #	21-1097
City	San Francisco
Date	8/21/2023



Pothole # 4

Street: 701 Amador St

<p>Cut Size: 1' X 1'</p> <p>Asphalt: 6"</p> <p>Concrete:</p> <p>Depth: Dry Hole</p> <p>Utility: Electric</p> <p>Size:</p> <p>Material:</p> <p>Soil: Clay, Rock</p>		<p>Location: Cleared 5'. 145" S from edge of gutter. 145" E for storm drain grate.</p> <p>Notes:</p>
--	--	--



Subsurface Utility Report	
Client	Telamon Engineering
Project #	21-1097
City	San Francisco
Date	8/21/2023



Pothole # 5

Street: 701 Amador St

Cut Size: 1' x 1'		Location: 70" S from edge of gutter. 32' E from sewer manhole.
Asphalt: 2" Concrete: Depth: 32" Utility: AT&T Size: Duct Material: Concrete Soil: Clay, Rock		Notes: Went back into pothole on 8/24, we found that the DUCT was just concrete on top of the pipe.



Subsurface Utility Report	
Client	Telamon Engineering
Project #	21-1097
City	San Francisco
Date	8/21/2023



Pothole # 5 (2nd)

Street: 701 Amador St

<p>Cut Size: 1' x 1'</p>			<p>Location: 70" S from edge of gutter. 32' E from sewer manhole.</p>
<p>Asphalt: 2"</p> <p>Concrete:</p> <p>Depth: 39"</p> <p>Utility: Electric</p> <p>Size: 6"</p> <p>Material: PVC</p> <p>Soil: Clay, Rock</p>	<p>Notes: Went back into pothole on 8/24, we found that the DUCT was just concrete on top of the pipe.</p>		



~ Delivering Excellence with a Sense of Urgency ~™



Telamon Engineering Potholing Report

8/24/2023

EXARO Technologies Corporation

1831 Bayshore Highway

Burlingame, California

Mario Lopez

Office (650)777-4324

Cell: (408)221-5090

mle@exarotec.com

Date:	8/24/2023
Prepared For:	Telamon Engineering
Project #:	21-1097
Location:	San Francisco



PH #	Street	Cut Size	Asph	Conc.	Soil	Utility	Utility Size	Material	Depth	Location Reference / Notes
5	701 Amador St	1' x 2'	2"		Dirt, Rock	Telephone Electric	4"; 6"	PVC	42"	70" S from edge of gutter. 32' E from sewer manhole.
Foreman	Chris Dancel			Add'l Crew/Flagger			Standby Rep			
Technician	Candido Gomez			Add'l Crew/Flagger			Client Rep			
Timesheet	Date	Start/End	Hours	OT	Night Stay	Check	Check	Additional Equipment/Material used:		
Monday		/				Arrow Board <input type="checkbox"/>	Electronic Detector <input type="checkbox"/>			
Tuesday		/				Cold patch <input type="checkbox"/>	GPR <input type="checkbox"/>			
Wednesday		/				Class II <input checked="" type="checkbox"/>	Pk nails & shiners <input type="checkbox"/>			
Thursday	8/24/2023	/	4			Hotmix Aspht <input checked="" type="checkbox"/>	Vibra-plate <input checked="" type="checkbox"/>	Field Changes or Special Requests from Client Representative:		
Friday		/				CDF/slurry <input type="checkbox"/>	Flat bed <input checked="" type="checkbox"/>			
Saturday		/				Ready-mix conc <input type="checkbox"/>	Pick-up truck # <input type="checkbox"/>			
Sunday		/				Cutback <input type="checkbox"/>	Vac rig # 9 <input checked="" type="checkbox"/>	Client Representative Signature:		

Subsurface Utility Report	
Client	Telamon Engineering
Project #	21-1097
City	San Francisco
Date	8/24/2023



Pothole # 5

Street: 701 Amador St

<p>Cut Size: 1' x 2'</p>			<p>Location: 70" S from edge of gutter. 32' E from sewer manhole.</p>
<p>Asphalt: 2" Concrete: 0</p>	<p>Depth: 42" Utility: Telephone/Electric Size: 4"; 6" Material: PVC Soil: Dirt, Rock</p>		<p>Notes: There is no DUCT here, there are just 2 pipes.</p>





Telamon Engineering Potholing Report

8/29/2023
8/30/2023

EXARO Technologies Corporation

1831 Bayshore Highway

Burlingame, California

Mario Lopez

Office (650)777-4324

Cell: (408)221-5090

mle@exarotec.com

Date:	8/29/2023
Prepared For:	Telamon Engineering
Project #:	21-1097
Location:	San Francisco



PH #	Street	Cut Size	Asph	Conc.	Soil	Utility	Utility Size	Material	Depth	Location Reference / Notes
1	500 Amador St	3' x 3'		18"	Hard Dirt	NA	NA	NA	41"	Cleared 41". 31.4' W from gate. 41" S from wall.
Foreman	Juan Carlos			Add'l Crew/Flagger			Standby Rep			
Technician	Luis Mendez			Add'l Crew/Flagger			Client Rep			
Timesheet	Date	Start/End	Hours	OT	Night Stay	Check	Check	Additional Equipment/Material used:		
Monday		/				Arrow Board <input type="checkbox"/>	Electronic Detector <input type="checkbox"/>			
Tuesday	8/29/2023	/	8			Cold patch <input type="checkbox"/>	GPR <input type="checkbox"/>			
Wednesday		/				Class II <input type="checkbox"/>	Pk nails & shiners <input type="checkbox"/>			
Thursday		/				Hotmix Aspht <input type="checkbox"/>	Vibra-plate <input type="checkbox"/>	Field Changes or Special Requests from Client Representative:		
Friday		/			CDF/slurry <input type="checkbox"/>	Flat bed <input type="checkbox"/>				
Saturday		/				Ready-mix conc <input type="checkbox"/>	Pick-up truck # <input type="checkbox"/>			
Sunday		/				Cutback <input type="checkbox"/>	Vac rig # 7 <input checked="" type="checkbox"/>	Client Representative Signature:		

Subsurface Utility Report	
Client	Telamon Engineering
Project #	21-1097
City	San Francisco
Date	8/29/2023



Pothole # 1

Street: 500 Amador St

<p>Cut Size: 3' x 3'</p>			<p>Location: Cleared 41". 31.4' W from gate. 41" S from wall.</p>
<p>Asphalt: 0 Concrete: 18"</p>	<p>Depth: 41" Utility: NA Size: NA Material: NA Soil: Hard Dirt</p>		<p>Notes: Slurry found under footing, went down vertically 41" next to slurry.</p>



Date:	8/30/2023
Prepared For:	Telamon Engineering
Project #:	21-1097
Location:	San Francisco



PH #	Street	Cut Size	Asph	Conc.	Soil	Utility	Utility Size	Material	Depth	Location Reference / Notes
2	500 Amador St	2' x 2'	9"		Road Base, Rock				5'	Cleared 5'. Also dug under footing 12". 13.25' W from gate. 31" N from wall.



Foreman	Juan Carlos			Add'l Crew/Flagger			Standby Rep		
Technician	Luis Mendez			Add'l Crew/Flagger			Client Rep		
Timesheet	Date	Start/End	Hours	OT	Night Stay	Check	Check	Additional Equipment/Material used:	
Monday		/				Arrow Board <input type="checkbox"/>	Electronic Detector <input type="checkbox"/>		
Tuesday		/				Cold patch <input type="checkbox"/>	GPR <input type="checkbox"/>		
Wednesday	8/30/2023	/	8			Class II <input type="checkbox"/>	Pk nails & shiners <input type="checkbox"/>		
Thursday		/				Hotmix Aspht <input type="checkbox"/>	Vibra-plate <input type="checkbox"/>	Field Changes or Special Requests from Client Representative:	
Friday		/				CDF/slurry <input type="checkbox"/>	Flat bed <input type="checkbox"/>		
Saturday		/				Ready-mix conc <input checked="" type="checkbox"/>	Pick-up truck # <input type="checkbox"/>		
Sunday		/				Cutback <input type="checkbox"/>	Vac rig # 7 <input checked="" type="checkbox"/>	Client Representative Signature:	

Subsurface Utility Report	
Client	Telamon Engineering
Project #	21-1097
City	San Francisco
Date	8/30/2023



Pothole # 2

Street: 500 Amador St

<p>Cut Size: 2' x 2'</p> <p>Asphalt: 9"</p> <p>Concrete:</p> <p>Depth: 5'</p> <p>Utility: 0</p> <p>Size:</p> <p>Material:</p> <p>Soil: Road Base, Rock</p>		<p>Location: Cleared 5'. Also dug under footing 12". 13.25' W from gate. 31" N from wall.</p> <p>Notes: the concrete is 8" thick, dug 12" towards wall, and went down vertically 60". Did not find wall nor footing under.</p>
--	--	--



~ Delivering Excellence with a Sense of Urgency ~™