

Project Site Location

EXHIBIT 2

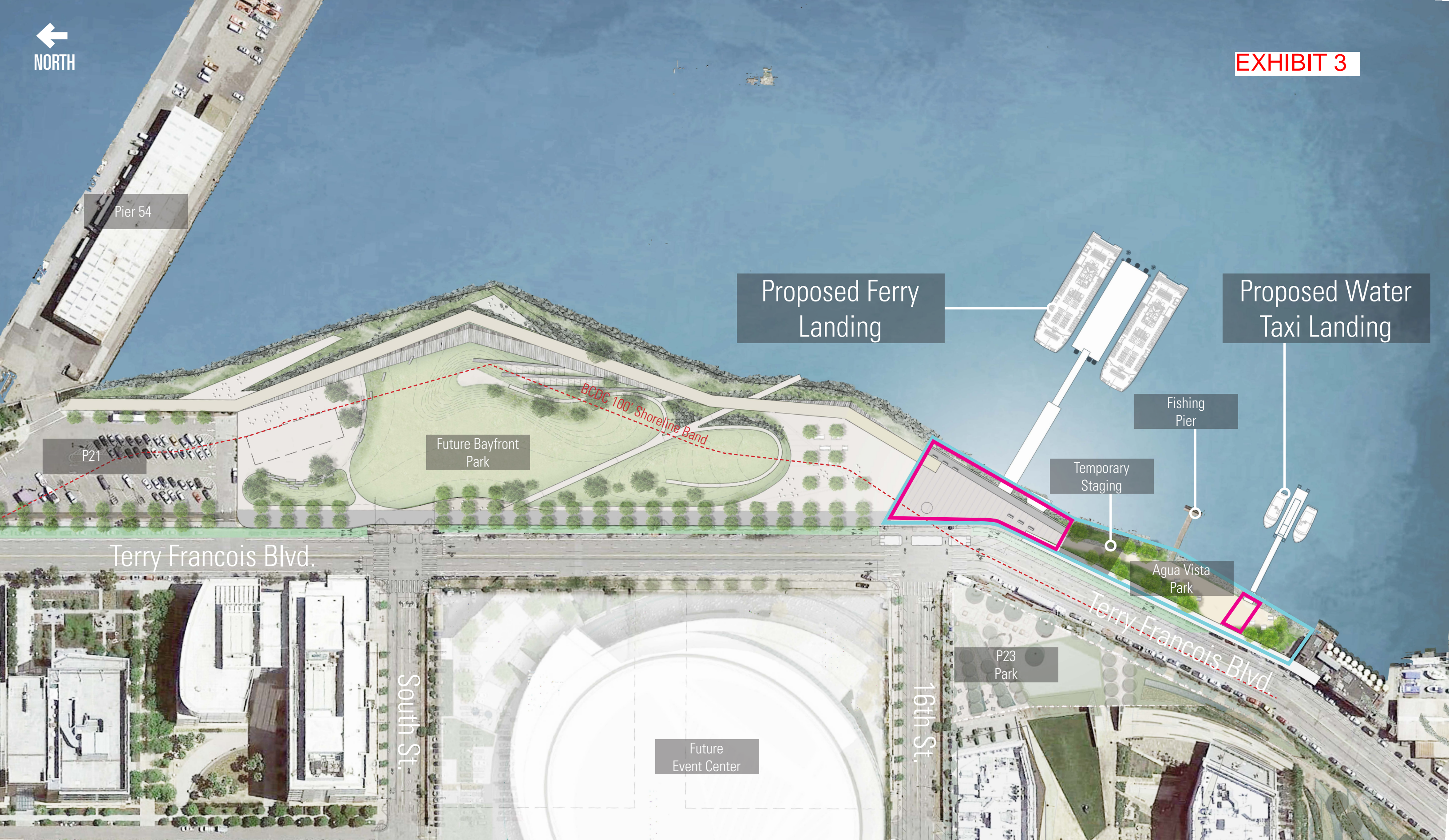

MISSION BAY FERRY & WATER TAXI LANDING



General Site Plan

 Agua Vista Park

 Landside Improvement Area



SURFACEDSIGN INC.
COWI



Area Development and Transportation

EXHIBIT 5



100% SUBMITTAL
OCTOBER 26, 2018

NO.	DATE	DESCRIPTION	BY	APP.
0	10/26/18	100% SUBMITTAL	VF	RB

TABLE OF REVISIONS
CHECK WITH TRACING TO SEE IF YOU HAVE LATEST REVISION

REFERENCE INFORMATION
& FILE NO. OF SURVEYS



DESIGNED: DATE: RB 10-26-18
DRAWN: DATE: VF 10-26-18
CHECKED: DATE: RB 10-26-18

APPROVED BY
SAN FRANCISCO PORT COMMISSION
DATE: _____
CHIEF HARBOR ENGINEER

SCALE:
AS SHOWN
SHEET OF SHEETS

MISSION BAY FERRY LANDING
AND WATER TAXI LANDING

PERSPECTIVE VIEW

CONTRACT NO. A085311
SHEET NO. A001
FILE NO.
REV. NO. D

EXHIBIT 6



100% SUBMITTAL
OCTOBER 26, 2018

NO.	DATE	DESCRIPTION	BY	APP.
0	10/26/18	100% SUBMITTAL	VF	RB

TABLE OF REVISIONS
CHECK WITH TRACING TO SEE IF YOU HAVE LATEST REVISION

REFERENCE INFORMATION
& FILE NO. OF SURVEYS



DESIGNED: DATE: RB 10-26-18
DRAWN: DATE: VF 10-26-18
CHECKED: DATE: RB 10-26-18

APPROVED BY
SAN FRANCISCO PORT COMMISSION
DATE: _____
CHIEF HARBOR ENGINEER

SCALE:
AS SHOWN
SHEET OF SHEETS



MISSION BAY FERRY LANDING
AND WATER TAXI LANDING

COVER PAGE

CONTRACT NO. A085311
SHEET NO. A000
FILE NO.
REV. NO. D

EXHIBIT 7

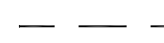
LEGEND

-  FORMER PIER 64 FOOTPRINT
-  PROPOSED LIMITS OF SAND CAP WITH UNIFORM MATTRESS (1.67 ACRES)
-  PROPOSED LIMITS OF PROJECT PERIMETER ARTICULATING BLOCK MAT (0.58 ACRES)

FERRY LANDING CAPPING AREA

CAP ELEVATION (MLLW):
 DESIGN CAP THICKNESS 3 FT
 DESIGN CAP DEPTH FROM -17 TO -20 FT

PROJECT CAP (UNIFORM MATTRESS, SAND CAP) LIMIT VOLUME: 7,200 CY
 PROJECT CAP 1-FT OVERDREDGE ALLOWANCE: 2,100 CY

CAP NOTES:

1. THESE NOTES ARE A SUMMARY OF THE CAP REQUIREMENTS - SEE SPECIFICATION SECTION 02 50 00 FOR A COMPLETE SET OF CAPPING REQUIREMENTS. SEE SPECIFICATION SECTION 35 20 23 DREDGING AND PERMITS FOR COMPLETE SET OF DREDGING REQUIREMENTS.
2. THE MAXIMUM PAYABLE DEPTH IS EL. -21 FEET MLLW AT THE FERRY LANDING CAPPING AREA AS SHOWN ON THE PROJECT PLANS.
3. NO PAYMENT SHALL BE MADE FOR CAPPING BEYOND THE PAYABLE DEPTHS, AND CONTRACTOR SHALL BE RESPONSIBLE FOR ANY FINES ASSESSED BY REGULATORY AGENCIES FOR CAPPING BEYOND THE LIMITS OF CAPPING (HORIZONTAL AND VERTICAL).
4. CONTRACTOR SHALL COMPLETE AND SUBMIT A CAPPING OPERATIONS PLAN PER PROJECT SPECIFICATIONS.
5. EXISTING WATER DEPTHS MAY VARY FROM SHOWN. CONTRACTOR TO PERFORM PRE-DREDGE MULTIBEAM BATHYMETRIC SURVEY TO CONFIRM WATER DEPTHS. STAMPED SURVEY DRAWINGS SHALL BE SUBMITTED TO PORT PRIOR TO DREDGING. NOTIFY ENGINEER PRIOR TO DREDGING IF ANY DIFFERENCES IN DEPTHS ARE FOUND.
6. SEE SHEET DR201 FOR CAP NOTES, SEE SHEETS DR202 FOR CAP WITH UNIFORM MATTRESS AND ARTICULATING BLOCK MAT PLAN. SEE SHEETS DR203 FOR CAP CROSS-SECTIONS AND DR204 FOR UNIFORM MATTRESS AND ARTICULATING BLOCK MAT DETAILS.
7. DO NOT PLACE CAP MATERIAL UNTIL FINAL POST-DREDGING SURVEY HAS BEEN APPROVED BY THE ENGINEER.
8. PLACE ALL CAP MATERIALS IN ACCORDANCE WITH THE SPECIFICATIONS.
9. DO NOT PLACE INDIVIDUAL LIFTS OF CAP MATERIAL IN THICKNESS' GREATER THAN THOSE DEFINED IN THE SPECIFICATIONS.
10. PLACE NO CAP MATERIAL OUTSIDE THE CAP LIMITS, UNLESS DIRECTED BY THE ENGINEER.

FERRY LANDING UNIFORM SECTION CAP BOUNDARY (TOE OF SLOPE)		
ID	NORTHING	EASTING
A	2107179.664	6016887.825
B	2107300.352	6017228.259
C	2107211.065	6017259.635
D	2107247.950	6017368.406
E	2107148.216	6017403.207
F	2107109.564	6017295.303
G	2107179.119	6017270.861
H	2107091.172	6017051.876
I	2107117.900	6016911.694

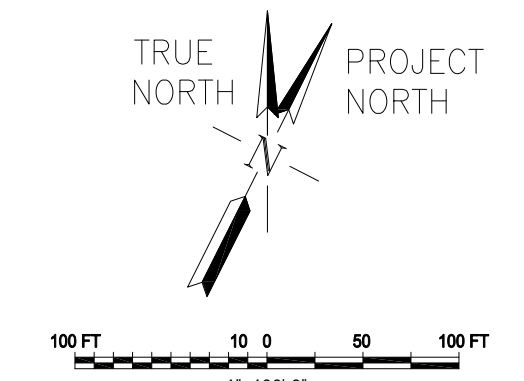
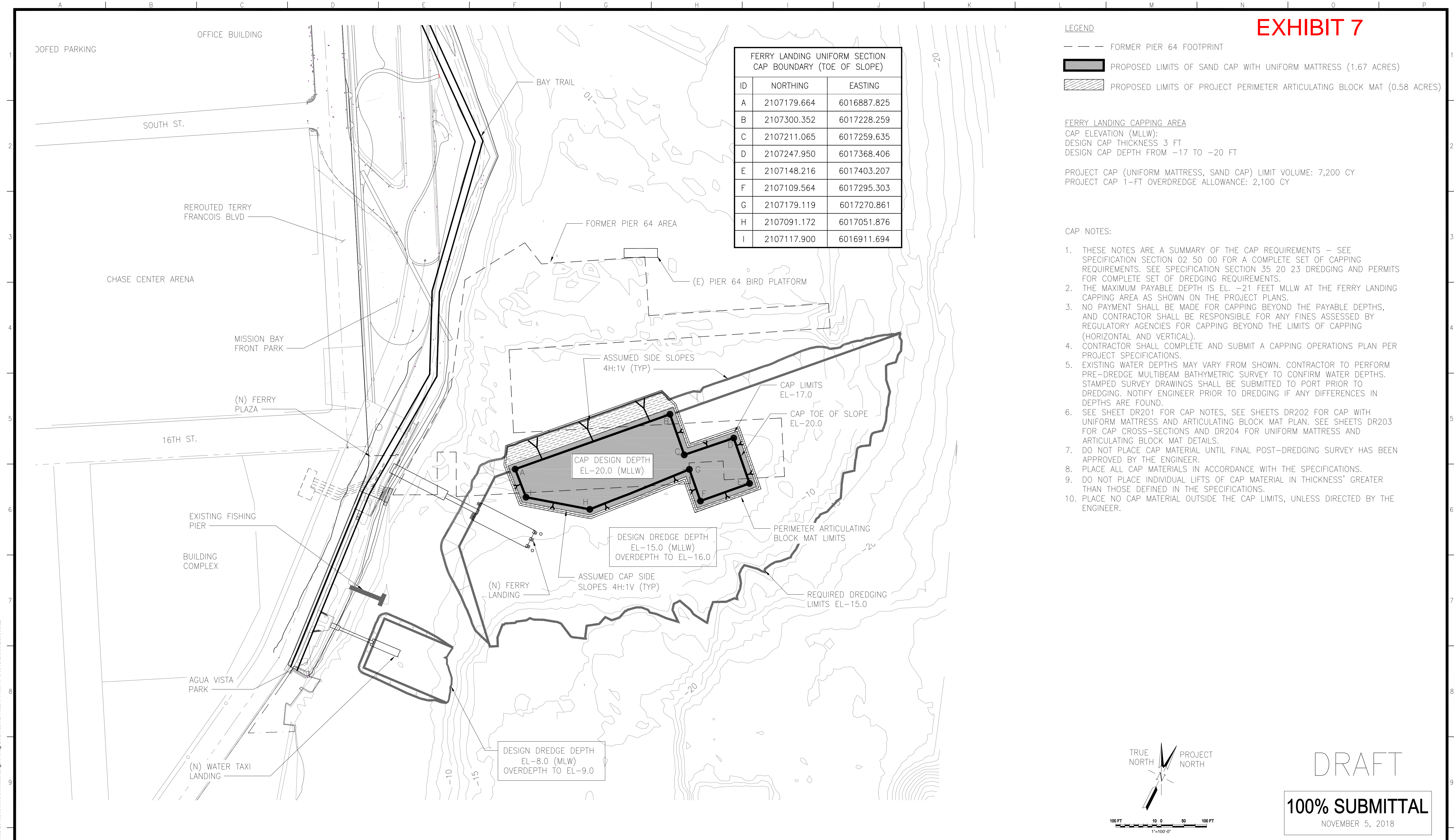

DRAFT

100% SUBMITTAL

NOVEMBER 5, 2018

FILE LOCATION: N:\GIS\PROJECTS\DR200\PRODUCTION\DRAWINGS\DR200_CAPPING_PLAN\DWGDATE: 11/20/18 4:18 PM DRAFTSPERSON: ERIC BUSHEE

NO.	DATE	DESCRIPTION	BY	APP.
0	10/26/18	100% SUBMITTAL	BLK	

TABLE OF REVISIONS
 CHECK WITH TRACING TO SEE IF YOU HAVE LATEST REVISION

REFERENCE INFORMATION & FILE NO. OF SURVEYS

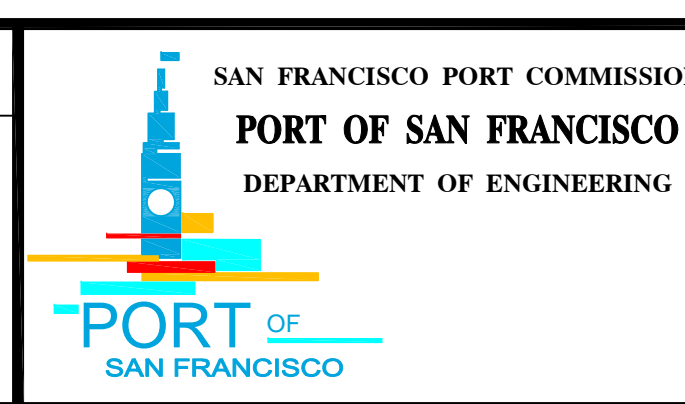

DESIGNED:	DATE:
CZ	11-5-18
DRAWN:	DATE:
EB	11-5-18
CHECKED:	DATE:
AH	11-5-18

APPROVED BY
 SAN FRANCISCO PORT COMMISSION

DATE: _____

 CHIEF HARBOR ENGINEER

SCALE:
 1"=100'-0"

SHEET OF SHEETS
 -

MISSION BAY FERRY LANDING
 AND WATER TAXI LANDING

FERRY LANDING CAP PLAN

CONTRACT NO.	A085311
SHEET NO.	DR200
FILE NO.	
REV. NO.	0