

THE SOUTHERN WATERFRONT SUBAREA

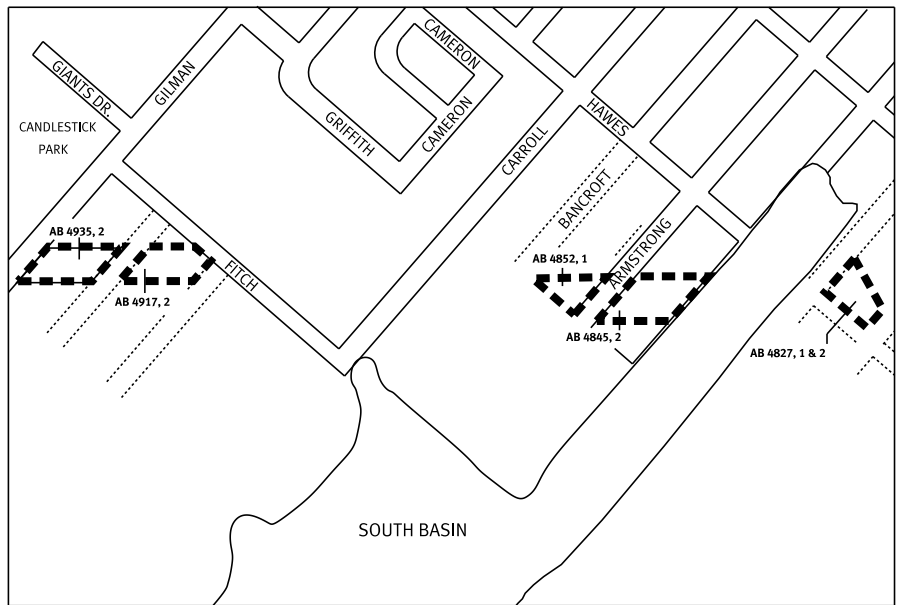

Note The parcels shown above are located just north of Candlestick Park. The Port also owns portions of existing or planned streets that are not depicted.

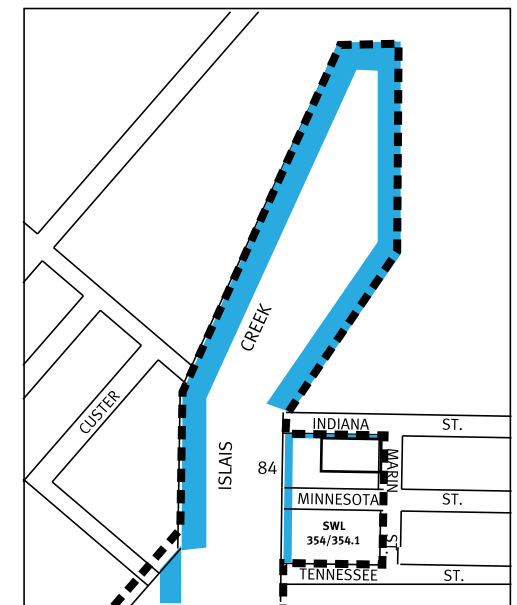

INSET

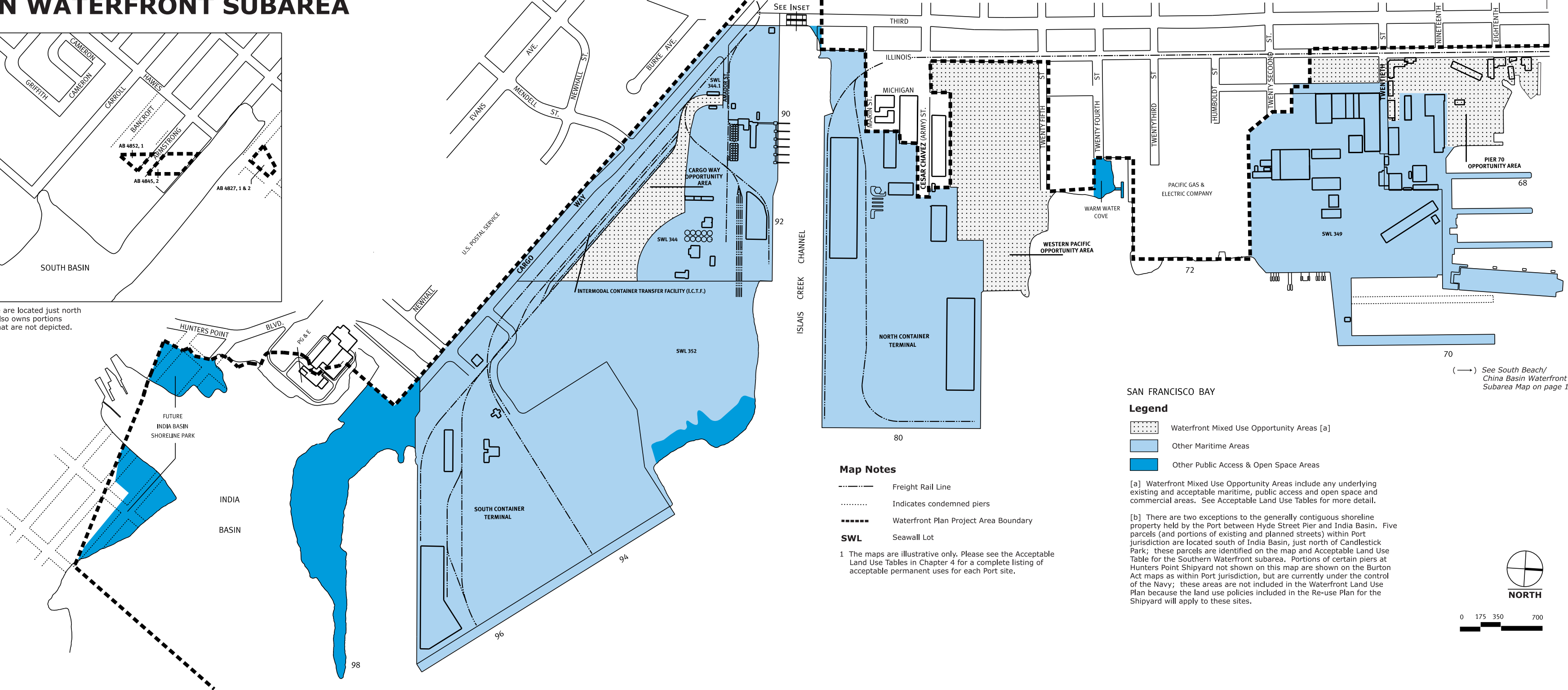

Map Notes

- Freight Rail Line
- Indicates condemned piers
- Waterfront Plan Project Area Boundary
- SWL** Seawall Lot

1 The maps are illustrative only. Please see the Acceptable Land Use Tables in Chapter 4 for a complete listing of acceptable permanent uses for each Port site.

SAN FRANCISCO BAY

Legend

- Waterfront Mixed Use Opportunity Areas [a]
- Other Maritime Areas
- Other Public Access & Open Space Areas

[a] Waterfront Mixed Use Opportunity Areas include any underlying existing and acceptable maritime, public access and open space and commercial areas. See Acceptable Land Use Tables for more detail.

[b] There are two exceptions to the generally contiguous shoreline property held by the Port between Hyde Street Pier and India Basin. Five parcels (and portions of existing and planned streets) within Port jurisdiction are located south of India Basin, just north of Candlestick Park; these parcels are identified on the map and Acceptable Land Use Table for the Southern Waterfront subarea. Portions of certain piers at Hunters Point Shipyard not shown on this map are shown on the Burton Act maps as within Port jurisdiction, but are currently under the control of the Navy; these areas are not included in the Waterfront Land Use Plan because the land use policies included in the Re-use Plan for the Shipyard will apply to these sites.

(→) See South Beach/China Basin Waterfront Subarea Map on page 141A



NORTH

